



THE SEWANEE MOUNTAIN MESSENGER

Volume XXXV No. 4

sewaneemessenger.com

Friday, Feb. 1, 2019



The Gailor House. Photo from the University Archives

Historic Homes of Sewanee Exhibit

by Bailey Basham, Messenger Staff Writer

In 1874, a little ways back from the corner of North Carolina and University Avenues, sat the Gailor House. The home had four rooms upstairs and four downstairs, and the four Gailor children grew up spending summers on the Mountain. The wide front porch was perfect for spending a summer afternoon in a rocking chair with a glass of iced tea, and its gabled roofs and shuttered windows look like they jumped off the page of a storybook.

"I read that Charlotte Gailor used to say that her parents, whenever the roof leaked, would add a room instead of having the old roof repaired," said Molly Elkins, a GIS Technician in the Landscape Analysis Lab. "True or not, the way Charlotte describes her family dynamic and the way that they lived

makes me laugh, and I think that's what makes it my favorite historic house in Sewanee."

Despite its beauty and history, in 1991, the Gailor House was demolished to make room for Chen Hall, the residence of the Vice Chancellor.

It is the aim of the Historic Homes exhibit to keep Sewanee's history in the forefront, according to Mary O'Neill, who is in charge of the exhibit.

"I work in archives and have tried to update and make a database of all the images of historic homes in Sewanee," she said. "I've been working on that for over a year, trying to document the year each home was built and who lived or lives there. I've been working with the Sewanee Trust for Historic

(Continued on page 6)

6th Annual Dancewise Coming to the Stage

by Bailey Basham, Messenger Staff Writer

Dancers from the Theatre and Dance Department will take the stage this weekend for the sixth annual iteration of Dancewise, a production led and choreographed by University students.

The dance will feature faculty, 19 University students and guest artist Jenny Showalter of New York's Treeline DanceWorks. Courtney World, assistant professor of dance, created Dancewise six years ago to give student dancers and choreographers the opportunity to work on a production that is similar to a professional contemporary dance concert.

"I come up with a theme for the production, and often, the theme is around something that I'm working on in my own work. I wanted to do something jazzy this year, and I was hoping to open the door to having more live music in the future. This year, Jenny Showalter came down from New York to create something with the students," she said.

The students will perform Showalter's "Flightless," which was inspired by feathers and light.

"It's abstract enough that everyone will discover something for themselves in it," World said.

World said the inspiration for the theme "Body and Soul" was

the classic dance song of the same name.

"I've always loved the jazz tune 'Body and Soul,' and that got me thinking, what is body and what is soul, and how do those two things relate and be so different for everyone? I tend to choose a theme that's quite open so the choreographers can find their own way into exploring something related," she said.

Student choreographer Robin Kate Davis said the first step to creating a dance is feeling the music.

"I'll hear a piece of music and start picturing how I want to dance to it. So much of it is about how the song makes me feel," she said. "My choreography is to a piece called 'Dreams,' and the subject of the scene is becoming aware that she can be a part of the dream as well. My inspiration was a soul connection rather than one to the body, and it's about making oneself aware of that curiosity it takes to become part of the dream."

Danielle Silfies, a senior theatre major, choreographed dances for the production of "Cabaret," which she will be working to restage for "Body and Soul."

Silfies said Sewanee has given her the tools she needs to create

(Continued on page 6)

Monteagle Grapples With Need for Road Repair

*by Leslie Lytle
Messenger Staff Writer*

Lobbying for much needed road repair on Laurel Lake Drive, more than 50 residents attended the Jan. 28 Monteagle City Council meeting.

Laurel Lake Drive residents complained about potholes causing damage to vehicles and no shoulder on much of the road where crumbling road edges significantly narrowed the driving surface. Also troubling, in places resurfaced segments of the road abruptly rejoin unresurfaced segments with as much as a two-foot difference in the width of the roadway.

Another particularly dangerous concern is an area where water stands in the road. "Drivers need to cross the center line at a blind curve to get past it," said Laurel Lake Drive resident Jessica Favalaro. "Someone is going to get killed."

Twice since late 2018, Laurel Lake Drive has been closed due to washout of the road surface at an area where a culvert becomes blocked with debris and the water cannot flow into Laurel Lake.

"Water is rushing through the big rocks and washing away the crusher run gravel there," acknowledged Monteagle Utility Manager John Condra.

Alderman Tony Gilliam suggested there should have been a bridge at that section of the road and proposed the section needed reengineering. "There's nothing we

(Continued on page 6)

School Board Resolution Opposes Vouchers

*by Leslie Lytle
Messenger Staff Writer*

At a Special Called meeting Jan. 25, the Franklin County School Board passed a resolution affirming opposition to "any legislation or other similar effort to create a voucher program in Tennessee that would divert money intended for public education to private entities." The pending state legislation would allow students to use public education funds to pay for private school tuition.

The Tennessee School Board Association reached out to local school boards asking them to "offer opposition" to the proposed legislation, said Director of Schools Stanley Bean. The resolution points out voucher programs go by different names and are variously referred to as "opportunity scholarships," "education savings," and "tax credits."

"Regardless of what you call it, it's taking money out of public education and giving it to parents of

(Continued on page 7)

Council Hears Strong Objection to Cell Tower

by Leslie Lytle, Messenger Staff Writer

More than 25 residents attended the Jan. 28 Sewanee Community Council meeting to voice opposition to the cellular tower slated for construction behind the football stadium. The tower would greatly improve community cell phone service from Verizon, Sprint and T-Mobile. Currently, only AT&T service is widely available.

Dale Richardson, who, with his wife Leslie Richardson hold the lease on the property closest to the tower site, summarized many of the group's grievances. Richardson pointed to possible health hazards from electromagnetic waves, noting many communities had band cellular towers. He also predicted a decrease in property values and argued the tower would disrupt the historical character of the location. "The football field is the oldest continually used football field in the South."

Another complaint voiced by many was lack of communication about the project.

"The biggest disappointment was that there was no communication from the University or the Community Council," said Peggy Peterson. Peterson and her husband hold the lease on the other property adjoining the site.

Peterson learned about the project from the Messenger report on the April 23 council meeting at which the proposed cellular tower and favored location were briefly mentioned. There was no discussion. Formation of the Parks Committee dominated the council's concerns that evening.

As potentially impacted adjoining leaseholders, the Petersons and Richardsons received notice in the fall from the Franklin County Board of Zoning Appeals about a proposed zoning change in their neighborhood necessary for a tower to be erected there. The Richardsons attended the zoning board meeting. The board rejected the University's rezoning appeal.

In December, the Franklin County Commission voted on a zoning rules amendment that paved the way for the project to go forward. The amendment allowed exceptions to the rule prohibiting towers when occupied structures were within the fall radius if "the proposed tower is needed for emergency communications."

Speaking for herself and Johnny Hughes, the other District 5 commissioner, Helen Stapleton said, "We were happy to approve the rule change. We had no idea there was any opposition. We thought we were doing the right thing. I apologize."

The Richardsons' home will be 140 feet away from the 189 foot tower.

The Petersons and Richardsons were unaware of the proposed zoning rules change and did not attend the county commission meeting. They read about an upcoming January zoning meeting in the Messenger, received notice of the meeting from the zoning board, and attended the Jan. 3 meeting to protest proposed rezoning in their neighborhood. The rezoning passed.

Numerous residents asked why no other sites were acceptable. Eric Hartman, head of University Risk Management, said other sites considered included the area of the Tennessee Williams Center for the Performing Arts, the baseball field, the baseball practice field, and the parking area at McCrady Hall. Hartman confirmed the contract with the wireless internet company Vogue Towers had been signed and the contract stipulated the location.

(Continued on page 6)



A Theta Pi pledge is welcomed on Shake Day. Photo by Lyn Hutchinson

P.O. Box 296
Sewanee, TN 37375

Letter

THE SHOULDERS WE STAND ON

To the Editor:

I read in the Messenger about the death of James William “Squealer” Sherrill. No mention was made of his important link to the founding of The University of the South. He was the great-grandson of Abraham Bowers, one of the original land donors to the Sewanee Domain. His mother was Mrs. Juan Bowers Sherrill, being the granddaughter of Abraham Bowers. She was an owner of the City Café, forerunner of The Blue Chair, and a true Sewanee lady. It is good to recognize the shoulders we stand on. God speed to you “Squealer” and all of your family.

*James Elywin Gipson, C’66,
Sewanee*

2019 Presidents’ Day Spelling and American History Bee

The Franklin County Democratic Women invite students, parents and adults to a night of food, fun, and friendly competition on President’s Day at 6 p.m., Monday, Feb. 18, at the Franklin County Annex. For just \$10/person (kids 12 and under eat free) you can enjoy an all-you-can-eat soup/salad/sandwich buffet. Your child can win a cash prize in one of two Spelling Bees. Adults can enter the American History Bee to win a gift certificate for dinner for four at an area restaurant. Spelling lists will be grade/age-appropriate (K-third, fourth-eighth). Register at the contest. For more information contact Sandy at (678) 613-5574.

Tree of Life Homecare, LLC

“Neighbors Helping Neighbors”

- * Licensed and insured home-based services for the elderly and disabled
- * CHOICES provider, Private Pay, Veterans Affairs, AAAD

931-592-8733
treeoflifehomecare.com

NOW ACCEPTING APPLICATIONS FOR CAREGIVERS

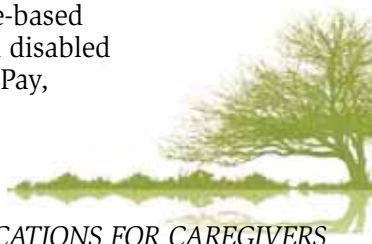

Upcoming Events at St. Mary's Sewanee

HITTING THE RESET BUTTON: DARING TO CHANGE

A four-week workshop on Sundays
1-8 pm, with dinner, starting Feb. 17

ONE-DAY CENTERING PRAYER WORKSHOP

Saturday, February 23

SPIRITUALITY OF THE ENNEAGRAM

Friday - Sunday, March 1 - 3

COMMON GROUND + COMMON GOOD

A Faith and Literature Retreat
led by The Rt. Rev. Dr. Henry Parsley
March 15 - 17

LECTIO DIVINA: A LENTEN RETREAT

Friday - Sunday, March 22 - 24

DREAM CARE: AN INTRODUCTORY WORKSHOP

Monday, March 25

AGING WITH COURAGE & GRACE

A Journey Toward Wholeness
in partnership with the Center for Courage
and Renewal : April 5 - 7,



For more information
or to register,
call 931-598-5342, email
<reservations@
stmaryssewanee.org>
or go online to

<www.stmaryssewanee.org>.

Monthly Health Care Services at Morton Memorial

On Saturday, Feb. 9, beginning at 8:30 a.m., St. Thomas Health will be providing medical services every second Saturday of the month in their Mobile Medical Van at Morton Memorial UMC in Monteagle.

St. Thomas’s medical outreach program is to provide medical services to those who do not have insurance or are underinsured. Their medical staff will provide routine physicals, well-child care exams, immunizations, and sick visits for chronic and acute illnesses. St. Thomas partners with RX Outreach to provide free prescriptions as needed and those prescriptions will be mailed to the patient’s home address. They are not able to provide prescriptions for pain medications.

At this time, St. Thomas has funding to cover copay’s, deductibles, etc. Insurance claims will be filed for those who have insurance. Co-pays will not be charged. All who fall within or near the poverty guidelines are eligible for services. No one will be turned away for not being able to pay.

St. Thomas is the leading faith-based health care system in Tennessee and is part of Ascension, the largest nonprofit health system in the U.S. and the world’s largest Catholic health system. Their mission is as follows: “We are committed to delivering compassionate, personalized care to all, with special attention to persons living in poverty and those most vulnerable.”

The ministry will coincide with Morton’s monthly food ministry distribution. Please note that anyone in the community is eligible for these medical services. It is not required that anyone be a Food Ministry recipient to receive these services. For more information, please contact Reverend Jodi McCullah at Morton Memorial UMC or Karen Noffsinger at (931) 636-8474.



— THE SEWANEE MOUNTAIN — MESSENGER

Published as a public service to the community since 1985, this newspaper is printed on Fridays, 46 times a year. Free of charge, copies are distributed to 100 locations, including businesses and post offices across the Plateau. This publication is made possible by the patronage of our advertisers and by contributions from the University of the South (print production) and the Sewanee Community Chest.

Kiki Beavers
editor/publisher
April Minkler
office manager
Ray Minkler
circulation manager
Sandra Gabrielle
proofreader
Leslie Lytle
staff writer

Bailey Basham
staff writer
Sarah Beavers
staff writer
Janet Graham
publisher emerita
Laura Willis
editor/publisher emerita
Geraldine Piccard
editor/publisher emerita

SUBSCRIPTIONS \$75 first class

418 St. Mary’s Lane, P.O. Box 296, Sewanee, TN 37375
Phone (931) 598-9949 | <news@sewaneemessenger.com>

All material in the Sewanee Mountain Messenger and on its websites are copyrighted and may not be published or redistributed without written permission.

University Job Opportunities

Exempt Positions: Assistant Athletic Trainer, Athletics; Assistant Volleyball Coach, Athletics; Coordinator, Education Program, Education; Coordinator, Sewanee Outing Program, Student Life; Director, Advancement Services, University Advancement; Director, Student Accessibility Services, Student Life Administration; Head Field Hockey Coach, Athletics.

Non-Exempt Positions: Administrative Assistant, Student Life; Assistant Manager, Sewanee Dining; Campus Security Officer (10 positions), Police Department; Catering Attendants (on call), Sewanee Catering; Classroom and Computer Lab Technician, Technology Access & Support; Food Service Worker (Temporary), Sewanee Dining; Childcare Provider, University Child Care Center; Groundskeeper, Facilities Management; Mentor Network Manager, Thriving in Ministry; Part-Time Police Officer, Police Department.

For more information call (931) 598-1381. Apply at <jobs.sewanee.edu>.

NEWS@SEWANEEMESSENGER.COM

New Employer Eyeing South Cumberland Plateau Area

New jobs may be coming to the South Cumberland Plateau. A company is proposing to locate a warehousing/distribution facility in Pelham, Tenn., and will create up to 400 new jobs. Right now, the company is hoping for applications and resumes from anyone interested. The jobs they are looking for include Order Processors and Lift Truck Equipment Operators and Material Handlers. These jobs start at \$11.25/hour not including benefits or shift differentials. Both positions require a high school diploma or GED equivalent. Order Processors need the ability to process orders in accurate, efficient & timely shipping process and to be cross-trained in other areas of the distribution center. Lift Truck Operators will be responsible for accurately storing, retrieving, loading and moving product in warehouse and relay loading/material moving information to appropriate personnel, as well as completing Lift Truck training. Please express your interest by forwarding resumes to P.O. Box 92, Altamont, TN 37301. Resumes and/or job applications can also be dropped off at the following locations during the hours specified: Gruetli Laager Community Center, 8 a.m.–6 p.m., Friday, Feb. 1; Tracy City Hall, 8 a.m. to 6 p.m., Thursday, Feb. 7.

Letters to the Editor Policy

Letters to the editor are welcome at the Sewanee Mountain Messenger and are a vital part of our community’s conversation. Letters need to be no longer than 250 words and may be edited for space and clarity. We make exceptions from time to time, but these are our general guidelines.

Letters and/or their author must have some relationship to our community. We do not accept letters on national topics from individuals who live outside our print circulation area. Please include your name, address and a daytime telephone number with your letter. You may mail it to us at Sewanee Mountain Messenger, P.O. Box 296, Sewanee, TN 37375, come by our office, 418 St. Mary’s Ln., or send your email to <news@sewaneemessenger.com>. —KB



SERVING WHERE CALLED

Please keep the following individuals, their families and all those who are serving our country in your thoughts and prayers:

Blaze Cassidy Barry
James Gregory Cowan
Nathaniel P. Gallagher
Steven Tyler Gipson
Peter Green
Zachary Green
Cheyenne N. Kelly
Gabriel Lloyd
Forrest McBee
Andrew Midgett
Jose D. Ramirez III
Troy (Nick) Sepulveda
Zachary Sherrill
Nick Worley

If you know of others in our Mountain family who are serving our country, please give their names to American Legion and Auxiliary member Louise Irwin, 598-5864.

MESSENGER CONTACTS

Phone: (931) 598-9949

News and Calendar

Tuesday, 5 p.m.
Kiki Beavers
news@sewaneemessenger.com

Sports

Tuesday, 5 p.m.
sports@sewaneemessenger.com

Display Advertising

Monday, 5 p.m.
ads@sewaneemessenger.com

Classified Advertising

Wednesday, noon
April Minkler
classifieds@sewaneemessenger.com

MESSENGER HOURS

Monday, Tuesday and
Wednesday
9 a.m.–4 p.m.

Thursday—Production Day
9 a.m. until pages are completed
(usually mid-afternoon)

Friday—Circulation Day
Closed

Upcoming Meetings

Franklin County Textbook Review

Copies of the Social Studies textbooks that are up for adoption will be available for public viewing in the Conference Room at the Board of Education, 215 South College St., Winchester, Monday, Feb. 4 through Friday, Feb. 15, from 8 a.m. to 4 p.m.

Coffee with the Coach

Coffee with the Coach, an opportunity to learn more about Sewanee's sports teams, continues at 9 a.m., Monday, Feb. 4, with Karine Gordy and Emily Cavender, equestrian coaches. Gather at the Blue Chair Tavern for free coffee and conversation.

Village Update Meeting

Meet with Special Assistant to the Vice-Chancellor, Frank Gladu, to discuss the Village development updates. Meet at 10–11 a.m., or 5:30–6:30 p.m., Tuesday, Feb. 5, at the Blue Chair Tavern. This month's meeting will be devoted to a discussion about these Quality of Life elements. Coffee will be served and everyone in the community is welcome.

EQB Meeting

Members of the EQB Club will gather at 11:30 a.m., Wednesday, Feb. 6, at St. Mary's Sewanee. Lunch will be served at noon.

Area Rotary Club Meetings

The Grundy County Rotary Club meets at 11:30 a.m., Tuesdays at Dutch Maid Bakery in Tracy City. The Monteagle-Sewanee Rotary Club will meet at 8 a.m., Thursday, Feb. 7, at the Sewanee Inn. Sheri Kling, Executive Director of the School of Theology's Beecken Center, will present the program.

Franklin County School Board

The Franklin County School Board is scheduled to meet at 6 p.m., Monday, Feb. 11, at the Franklin County Board of Education Building, 215 S. College St., Winchester.

Caregivers Groups

The Folks at Home's Caregivers Group meets weekly on Thursday, 1–2:30 p.m., in Otey Parish's St. Mark's Hall. There is no charge and new members are welcome. Contact Folks at Home at (931) 598-0303 or <folksathomesewanee@gmail.com>.

La Leche League

The February meeting of the La Leche League, which provides breastfeeding support and information for new mothers, will be at 10:30 a.m., Tuesday, Feb. 12, at the Sewanee Community Center, 39 Ball Park Rd. All pregnant women, mothers and babies are welcome. For more information call Pippa, (931) 463-2050.

Paths of Grace

Using Biblical stories, and our own, we will reflect on the ways God has surprised us in our lives. Join us as we explore how God writes straight with crooked lines. We will meet for four weeks in February: Thursdays from 10:30 a.m. to noon, beginning Feb. 7 in the Otey Parish Hall. Our time will be facilitated by Polly Robb, senior seminarian, and Cynthia Crysdale, seminary Professor. This program is sponsored jointly by Otey Memorial Parish and Folks at Home.

Folks in all ages and stages of life are welcome. Please register in advance by contacting <assistantfolksathome@gmail.com> or calling (931) 598-0303. Walk-ins are welcome.

Sewanee Emeritus

The Sewanee Emeritus group will meet on Thursday, Feb. 14. Meetings are held in the Torian Room of DuPont Library and begin at 3:30 p.m. The speaker will be Bran Potter, professor in the Earth and Environmental Services department. Potter, who has taught geology here for almost 40 years, will introduce to us the program "Finding Your Place," which has been offered over the past six years to incoming freshmen. Deborah McGrath of the biology department was the founding director, and the program has been a rousing success from both student and faculty perspectives.

Over a week before most students arrive, about 100 incoming freshmen, who choose to begin their academic experience here by learning about the "place" in which they will be living, learn about Sewanee through large group meetings, but mainly small interest groups of about 14, each with a faculty member as convener. These groups study and experience the local area's history and geography within a particular context, such as public health, art, literature, history, etc. One of the popular interest groups is "Walking in Place," and Potter leads that group, hiking on and off the campus. The classes continue to meet during first semester.

All are invited to the meeting to hear about this successful program, what places Potter's students hike to, and to enjoy refreshments.

SCC Open House

The Sewanee Children's Center will open its doors from 9–11:30 a.m., Saturday, Feb. 9, welcoming the community and interested families to tour the facilities and meet the leading members of this cooperative preschool and after-school program. The director, Sandy Glacet, the teachers, and many parents and enrolled children will be available to answer any questions about their experience at SCC, which provides developmentally appropriate teaching and learning for children ages 2 to 5 in the preschool program and for children in kindergarten through second grade in its after-school program. SCC is located at 216 University Ave., and is supported by Otey Parish and the Sewanee Community Chest.

Sewanee Woman's Club Meeting Feb. 11

The Sewanee Woman's Club will meet at noon, Monday, Feb. 11, at the Dubose Center in Monteagle.

The speaker will be Paula Sedita, who describes herself as an educator by training and a puppy raiser by choice. She is a Florida native who relocated to the Sewanee area 2 1/2 years ago. Paula is currently raising her fifth puppy for Southeastern Guide Dogs, which provides well trained dogs for veterans and the visually impaired at no cost to recipients.

Her program is titled "From Ball of Fur to Super Hero." Come meet her current pup. Learn what a puppy raiser does. Learn what a service dog is and is not, and learn proper service dog etiquette.

The deadline for reservations is Feb. 1. The cost of lunch is \$14. Please make reservations by responding to Glyn Ruppe Melnyk at <g.ruppemelnyk2015@gmail.com> or to Janet Miller Schmidt at (504) 858-5221. Childcare is available upon request in advance.

The menu for February's luncheon is cucumber and tomato salad, grilled chicken parmesan, lemon roasted potatoes, steamed broccoli, cheddar garlic biscuits, and chocolate mousse with fresh strawberries.

SCCF Grants Information Meetings

South Cumberland Community Fund invites potential applicants to a series of informational sessions for our 2019 spring grants cycle. All grant applicants must attend one of the information meetings before submitting a proposal. Please note that we will explain our three new funding focus areas at these sessions.

The sessions will be at the Grundy EMS office in Coalmont, across from the Coalmont Community Center. Meet at 6 p.m., Monday, Feb. 25; noon, Friday, March 1; or 10 a.m., Saturday, March 2.

The application deadline is April 3, 2019.

For more information, go to <southcumberlandcommunityfund.org> or email <grants@southcumberlandcommunityfund.org>.

We're glad you're reading the Messenger!



Mooney's
Market & Emporium

- ♦ ORGANIC, LOCAL FOODS
- ♦ SUPPLEMENTS & TOILETRIES
- ♦ GARDEN & BIRD SUPPLIES
- ♦ YARN & ACCESSORIES
- ♦ ANTIQUES, JEWELRY, GIFTS
- ♦ CRESCENT CAFE JUICE BAR

NOW OPEN EVERY DAY 11-3

Store open 10-6 daily
931-924-7400
1265 W Main • Monteagle

Lifelong Learning Meeting

On Thursday, Feb. 7, the Sewanee Seminars Academy for Lifelong Learning will welcome Brandy Tiernan. Her presentation is titled, "In an Aging State of Mind: Insights from Cognitive Science on living 'day by day.'"

Tiernan is assistant professor of psychology and chair of the neuroscience program at the University of the South. She earned a B.A. in psychology from the University of North Texas, an M.A. in experimental psychology from Western Kentucky University, and a Ph.D. in cognitive psychology from Iowa State University.

Please join us for what will certainly be a fascinating and illuminating discussion.

The seminar will be at noon in Lower Cravens Hall, 439 Kentucky Ave. Coffee, water and cookies are available and you are invited to bring your lunch.

The single session fee is \$3 and the annual fee is \$20.

The entrance to Lower Cravens Hall is located in the long glass wall that faces Kentucky Avenue and parking is available in the adjacent Tennessee Williams parking lot. Sewanee's traffic regulations require the vehicle's rear bumper to be visible from the parking lot aisles, so please don't back into a parking space or pull through.

For more information contact Sydney Shipp at (404) 668-8570.

SCA Meeting Feb. 7

The Sewanee Civic Association (SCA) will meet at 5:30 p.m., Thursday, Feb. 7, at St. Mark's Hall, Otey Parish. Social time with wine begins at 5:30 p.m., followed by dinner and a brief business meeting. The dinner and meeting are free and open to the public. Free children's activities will also be available. Please RSVP by Friday, Feb. 1, to <sewaneeccivic@gmail.com>.

John K. Coffey will present the program on "Surviving Fog: Finding Happiness in the Midst of Winter."

Coffey is an assistant professor of psychology at The University of the South. He is the second person to earn a Ph.D. in positive developmental psychology and is a past-president of IPPA's Student Division. Coffey earned a masters in social work at the University of Michigan. He applied what he learned to his work as a child and family therapist before pursuing his Ph.D. in positive developmental psychology at Claremont Graduate University. Presenting at international conferences and publishing in a wide range of journals, Coffey has been highly active in the fields of positive and developmental psychology. Coffey's research focuses on understanding and promoting well-being from infancy into adulthood. To do so, he merges theories from positive, developmental, and social psychology with a focus on emotions and relationships across the lifespan. His research often spans three or more decades. He has partnered with organizations to build online and in person interventions to promote well-being for adults and children.

Coffey will discuss the science of finding/achieving happiness in the depths of winter on the Cumberland Plateau. The information presented will be beneficial during all seasons of the year and throughout the whole lifespan.

Balance and Fall Prevention

Folks at Home and Emerald-Hodgson Hospital are sponsoring a lecture on Balance and Fall Prevention. Presented by Lisa Hartman, P.T., the lecture is part of the Folks at Home 2019 Campaign for Balance. It will cover the effects of aging on balance and what can be done to improve one's balance and prevent falls as one ages.

The lecture will be from 1:30–2:30 p.m., Tuesday, Feb. 5, at the Sewanee Senior Center.

HOUSE CALL SERVICE AVAILABLE
Full Service Veterinary Care for Dogs, Cats & Horses
Offering Acupuncture, Chiropractic & Herbal Therapies



Monday–Friday 7:30 am–6 pm; Saturday 8 am–noon
AFTER-HOURS EMERGENCY SERVICE AVAILABLE
Traci S. Helton, DVM 931-962-3411
505 S. Jefferson St., Winchester (41-A toward Winchester. First left after Domino's Pizza)



CRIME SEEN
Security Cameras
Burglar Alarms
Fire Alarms

MIKE ROARK
931-924-3216
800-764-7489

www.monsecurity.com
TN License 1912

ADAPTIVE LANDSCAPE LIGHTING

Paul Evans | 931.952.8289
adaptivelandscape-lighting.com

Church News

All Saints’ Chapel

Growing in Grace continues Sunday, Feb. 3, at 6:30 p.m. in All Saints’ Chapel. Mark Hopwood, assistant professor of Philosophy, will be sharing his reflections with us. This informal worship service is designed for students and community members, featuring student-led acoustic music, a different guest speaker each week, and Holy Communion. This semester, each of our speakers will meditate on the theme of Moving Mountains.

The Catechumenate will meet Wednesday, Feb. 6, at 6:30 p.m. in the Women’s Center. A catered meal will be provided. Based around fellowship, study, openness, and conversation, the Catechumenate serves as a foundational piece for the Christian faith, as well as a forum for discussion for people of all backgrounds. This week we will learn more about the history of the Catechumenate. All are welcome!

For more information, please contact Lay Chaplain Kayla Deep <kayla.deep@sewanee.edu>.

Taizé will take place in St. Luke’s Chapel at 7 p.m., Friday, Feb. 8. Taizé services are a form of group meditation that uses repeated, simple chant-like melodies, brief Scripture reading, silence, and prayer. The atmosphere is quiet and contemplative, using candlelight and icons as a devotional focus. The service will last about 45 minutes. Please email Caroline Carson, if

you have any questions. All are welcome.

Christ Church

On Feb. 3, the main focus of the service will be The Presentation of Christ in the Temple, transferred from Feb. 2 this year. On the 40th day after the birth of Jesus, he was taken to the Temple by Mary and Joseph to receive the customary blessing. This story, recounted by St. Luke, gave us the “Nunc Dimittis,” which is now known as The Song of Simeon. The Orthodox call the account “Hypapante” translated in English as “the meeting.” The feast came to be called “Candlemas” from the blessing of candles on this day. Americans call it “Groundhog Day,” though few know the origin is from legends about the “friendly beasts” waking up from their winter sleep just in time to see the Christ child.

CAC Pantry Sunday

Pantry Sunday for the Community Action Committee (CAC) is Sunday, Feb. 3, for participating churches: St. James, Otey, Cumberland Presbyterian and All Saints’ Chapel. Please bring your food offerings to Sunday services. The typical bag of groceries includes: rice, beans, pasta, macaroni and cheese, peanut butter, and cans of vegetables, fruit and soup. The cost for a complete bag is less than \$15.

Obituaries

Josephine Roberts

Josephine Roberts, age 91 of Sherwood, died on Jan. 28, 2019, at her home. She was born on May 12, 1927, in Orm, Tenn., to Clint and Emma Shirley Ake. She was a member of Sherwood Church of Christ. She was preceded in death by her parents; husband, Larry “Buddy” Roberts; four brothers; and four sisters.

She is survived by her son, Melvin (Betty) Roberts of Cowan; daughter, Brenda (George) Prince of Winchester; three grandchildren; five great-grandchildren; three great-great-grandchildren; and several nieces and nephews.

Visitation will be from 3–7 p.m. today, Feb. 1, at Sherwood Church of Christ. Funeral Services will be at noon on Saturday, Feb. 2, at Sherwood Church of Christ. Interment will follow in Mt. View Cemetery. For complete obituary go to <www.moorecortner.com>.

Roy Allen Rose

Roy Allen Rose, age 77 of Decherd, died on Jan. 26, 2019, at Southern Tennessee Regional Health Systems. He was born on Nov. 8, 1941, to Carson and Gladys Mae Rose, in the Alto Community. He served in the Tennessee National Guard. He worked for TDOT, drove school buses in Franklin County, and was a farmer. He was a 50-year member of Decherd Masonic Lodge and Decherd United Methodist Church. He was preceded in death by his parents; and brother, Ronnie Rose.

He is survived by his wife of 53 years, Linda Rose of Decherd; son, Carey (Kim McBee) Rose of Winchester; two grandchildren, and several other relatives.

Funeral services were on Jan. 29 from the chapel of Moore-Cortner Funeral Home. Interment followed in Franklin Memorial Gardens. For complete obituary go to <www.moorecortner.com>.

Elizabeth Frank Workman

Elizabeth Frank Workman, age 79 of Signal Mountain, Tenn., and a longtime Sewanee resident, died on Jan. 29, 2019, at Signal Mountain, Tenn. She was born on Aug. 17, 1940, in Elmhurst, Ill., and was a retired international management consultant and former Assistant Director of Education for Ministry at the School of Theology of Sewanee: The University of the South. She attended the University of Illinois and Delta State University, was a member of Alpha Gamma Delta sorority and earned her master’s degree in human resource development in 1985 from American University, Washington DC. Prior to her service as Assistant Director of EfM from 1998 to 2002, she served management clients on four continents, including World Wildlife Fund, United Nations Food and Agricultural Organization and the Dalai Lama and his Tibetan government-in-exile in Dharmasala, India, as well as and more than three dozen parishes and missions in 16 dioceses of the Episcopal Church USA. The details of her long and illustrious career are too many to list here. She was preceded in death by her daughter, Ann Workman Brewster.

She is survived by her husband of 57 years, Noel Workman of Signal Mountain; her son, Phillip (Denise) Workman of Helena Ala., and two grandchildren, Andrew (Avery) Workman of Helena Ala., and Alex (Sarah) Brewster of Sewanee.

A memorial service and eucharist will be held at 10 a.m. Saturday, Feb. 2, at Otey Memorial Church in Sewanee. In lieu of flowers, donations in her name may be sent to Smile Train, an international charity helping children with cleft lip and palate problems at Smile Train, 633 Third Avenue, 9th floor, New York, NY 10017.

The CAC is an outreach ministry of Otey Parish, with generous support from the Sewanee Community Chest and individuals across the Mountain. For more than 42 years, the CAC has provided food, financial assistance and educational support for persons in the greater Sewanee community. For more information contact the CAC at 598-5927.

Daughters of the King

Daughters of the King will meet at 5:30 p.m., Tuesday, Feb. 12, in the parish hall of St. James Episcopal Church in Midway. All women are invited to attend and learn more about the organization, the oldest Order for Lay Women in the Episcopal Church, established in 1855.

Otey Parish

This Sunday, Feb. 3, infants 6 weeks to children 4 years old are invited to the nursery beginning at 8:30 a.m. There will be nursery for both services and the Sunday School Hour. Children ages 3-11 are invited to join us in the Godly Play 2 room, next to the Adult Education room. Youth Ministry meets in Brooks Hall.

The Adult Forum is a Rector’s Forum on “Same Sex Marriage in the Episcopal Church and the Diocese of Tennessee” by Rev. Rob Lamborn. The Adult Forum meets from 9:45 to 10:45 a.m. in St. Mark’s Hall in the parish house at Otey Memorial Parish. Coffee and tea are provided. All are welcome.

Unitarian Universalist

The Unitarian Universalist Church of Tullahoma will host a free coffee house musical performance Saturday, Feb. 2, from 7 to 9 p.m. Folk guitarist Ken Sizemore, best known for opening for Peter, Paul, and Mary, will play folk classics from the 50s, 60s, and 70s.

The Unitarian Universalist Church of Tullahoma welcomes Ken Sizemore, who will present a musical program called “Songs of Hope for an Uncertain Time” on Sunday, Feb. 3. The service begins Sunday at 10 a.m., followed by refreshments and a discussion period. The church is located at 3536 New Manchester Hwy., Tullahoma. For more information, call (931) 455-8626, or visit the church’s website at <www.tullahomauu.org>.

Church Calendar

Weekday Services Feb. 1–8

- 7 a.m. Centering Prayer, Taylor’s Creek Greenway, Estill Springs, (W)
- 7:30 a.m. Morning Prayer, Otey
- 7:30 a.m. Morning Prayer, St. Mary’s Convent (not M)
- 8 a.m. Holy Eucharist, St. Mary’s Convent (not M)
- 8:30 a.m. Morning Prayer, St. Augustine’s
- 9 a.m. Communion, Good Shepherd, Decherd (M,W)
- 9 a.m. Mass, Good Shepherd, Decherd (T/Th/F)
- 11:30 a.m. Prayer/Healing, Morton Memorial (1st/3rd Th)
- Noon Contemplative Eucharist and Healing, Chapel, St. Mary’s Sewanee (T)
- 3:30 p.m. Centering Prayer, St. Mary’s Sewanee (T)
- 4 p.m. Centering Prayer, McRae Room, adjacent to Anna’s House, St. Mary’s Sewanee (W)
- 4:30 p.m. Evening Prayer, Otey (M–F)
- 4:30 p.m. Evening Prayer, St. Augustine’s
- 7 p.m. Centering Prayer, St. Paul’s, Otey (M)
- 7 p.m. Spanish Mass, Good Shepherd, Decherd (Th)
- 7 p.m. Taizé service, St. Luke’s Chapel (Feb. 8)

Saturday, Feb. 2

- 10 a.m. Sabbath School, Monteagle Seventh Day Adventist
- 11 a.m. Worship Service, Monteagle Seventh Day Adventist
- 5 p.m. Mass, Good Shepherd, Decherd

Sunday, Feb. 3 • CAC Pantry Sunday

All Saints’ Chapel

- 8 a.m. Holy Eucharist
- 11 a.m. Holy Eucharist
- 6:30 p.m. Growing in Grace

Bible Baptist Church, Monteagle

- 10 a.m. Worship Service
- 5:30 p.m. Evening Service

Chapman Chapel Church of the Nazarene, Pelham

- 9:30 a.m. Sunday School
- 10:45 a.m. Morning Worship
- 6 p.m. Evening Worship

Christ Church, Monteagle

- 10:30 a.m. Holy Eucharist

Christ Episcopal Church, Alto

- 9 a.m. Sunday School
- 10 a.m. Holy Eucharist

Christ Episcopal Church, Tracy City

- 10 a.m. Adult Bible Study
- 11 a.m. Holy Eucharist (child care provided)

Christ the King Anglican, Decherd

- 9 a.m. Sunday Service

Cowan Fellowship Church

- 10 a.m. Sunday School
- 11 a.m. Worship Service

Cumberland Presbyterian Church, Monteagle

- 9:30 a.m. Bible Study
- 11 a.m. Worship Service

Cumberland Presbyterian Church, Sewanee

- 9 a.m. Worship Service
- 10 a.m. Sunday School

Decherd United Methodist Church

- 9:45 a.m. Sunday School
- 10:50 a.m. Worship Service

Epiphany Mission Church, Sherwood

- 10 a.m. Holy Eucharist Rite II

Good Shepherd Catholic Church, Decherd

- 10 a.m. Mass
- 2 p.m. Spanish Mass

Grace Fellowship Church

- 10:30 a.m. Sunday School/Worship Service

Harrison Chapel Methodist Church

- 10 a.m. Sunday School
- 11 a.m. Worship Service
- 5 p.m. Worship Service

Midway Baptist Church

- 9:45 a.m. Sunday School
- 10:45 a.m. Morning Service
- 6 p.m. Evening Service

Midway Church of Christ

- 10 a.m. Bible Study
- 11 a.m. Morning Service
- 6 p.m. Evening Service

Monteagle First Baptist Church

- 10 a.m. Sunday School
- 11 a.m. Worship Service
- 6 p.m. Evening Worship

Morton Memorial United Methodist, Monteagle

- 9:45 a.m. Sunday School
- 11 a.m. Worship Service

New Beginnings Church, Monteagle

- 10:30 a.m. Worship Service

New Beginnings Church, Pelham

- 9:45 a.m. Worship Service

Otey Memorial Parish Church

- 8:50 a.m. Holy Eucharist
- 9:45 a.m. Adult Forum, Godly Play
- 11 a.m. Holy Eucharist

Pelham United Methodist Church

- 9:45 a.m. Sunday School
- 11 a.m. Worship Service

St. Agnes’ Episcopal Church, Cowan

- 11 a.m. Holy Eucharist

St. James Episcopal Church

- 9 a.m. Holy Eucharist Rite II

St. Margaret Mary Catholic Church, Alto

- 8 a.m. Mass

Sewanee Church of God

- 10 a.m. Sunday School
- 11 a.m. Morning Service
- 6 p.m. Evening Service

Sisters of St. Mary’s Convent

- 8 a.m. Holy Eucharist
- 5 p.m. Evensong

Tracy City First Baptist Church

- 9:45 a.m. Sunday School
- 10:45 a.m. Morning Worship
- 5:30 p.m. Youth Group

- 6 p.m. Evening Worship

Trinity Episcopal Church, Winchester

- 9:30 a.m. Christian Formation
- 10:30 a.m. Holy Eucharist Rite II

Valley Home Community Church, Pelham

- 10 a.m. Sunday School, Worship Service

Wednesday, Feb. 6

- 6 a.m. Morning Prayer, Cowan Fellowship
- 9 a.m. Communion, Good Shepherd, Decherd
- 10 a.m. Bible Study, Sewanee C.P. Church
- Noon Communion, Christ Church, Monteagle
- 5 p.m. KAs/Bible study/meal, Monteagle First Baptist
- 5:30 p.m. Evening Worship, Bible Baptist, Monteagle
- 5:45 p.m. Youth Bible study/meal, Monteagle First Baptist
- 6 p.m. Bible study, Monteagle First Baptist
- 6 p.m. Prayer and Bible study, Midway Baptist
- 6 p.m. Evening Prayer, Trinity, Winchester
- 6:30 p.m. Community Harvest Church, Coalmont
- 6:30 p.m. Prayer Service, Harrison Chpl, Midway
- 6:30 p.m. Youth group, Tracy City First Baptist
- 7 p.m. Adult Formation, Epiphany, Sherwood
- 7 p.m. Bible study, Chapman’s Chapel, Pelham
- 7 p.m. Evening Worship, Tracy First Baptist

Sewanee Realty

“Nothing you wear is more important than your smile.” Connie Stevens

SewaneeRealty@inSewanee.com
www.SewaneeRealty.com
115 University Ave., Sewanee, Tenn.

Margaret Donohue,
Principal Broker • 931.598.9200
Patsy Truslow,
Broker • 931.636.4111



MLS 1986674 - 246 Curlicue Rd.,
Sewanee. \$348,000



MLS 1975100 - 677 Breakfield Rd.,
Sewanee. \$479,000



MLS 1982786 - 212 Tennessee Ave.,
Sewanee. \$315,000



BLUFF - MLS 1974844 - 1613 Laurel Lake
Dr., Monteagle. 5.3 acres. \$445,000

LOTS & LAND

34 Westlake Ave., 6.5ac	2001645	\$65,000
20 Jackson Pt Rd.	1974540	\$37,500
126 Deep Woods 6.4 ac	1948499	\$34,900
127 Deep Woods 5.8 ac	1948503	\$34,900
13 Deerwood Dr. 2.98 ac	1946339	\$18,500
14 Deerwood Dr. 2.97 ac	1946347	\$18,500
16 Deerwood Dr. 2.98 ac	1946349	\$18,500
33 Westlake Ave. 5.3 ac	1800077	\$60,000
57 Edgewater Ct. Win.	1906419	\$32,000
St. Mary's Ln. 10 ac	1820182	\$85,000
Montvue Dr. 5 ac	1714856	\$54,900
Pine Dr. 16.1 ac	1894605	\$149,000
Pine Dr. 3.22 ac	1894027	\$38,000
362 Haynes Rd. 10 ac	1910953	\$84,000
Hwy 41, Jasper 10 ac.	1906899	\$125,000

BLUFF TRACTS

16 Laurel Lake Dr.	1989467	\$97,500
14 Jackson Pt. Rd 18.6 ac	1803643	\$129,500
3 Horseshoe Ln. 5.6 ac	1608010	\$60,000
38 Long View Ln. 2.56 ac	1954806	\$99,000
1 Jackson Pt. Rd. 12.45 ac	1911600	\$125,600
11 Jackson Pt. Rd. 19+ ac	1911497	\$120,000
7 Saddletree Ln.	1954791	\$75,000
15 Saddletree Ln. 6.12 ac	1978549	\$75,000
Partin Farm Rd. 6.5 ac	1902508	\$64,500
9 Saddletree Ln. 2.01 ac	1948632	\$66,000
37 Jackson Pt. Rd. 3.97 ac.	1965687	\$85,000
12 Saddletree Ln. 2.15 ac	1960834	\$79,500



MLS 1983502 - 174 Carpenter Cir.,
Sewanee. \$525,000



BLUFF - MLS 1886899 - 569 Haynes
Rd., Sewanee. 5.1 acres. \$499,900



LAKEFRONT - MLS 1949994 - 681
Magnolia Dr., Winchester. \$779,500



MLS 1975436 - 57 Diamond Dr.,
Winchester. \$235,000



MLS 2002714 - 191 S. Carolina Ave.,
Sewanee. \$439,000



BLUFF - MLS 1994448 - 294 Jackson
Point Rd., Sewanee. 20.9 acres. \$299,500



BLUFF - MLS 1930811 - 146 Jackson
Point Rd., Sewanee. 13+acres. \$299,500



MLS 1956405 - 171 Maple St.,
Sewanee. \$274,500



BLUFF - MLS 1964395 - 211 Rising Sun Ln., Sewanee. 5.26 acres. \$295,000

CAMPUS RENTAL - 2 bd, 2
ba, \$1,400 monthly - call 931-
598-9200



BLUFF - MLS 1878711 - 226 Rattlesnake
Springs Ln., Sewanee. \$749,000



BLUFF - MLS 1945408 - 506 Ingman Cliff
Rd., 3.05 acres. \$688,000



MLS 1995053 - 114 Maxon Ln., Sewanee.
\$449,900



MLS 1901778 - 52 Sherwood Trail,
Sewanee. \$348,000



MLS 1994452 - 24 Overton Ave.,
Monteagle. \$219,000



BLUFF - MLS 1923054 - 1833 Laurel
Lake Dr., Monteagle. \$439,000

Tower (from page 1)

Verizon, the primary provider who will offer service at the new tower, selected the football field location as “the site that does the most good and the site we’re most interested in,” Hartman insisted.

Vogue Towers CEO Pat Tant explained Verizon’s choice was based on minimizing “the difficulty in penetrating stone buildings” and identifying a central location to maximize “propagation.”

“We need to hear from Verizon. They need to tell us why this is the perfect site,” argued Leslie Richardson.

Speaking in favor of the tower, University student Adam Foster said, “Just last night I got an email about a suspicious person on campus near Spencer Hall.” Foster expressed special concern for female students walking back to their dorm in areas where there was no cell service. “There is no service right here,” Foster stressed.

In addition to cell phone service providers, Franklin County Emergency Management will also use the tower to facilitate much needed improvement to communication in the Alto Road area, Hartman said.

Addressing the health hazard issue, Vice-Chancellor John McCardell noted that the cellular antennae “we have now in Shapard Tower emits these waves. Students living in the area and everyone who walks past is exposed. There are levels of risk one is willing to incur in every decision one makes in life.”

Citing the largely agreed upon need and benefit to the community, council representative Charles Whitmer observed, “If it’s not in your backyard it’s in someone else’s.”

Acknowledging the poor communication about the project, McCardell said, “There are things we might have done better. I’m grateful for the sincerity and passion of the residents who attended tonight’s meeting. These are our friends, neighbors and valued members of the community, and we should thank them.”

Monteagle (from page 1)

can do right now with the type of weather we’re having.

Mayor David Sampley promised Laurel Lake Drive residents when the new budget allocation for paving was drawn up in June, “We’ll put you ahead of everybody else. The other worst case scenarios have been taken care of.”

Marion County does road repair for Monteagle with the town paying for materials. Sampley said he would contact the Marion County road superintendent and get an estimate on the cost.

In regular business, the council elected Gilliam vice mayor. The city charter states the council should elect a vice mayor from among the alderpersons. The council had been operating under the convention of the previous mayoral administration, appointing as vice mayor the alderperson who received the most votes in the election held the year the mayor was elected. Jessica Blalock acted as vice mayor since November of 2016.

The council also voted to amend the Beer Permit ordinance to bring it in line with state law. Two years ago the state amended the law applying to beer sales at markets and grocery stores allowing 8 percent alcohol by weight and 10.1 percent alcohol by volume. Monteagle’s unrevised ordinance capped the by volume alcohol limit at 5 percent

by weight.

The Pilot Travel Center contacted city recorder Debbie Taylor about the discrepancy. “Pilot wanted to be legal, so they were pulling the higher alcohol content beer off the shelves,” she said.

In another state law related issue, the council voted to opt out of paying for city employees’ health insurance after retirement. The cost would have far exceeded the town’s limited resources from occupancy tax, gasoline tax and sales tax. Monteagle does not levy an income tax.

Addressing excavation costs incurred by the Clifftops gated community to investigate the cause of surface water bubbling up onto the road, the council concurred with Condra’s recommendation to reimburse Clifftops for the \$4,797 expense.

“I think it’s only right,” Condra said. The water source turned out to be a leaking, no longer used city water system valve. The Monteagle water department removed the valve and repaired the line.

The council allocated \$1,050 to pay for a DJ at the monthly Cruise-In events held from April through September.

The council will begin meeting for monthly workshops, time and date to be announced. The next regular council meeting is Feb. 25.

Historic Houses (from page 1)

Preservation, and they’ve been quite involved with this.”

The Historic Homes exhibit is scheduled for Feb. 4 and will run until the end of July. An opening reception and talk on Thursday, Feb. 7, at 5:30 p.m. will feature Elkins, who organized a driving tour of the historic homes, along with homeowners Bran and Cindy Potter, Virginia Craighill and Nancy Cortner. Posters are for sale, and an opportunity to order a historical plaque for homes on the Domain will be available at the opening.

The Historic Homes tour includes one main route through central campus, and two much shorter alternative routes. Presentations on Feb. 7 will feature an interactive map of houses that are still standing, and those razed or burned, along with links to Omeka, a database which showcases more images and text about each house.

O’Neill said there are upwards of 75 homes in Sewanee with some historical significance. She hopes the work on the exhibit will provide to the community a look at what life may have been like in previous Sewanees.

“Each historic home has a rich and unique history, and once burned down or razed, these stories often become forgotten,” Elkins said. “And these homes are more than just about architecture—each home was a representation of the person or family that lived there. I think the best part about this exhibit is that you get to see what was important in the lives of the previous owners of the house, what they valued, what brought them to the Mountain and what might have ultimately made them leave.”



The Mayhew house. Photo from the University Archives

Sewanee Inn Welcomes New Executive Chef

The Sewanee Inn welcomes new Executive Chef Wilbur G. Cox Jr. Cox comes to Sewanee from Baltimore, Md., where he was most recently the Executive Chef at the Hotel Revival. His extensive experience includes Hotel Monaco, The Elkridge Club, and corporate trainer for The Kimpton Group. He has had the privilege to work under or with some of the finest chefs in the country, including E. Michael Reidt (Food and Wine Best New Chef 2001), Guerillmo Tellez-Cruz (formerly of Charlie Trotter’s 2 Star Michelin), Patricia Yeo (Food and Wine Best New Chef 2001), Andrew Carmellini, and Thomas Dunklin (Emeril Group). Cox’s many awards include the American Institute of Food and Wine’s “Farm to Chef” best vegetarian, “Maritime Magic” best savory, first place at the 20th Annual Chocolate Affair, and first place three years in a row at their annual Farmer and the Chef competition. He has also been featured in Flavor & the Menu, Baltimore Style, and Sip & Savor magazines.

“Food, cooking, and service have always been true passions of mine,” said Cox. “As a child, my family would spend the summers working on my grandmother’s family farm in rural North Carolina. I had the rare opportunity to see the entire process of seed to fork since the age of five, and it is upon that foundation that I find myself where I am as a chef today. I began my culinary career as a pot washer in my family’s restaurant at 13 years of age, and never looked back.”

ADS@SEWANEEMESSENGER.COM

CATERING
TAKE-OUT

ONLINE
ORDERING

VOTED
**BEST
BURGER**

CAFE HOURS - WINTER: **TAVERN HOURS**
8:00a-4:00p Mon-Fri • 4:00p till...
Everyday Sat-Sun • 11:00a till...

(931) 598-5434
thebluechair.com

Dancewise (from page 1)

her own choreography as well as design costumes to accompany the dances.

Silfies is working with the Professor Jennifer Matthews’ costume design class to outfit all the dancers.

“A lot of my inspiration comes from being a dancer—it makes it easier to talk to other dancers about what they want for their costumes. They’ll give me a general idea of what they’re envisioning, and from there, you can take that idea and find historical pictures to create the pieces.”

New to Dancewise this year is student lighting designer, Krystal Fowler.

“Typically, we have faculty or an intern do lighting, but Krystal is doing the design for ‘Body and Soul’ as her senior project. She is meeting with every choreographer individually to plan for the show.”

“DanceWise: Body and Soul” will run at the Tennessee Williams Center’s Proctor Hill Theatre at 7:30 p.m., Friday, Feb. 1; at 2 p.m. and 7:30 p.m., Saturday, Feb. 2; and at 2 p.m., Sunday, Feb. 3.

Admission is free, but seating is limited. Ticket reservations are at <Eventbrite.com>.

Community Council Honors Knoll

*by Leslie Lytle
Messenger Staff Writer*

Although discussion about the cellular tower dominated discussion at the Jan. 28 Sewanee Community Council meeting, the council also took up several other issues. Following the suggestion of resident Mary Priestley, the council voted to make the roadside cleanup project an annual event and to name the event after Arthur Knoll.

Knoll, a former county commissioner and University professor, actively promoted and supported the cleanup project for many years, Priestley said. Council representative Phil White will chair the cleanup initiative. Priestley coordinated the project last year and will do so again this year. The proposed date is April 20.

Vice-Chancellor John McCardell welcomed newly elected council representatives Anna Palmer, District 1, and Eric Keen, District 3. Palmer serves as the admission counselor at St. Andrew’s-Sewanee School. Keen is a visiting instructor of biology at the University.

Provost Nancy Berner announced a vacancy on the agenda committee. The committee reviews potential agenda items submitted for the council’s consideration to determine if the topic is one the council should address or if the subject should be referred to another entity, Franklin County or the University Lease Committee, for example. Berner asked council representatives interested in assisting with the agenda review process to contact her. Agenda items referred to other entities are announced at council meetings to keep the council informed of community concerns.

Council representative Cindy Potter announced the Community Action Committee will pay for the fees and equipment for any child who wishes to participate in youth sports and lacks the resources. For information or to recommend a child for assistance, contact Potter <cynthiadepotter@gmail.com> or the CAC (931) 598-5927. The council meets next March 25.

QUIET
tuesdays

Come spend Tuesdays at St. Mary’s Sewanee for a day of quiet reflection each week.
Bring lunch if you’d like to enjoy the campus between events.

7 am Qi Gong on the Bluff
Noon Contemplative Eucharist & Healing
3:30 pm Centering Prayer
5 pm Yoga (\$8/session) *note new time

Rest Renew Reconnect
AT ST. MARY’S SEWANEE:
THE AYRES CENTER FOR
SPIRITUAL DEVELOPMENT

WOODY’S BICYCLES
SALES, SERVICE AND RENTALS
A Full-Service Trek Bicycle Dealer

Mon-Fri 9-5 • Sat 10-2 • 90 Reed’s Lane
598-9793 • woodybike@gmail.com

Check out www.woodysbicycles.com for rates, trail maps, photos, bike club links, races and much more!



VILLAGE REPORT

by Frank X. Gladu

The priority projects in the Village continue to move forward. The road project has completed the right of way phase and is now being reviewed by the Tennessee Department of Transportation engineers. The project is expected to begin construction planning this spring. There has been some reevaluation of the mixed-use specialty food market and apartment building to consider a two-story building instead of three. It is an interesting adjustment to the plan and we are taking a look at it for the benefits and drawbacks. The Bookstore is nearing the completion of a re-design and hopes are to break ground this spring with an opening in the Spring of 2020. The other significant activity has been with the housing project. A request for proposals for building homes in Sewanee was sent out in November. The target market for these homes is to be within the financial reach of faculty and staff of the University. The objective is to create some affordable single family homes as well as some town homes and duplexes. Several proposals have been submitted and we are in the process of evaluating them. I am hoping to identify some possibilities within a month or two so that we can begin building places to live in Sewanee. In addition to these projects, we are finishing up a storm water study and the recommendations of that study are expected in March. Also, a conceptual parking plan study is expected soon.

We are also exploring the creation of guidelines for what we are calling Quality of Life. These voluntary Quality of Life guidelines would be intended to complement and enhance the architectural and building standards already in place as outlined in the Sewanee Village Pattern Book (See www.sewanee.edu/Village). The intent of these guidelines would be to create, protect and preserve our natural environment and to address the look and feel of the place. It would include items such as tree preservation, view sheds, trails, access to the woods, storm water practices at the leaseholder level, light pollution and establishing dark sky principles. It would also be intended to address landscaping principles that provide for open spaces, selected plant types for both trees and shrubs as well as lawn maintenance, flower beds and sidewalks. We need to plan for an attractive street with appropriate signage, storefront windows, seasonal décor, bike racks, outdoor furniture with resting and gathering spaces. In addition, we would like to capture the principles established in the University's Sustainability Master Plan of 2013. All of these things and more need to be identified and established to guide not only the development as we begin to build new buildings, but to assist existing building and business owners to achieve an attractive and charming downtown.

This month's meeting will be devoted to a discussion about these Quality of Life elements. We hope to identify what should be included in a set of guidelines. Two meeting times will be offered on Tuesday, Feb. 5, one at 10 a.m. and the other at 5:30 p.m. Both sessions will be held at the Blue Chair on University Avenue. Hope that you will be able to attend. But if you can't, please share your ideas on this topic with me and I would be glad to include them in our effort to enhance the livability of Sewanee.

Frank X. Gladu is a Special Assistant to the Vice-Chancellor and project Manager for the Sewanee Village Development. He can be reached at fxgladu@sewanee.edu or (931) 598-3397. More information can be obtained at www.sewanee.edu/village.

School Board (from page 1)

students to do whatever they want to with it," Bean said.

The resolution stressed, that "the State of Tennessee has established nationally recognized standards and measures for accountability in public education ... Vouchers eliminate accountability, by channeling taxes to private schools without the same academic or testing requirements, public budgets or reports on student achievement, open meetings and records, and public accountability requirements in major federal laws, including special education laws."

The resolution also noted, "vouchers have not been proven effective at improving student achievement or closing the achievement gap."

"Who will benefit from a voucher system?" asked school board representative Sara Liechty. "It won't be the children from poverty and inner city schools. It will be the upper middle class, wealthier children who would have been in private school anyway. The extra the parents get will take the family to the Bahamas for a vacation."

"It would just be a supplement," concurred Board Chair Cleijo Walker, emphasizing the amount parents received would not be nearly enough to pay for private school tuition. "Parents of kids in urban schools that aren't perform-



"The county appreciates the school board more than ever. I've been hearing lots of positive comments about the middle schools," said Director of Schools Stanley Bean in observance of School Board Appreciation Week. Left to right, school board members Gary Hanger, Linda Jones, Christine Hopkins, Sara Liechty, Cleijo Walker, and Bean. Not pictured, Chris Guess, Lance Williams, Adam Tucker.

ing will be the ones who are for this, but it's not going to help them."

Illustrating the impact on the public schools from loss of funding Bean said, "The buses would still need to travel the same routes regardless of how many kids they were picking up. And we'd still need the same number of teachers. If there were 23 rather than 25

students in a class, we'd be losing the money for those two students, but we'd still have to pay for the teacher."

"Christian schools, private schools, home schooling—that's a lawful right," Liechty said. "But don't ask the tax payers to pay for it."



91 University Ave. Sewanee
sewaneehouses.com | (931) 598-9244

UNIVERSITY REALTY
SEWANEE TENNESSEE

Lynn Stubblefield
(423) 838-8201
Susan Holmes C'76
(423) 280-1480
Freddy Saussy, C'99
(931) 636-9582



30.50 ACRES Bluff views, waterfall, creek, rocky face, giant hemlocks. 30.50 acres \$200,000



MLS#1992853. Beautifully re-decorated. Pale gray with white trim. New laminate in bathrooms, new carpet in bedrooms, fresh and squeaky clean! Great small subdivision close to Cowan Elementary, South Middle and Franklin County High School. \$112,000.



219 LIGHTNING BUG LANE. Fantastic new construction. 3 BR, 2 BA. Minutes from campus, beautiful wooded lot. \$219,000



MYERS POINT. 480-acre gated community w/ 24 exquisite bluff or lake home sites overlooking Lost & Champion Coves. Exceptional amenities. Call Lynn Stubblefield 423-838-8201 for a private tour. Prices begin at \$275,000



175 PICTURESQUE ACRE FARM In Monteagle running from Exit 134 to Christ Church. \$670,000



101 CARRUTHERS RD. Extraordinary sunset view on the Domain. 2820 sq. ft. w/unfinished basement. Two fireplaces and views from every room. \$600,000



414 TATE RD. Charming new country home on 2.44 beautiful acres w/detached garage. Priced to sell. \$170,000



SUNSET BLUFF VIEW. 15 acres, private and close to town, priced at \$125,000

CAN-TEX RD. 10.56 beautifully wooded acres joining the University. All utilities at the road, gently rolling, easy to build on.



20+ PICTURESQUE ACRES. Near Savage Gulf, open pasture, barn and pond. Simply stunning!



807 TIMBERWOOD TRACE. Stunning custom home, gated community, gourmet kit, 5 BR 3 BA, 5.54 ac. Loaded with extras. \$399,000



1728 RIDGE CLIFF DR. Custom log home with a wonderful view. Great rm, large screened in porches. Priced to sell. \$219,500

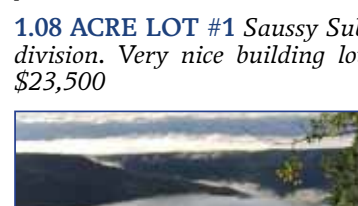

1.08 ACRE LOT #1 Saussy Subdivision. Very nice building lot. \$23,500

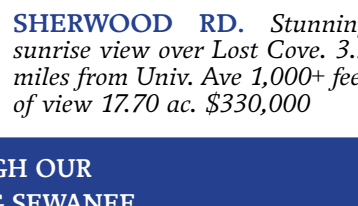

SHERWOOD RD. Stunning sunrise view over Lost Cove. 3.3 miles from Univ. Ave 1,000+ feet of view 17.70 ac. \$330,000

Sweeton
Home Restoration
LICENSED • INSURED • TRUSTED

NEW
CONSTRUCTION
REMODELING
HISTORIC
RESTORATION

931-924-2444 sweetonhome.com



Monteagle-Sewanee Rotary Club
—Service Above Self

Visit one of our meetings and get to know what Rotary is all about.

Attend a local meeting and meet some of our Monteagle-Sewanee Rotarians. Our Rotary Club often hosts programs of interest to our community at large, including presentations by artists, business leaders and government representatives. Visitors are always welcome!

Breakfast Meeting Thursday, 8 a.m., Sewanee Inn

This month's events:

Feb. 7: Sheri Kling, Exec. Dir. of the School of Theology's Beecken Center
Feb. 14: Chef Rick Wright, Director, Sewanee Dining
Feb. 21: Nate Wilson, The Mountain Goat Trail
Feb. 28: Hilary Ward, Director of the Sewanee Summer Music Festival

For more information, or to plan a visit, email Lee Harmon at leegreenharmon@gmail.com, website: www.monteaglerotary.org

A PORTION OF SALES MADE THROUGH OUR
OFFICE WILL BE DONATED TO HOUSING SEWANEE

Views on Adapting to Business Challenges Lecture

Mike Deimler, P'14, a senior partner and managing director in the Atlanta office of the Boston Consulting Group (BCG), will speak at 4:30 p.m., Monday, Feb. 4, in the Torian Room in duPont Library. Deimler's presentation, "When the Game Gets Tough, Change the Game," will offer insights into creating business success with agile leadership. The lecture is free and open to the public and will be followed by a reception to meet Deimler, the Babson Center's Bryan Viewpoints Speaker for the 2019 Easter Semester.

BCG is one of the world's top management consulting firms, with locations in more than 50 countries. Deimler joined the firm in 1990 after earning his M.B.A. at the University of Pennsylvania's Wharton School of Business. From 2005 until 2013, he was the Global Leader of BCG's Strategy Practice.

In his leadership role, Deimler guided the firm's investment agenda and training curriculum related to implementing programs driving growth and change. BCG is considered to be among the innovators in strategic planning and corporate strategy, developing many of the key concepts used today to assist companies in adapting to dynamic business environments.

At BCG, Deimler provides guidance to a broad range of companies, particularly those seeking

to enter new Asian markets and the travel industry. In 2000, he played a senior role in the initial launch of Orbitz.com, a travel fare website and travel search engine. Deimler was also instrumental in the acquisition of Atlanta-based BrightHouse, a management consulting company, which happens to be led by Sewanee alumni and offers internships to Sewanee undergraduates.

Deimler is the principal editor of "Own the Future," a 2013 book on the attributes required to gain a competitive advantage in today's turbulent marketplace while building sustainable businesses. In 2005, he coedited the bestselling book "The Boston Consulting Group on Strategy," a curated compilation of BCG's best thinking on strategy topics. Deimler is also the author of "Adaptive Advantage: Winning Strategies for Uncertain Times."

In addition to his work with for-profit firms, Deimler also advises numerous nonprofit organizations, including the Boy Scouts of America, Feeding America, and Opportunity International, on strategy and direction.

The Bryan Viewpoints Speaker Series is sponsored by the Babson Center for Global Commerce and is made possible by a generous gift from Peggy and J.F. Bryan IV, C'65.

We're glad you're reading the Messenger!

BUG PROBLEMS?

We can help! Call us for a free inspection!

BURL'S TERMITE & PEST CO.

TERMITE—PEST—VAPOR CONTROL
Bonded • Insured • Home-Owned & Operated
105 Ake St., Estill Springs
(931) 967-4547 or www.BurIsTermite.com
Charter #3824 • License #17759



Winchester Podiatry
CHARLES D. GANIME, DPM
Board Certified in Foot Surgery
Diplomate, American Board of Podiatric Surgery
New Patients of All Ages Welcome! We Treat Your Feet! Most Insurance Accepted, Including TennCare
155 Hospital Road Suite I, Winchester.
www.winchesterpodiatry.com
931-968-9191

K&N Maintenance and Repair
Your "honey-do" list helper!
A one-stop solution for all your home improvement needs
931-691-8656

SEWANEE AUTO REPAIR
Complete Auto & Truck Repair
Tune-ups • Tires • Tire Repair • Brakes • Steering • Oil Changes • Batteries • Computer Diagnostics
All Makes & Models • Service Calls • Quality Parts
ASE Master Certified Auto Technician • 31 Years' Experience
Open 7 to 5 M-F
(931) 598-5743 • 76 University Ave.

SENIOR CENTER NEWS

The Sewanee Senior Center serves lunch at noon Monday through Friday. The suggested donation is \$4, regardless of your age. Please call 598-0771 by 9 a.m. to order lunch. Menus follow:
Monday, Feb. 4: Grilled chicken, Greek salad, crackers, dessert.

Tuesday, Feb. 5: White bean chicken chili, apple salad, crackers, dessert.

Wednesday, Feb. 6: Shepherd's pie, salad, roll, dessert.

Thursday, Feb. 7: Pork chop, scalloped potatoes, green beans, roll, dessert.

Friday, Feb. 8: Beef and noodles, corn on cob, slaw, roll, dessert.

Menus may vary. For information call the center at 598-0771.

Regular Activity Schedule

Chair exercises, Mondays and Wednesdays, 10:30–11:15 a.m.; Tuesdays at 10:30 a.m., the group plays bingo, with prizes; Wednesdays at 10 a.m., the writing group gathers at 212 Sherwood Rd.; Fridays at 10 a.m. is game time.

The Sewanee Senior Center does not charge any membership fee. All persons 50 or older who take part in any of the activities are considered members.

Community Service Nominees Wanted

The Sewanee Civic Association (SCA) invites nominations for the 36th annual Community Service Award. The award recognizes the person or organization that has made outstanding contributions to the community. The kind of contribution varies widely, but the recipient is one who has helped make Sewanee a better place and improved the quality of life for everyone in the area.

Nominations are due by Friday, March 15.

Past recipients are not eligible to receive the award again. Send the name of your nominee, along with a brief paragraph of why you are nominating this person and/or group, to <sewaneecommunitychest@gmail.com>. Nominations can also be mailed to the Sewanee Civic Association, P.O. Box 222, Sewanee, TN 37375. The award will be presented at the SCA's April 4 annual membership meeting.

Past recipients include Sarah Marhevsky; Kathleen O'Donohue; Mickey Suarez; GSA Allies; Pixie Dozier; Barbara Schlichting; Helen Bailey; Sewanee Youth Soccer; Dr. Matt Petrilla; Harry and Jean Yeatman; Marshall Hawkins; Karen Keele; Tom Watson; Susan Binkley and the Blue Monarch; the Sewanee Senior Center Food Pantry (Lena McBee, Sue Hawkins, Charlsie Green); George and Ruth Ramseur; Dr. John Gessell; Dora Turner; the Community Action Committee; Geraldine Hewitt Piccard; Myrtis Keppler; Connie Warner; Ina May Myers; Pete Green; Duval and Boo Cravens; Housing Sewanee; Arthur Ben and Betty Nick Chitty; Harry and Millie Dodd; the Sisters of St. Mary's; Martha Dugan; Emerald-Hodgson Hospital Auxiliary; David Green; Joe David McBee; Robert Lancaster; Maria Webb; Doug Cameron; Phoebe Bates; Marilyn Powell; and Louise Irwin.

"When you own your breath, nobody can steal your peace." —unknown



SATURDAY MORNING YOGA

8:30–9:45, with Richard Barrali
at the Sewanee Community Center

All levels welcome.

Practice is somewhere between challenge and ease.

Classes for every BODY!

For more info call 423-667-9075 or email richbarrali@gmail.com

Author and Healthcare Leader to Give Talk on Values-Based Leadership

Jeff Thompson, M.D., pediatrician, author, and CEO emeritus at Gundersen Health System, will give a talk on values-based leadership at 4:30 p.m., Thursday, Feb. 7, in the McGriff Alumni House at the University of the South. All are invited.

Thompson is a frequent speaker on the topic of building a mission-driven culture as a values-based leader. His talk is titled "Values-Based Leadership: True Leaders Put People, Organizations, and Community First." His experience in leadership is far-reaching, having led diverse teams and projects before holding multiple senior executive roles within the Gundersen Health System. This experience has shown him repeatedly that leading from one's values gives an organization the power to compete successfully while creating meaningful long-term change. Thompson has been consistently recognized for improving quality, lowering costs, and serving the community by achieving positive outcomes in both healthcare and environmental stewardship.

Thompson's visit to campus is sponsored by the Center for Leadership. He will meet with several groups while at Sewanee, in addition to giving the public talk.

Sewanee Hearts and Grocery Carts at Otey

Sewanee Hearts and Grocery Carts, an annual event held by the ladies of Kappa Omega, raises money and collects canned goods for the Community Action Committee. All community members are invited to Otey Parish to celebrate Valentine's Day and the spirit of service and helping others.

At the event, each donor receives tickets that can win gift cards from local businesses such as OctoPi, The Sewanee Inn, Mountain Goat Market, and Mooney's. Attendees can also participate in a silent auction to bid on creative baskets made by local organizations. The event includes free, family-friendly, Valentine-themed activities such as cookie decorating, as well as food. Please help support the CAC by coming to Otey Parish on Sunday, Feb. 10, from noon to 2 p.m.

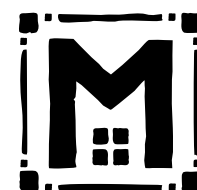

MOLICA
CONSTRUCTION LLC

931 205 2475

WWW.MOLICACONSTRUCTION.COM

- CRAFTSMANSHIP •
- CREATIVITY •
- SUSTAINABILITY •



piggly wiggly

Down Home, Down the Street

754 West Main St., Monteagle
(931) 924-3135

8 a.m. to 9 p.m. 7 days a week

SES MENUS

Monday–Friday,
Feb. 4–8
LUNCH

Monday, Feb. 4: Turkey and cheese sandwich, pulled pork sandwich, tomato bisque soup, sidewinder potatoes, dill pickles, fruit.

Tuesday, Feb. 5: Taco, chicken fajita, oven fries, salsa, pinto beans, tortilla chips, Spanish rice, fruit.

Wednesday, Feb. 6: Chicken + dumplings, cheesy breadsticks, carrot dippers, redskin potatoes, buttered corn, fruit.

Thursday, Feb. 7: Chicken pot pie, ham smackers, turnip greens, potato smiles, black-eyed peas, cookie, fruit.

Friday, Feb. 8: Spaghetti, zesty orange chicken, garden salad, green beans, buttered corn, garlic breadstick, seasoned rice, fruit.

BREAKFAST

Each day, students select one or two items.

Monday, Feb. 4: Cocoa cherry nutrition bar, oatmeal or yeast ring.

Tuesday, Feb. 5: Biscuit, sausage or chicken, gravy, jelly.

Wednesday, Feb. 6: Chocolate muffin, yogurt or bacon, egg + cheese croissant.

Thursday, Feb. 7: Cheese stick, chocolate crescent or cinnamon twist.

Friday, Feb. 8: Biscuit, sausage or chicken, gravy, jelly.

Options available every breakfast: assorted cereal, assorted fruit and juice, milk varieties.

Menus subject to change.

SCHOOL CALENDAR

Feb. 18, Presidents' Day, No school Franklin, Grundy and Marion counties

March 9–24, Spring Break, St. Andrew's–Sewanee

March 14–24, Spring Break, University of the South

March 18–22, Spring Break, Franklin and Grundy county schools

March 25–29, Spring Break, Marion County



Be sure to check out our made-from-scratch cookies, scones, pies, & quiches!

Mon–Wed, 7:30am–midnight;
Thurs & Fri, 7:30am–10pm;
Sat, 9am–10pm; Sun, 9am–midnight
Georgia Ave., Sewanee



598-1786



Like Us On facebook for specials and updates



The winners for the annual Monteagle Elementary School Spelling Bee were Kierra Buchanan, eighth grade, champion; Mikaela Sampley, fifth grade, second place; Caden Rose, eighth grade, third place; Ella Masters, eighth grade, fourth place; and Danica Parmley, sixth grade, alternate. MES congratulates the winners and wish them luck at the Marion County District Spelling Bee at 6 p.m., Feb. 12, at Jasper Middle School.

SCC Summer Day Camp

Sewanee Children's Center is now taking applications for children ages 2–6 for its Summer Day Camp. A minimum of 20 need to enroll.

The Summer Day Camp will run for 8 weeks, from June 3 through July 26 from 7:45 a.m. to 5 p.m. Program tuition is \$1,500 with a \$200 non-refundable deposit due with the application that will be applied to tuition. Scholarships are available.

The program includes a combination of structured learning activities along with supervised play and time for exploration outdoors and in centers. Each week, themes such as "Wonderful World of Water," "Bugs Galore," and "Exploring Rainbows" will guide the planned activities.

To request an application, or for more information, contact Sandy Glacet at (931) 598-5928 or <sewaneechildrenscenter@gmail.com>. Applications and deposits are due by March 1.

Sewanee Children's Center is supported by Otey Parish and the Sewanee Community Chest.



These students at Sewanee Elementary received the Citizenship Award for the past six weeks period. Front row, from left: Ian Brain, Arabella Barry, Hiyasa Patel, Nora Jane Elrod, Alex Glacet and Adelyn Knight; back row, from left: Myles McLaurin, Ciara Hurley, Raylan Thomas, Eli McLaurin, Noah Barnes and Maddie Van de Ven.



These students at Sewanee Elementary received the Laws of Life Award for Diligence. Front row, from left: Emmelia Leffler-Mitchell, Gus Hegwood, Ian Tucker, Ella Brain, Grant Rundle and Grace Sparacio; back row, from left: Amelia Pond, Mollye Casey, Brady Hall, Sam Frazier, Lily Cam and Gillian O'Connell.

Shop and Dine Locally!

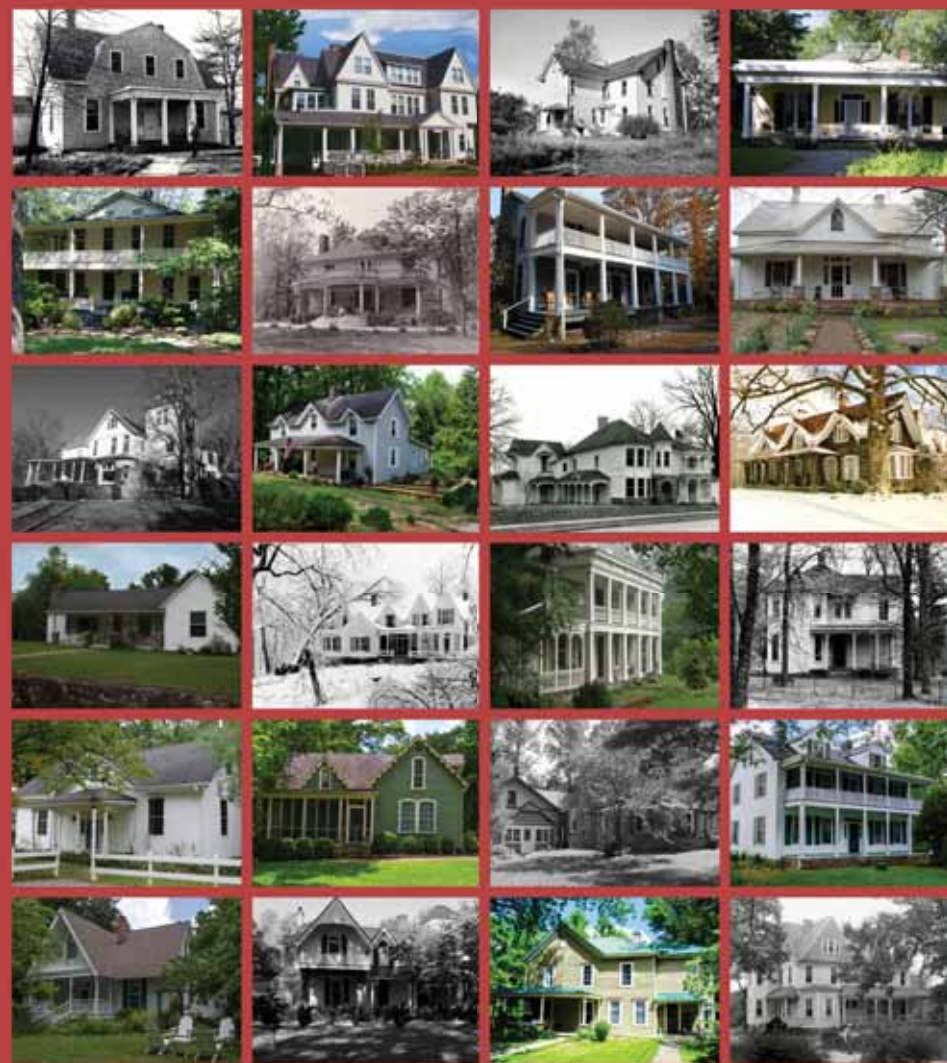

Historic Houses of Sewanee

OPENING EXHIBITION AND PRESENTATION

Friday, Feb. 7, 5:30–7 p.m., University Archives

AVAILABLE TO ORDER:

For houses of any age, on the Domain, house plaques designating the year or decade the house was constructed for \$135



COMMEMORATIVE ITEMS FOR SALE:

Posters in two sizes: small (14"x18") for \$15, or large (24"x36") for \$30, check or exact change only

SEWANEE
THE UNIVERSITY OF THE SOUTH

A project of the University Archives and Special Collections
and the Sewanee Trust for Historic Preservation



For additional posters or a house plaque, please contact STHP via email at coachwil@bellsouth.net

Online and in color!

SEWANEE MESSENGER.COM

AT THE MOVIES

SEWANEE UNION THEATRE

Friday–Sunday, Feb. 1–Feb. 3, 7:30 p.m.
Fantastic Beasts: The Crimes of Grindelwald
 PG-13 • 133 minutes

In an effort to thwart Grindelwald's plans of raising pure-blood wizards to rule over all non-magical beings, Albus Dumbledore enlists his former student Newt Scamander, who agrees to help, unaware of the dangers that lie ahead. Lines are drawn as love and loyalty are tested, even among the truest friends and family, in an increasingly divided wizarding world.

CINEMA GUILD

Wednesday, Feb. 6, 7:30 p.m., free
Popstar: Never Stop Never Stopping
 R • 87 minutes

Childhood friends Conner (Andy Samberg), Owen (Jorma Taccone) and Lawrence (Akiva Schaffer) found fame and fortune after forming the hip-hop group the Style Boyz. Owen and Lawrence faded into the background when frontman Conner left the band to launch a successful solo career. Now, the egotistical singer decides to film a documentary about his life while he's still on top. When his second album flops, the camera is there to capture his world come crashing down.

SEWANEE UNION THEATRE

Thursday–Sunday, Feb. 7–10, 7:30 p.m.
A Star Is Born
 R • 134 minutes

Seasoned musician Jackson Maine discovers, and falls in love with struggling artist Ally. She has just about given up on her dream to make it big as a singer until Jackson coaxes her into the spotlight. But even as Ally's career takes off, the personal side of their relationship is breaking down, as Jackson fights an ongoing battle with his own internal demons.

Movies are \$3 for students and \$4 for adults, unless otherwise noted. Cinema Guild movies are free. The SUT is located on South Carolina Avenue, behind Thompson Union. The SUT accepts credit/debit cards.

SAS Gallery to Feature Copper and Clay

More than 20 years ago, G. Sanford McGee went looking for a piece of copper he'd stowed a few years earlier on the edge of his yard while working on building his off-grid home near Sewanee, Tenn. McGee, a science teacher, naturalist and artist, was finally ready to begin the copper-faced architectural frieze he had planned for his new home. After locating the copper panel and pulling away the accumulated layers of plant and leaf decay, McGee met with an epiphany. The hand of nature had taken over, adding layers of patina to the copper, colors and forms telling the story of the particular leaves, plants and their chemical components interacting with the copper sheet. Another home-builder might have considered the copper ruined for their purposes. But, McGee, with his artist's eye, understanding of chemistry and deep knowledge of the plants of his native Cumberland Plateau was uniquely prepared to recognize and appreciate the opening of an artistic collaboration with nature.

McGee has continued the dialogue between his artistic practice and the natural world. These sublime yet highly physical works have been enthusiastically received and are exhibited across Europe and the U.S.

McGee's work will be featured in the SAS Gallery, along with another artistic collaboration: Annie Hanks Ceramics Studio of Chattanooga, Tenn., the joint project of Stephanie Anne Martin and Katherine Hanks. Their utilitarian, sculptural bodies of work combine a contemporary aesthetic



Annie Hanks Ceramic Studio

with timelessly simple forms. Matte finishes and pale neutral colors add to the elemental character of their porcelain and stoneware.

Hanks, a Texas native with a lifelong affinity for the natural world, recognizes the influence of her native Hill Country landscape on her Annie Hanks work. Meanwhile, Stephanie Martin's connection to clay is more inwardly-focused; she describes her ceramic work as a manifestation of internal growth into tangible form.

In the five years since its founding, the studio has flourished, with its functional work featured in Scenic City Supper Club and Wildflower Tea Shop in Chattanooga, as well as the Hunter Museum of Art's popular Examinations project.

Annie Hanks Ceramics and G. Sanford McGee's works on copper can be seen in the SAS Gallery. There will be a public reception for the artists on Saturday, Feb. 9, 4-6 p.m.

Hours are Monday through Friday, 9 a.m.–3 p.m., and by appointment. Contact Gallery Director Julie Jones at <sasgallery@sasweb.org> for more information.

The Arts Company Presents 'Side By Side'

The Arts Company presents its February exhibition "Side by Side," showcasing contemporary diptychs from current and new gallery artists. Highlighting a diversity of styles, materials and techniques, featured artists were asked to create new pieces reflecting February's diptych theme. Works will range from traditional diptychs to pieces that offer a unique take on the diptych style. Opening during FirstBank First Saturday Art Crawl on Feb. 2, from 6-9 p.m., the exhibition will continue through Feb. 21 during regular gallery hours, 11 a.m.–5 p.m., Tuesday-Saturday, at the downtown Nashville location, 215 5th Avenue of the Arts, North.

Featured artists include Cassidy Cole, Nick DeFord, Ke Francis, Mandy Rogers Horton, Charles Ivey, Bill Steber, Denise Stewart-Sanabria, Daryl Thetford and more.

For more information, go to <www.TheArtsCompany.com>.

Ralston Listening Events

The William Ralston Listening Library, a state of the art listening room on the second floor of the Jessie Ball duPont Library, is hosting several upcoming events.

Monday, Feb. 4, 3-4 p.m., Mendelssohn's Midsummer Night's Dream; 4-5 p.m., Tori Hinshaw, Greta van Fleet's "Anthem of the Peaceful Army"; 6-7 p.m., Jackson Campbell, Rolling Stones' "Exile on Main Street"; 8-9 p.m., Isabel Butler and Heidi Hayne, Otis Redding.

Tuesday, Feb. 5, 4-5 p.m., Ivana Porashka, 80s hits; 6-7 p.m., Anna Wilson, classic rock.

Wednesday, Feb. 6, 5-6 p.m., Annie Bowers, Mendelssohn's Octet in E-flat Major; 6-7 p.m., Wilder McCoy, Bossa Nova, feat. Jorge Ben; 7-8 p.m., Meg Sheehy, "Who's That Lady," feat. Stereolab.

Thursday, Feb. 7, 6-7 p.m., Brant Lewis, Simon and Garfunkel's "Bridge over Troubled Water."

Friday, Feb. 8, 4-5 p.m., Mendelssohn's Symphony No. 2 (Hymn of Praise); 5-6 p.m., Caleb Thorn, Kamasi Washington and John Coltrane.

Sunday, Feb. 10, 6-8 p.m., Caiti Berends, Handel's Giulio Cesare.

TELL THEM YOU SAW IT HERE.



MICHELLE M. BENJAMIN, JD Attorney & Counselor at Law

201 FIRST AVENUE, NORTHWEST
 WINCHESTER, TENNESSEE 37398

(931) 962-0006
 Fax: (931) 967-8613

DEPENDABLE AFFORDABLE RESPONSIVE HOME REPAIR AND REMODELING EXPERT HANDYMAN

KEN O'DEAR

25 YEARS EXPERIENCE
 SATISFACTION GUARANTEED

931.235.3294

931.779.5885



Valentine's Day Specials!



All Sweet Southern Spirit desserts are handmade, one at a time.

Call to Pre-Order your desserts today!

5 days lead time required for most orders

www.sweetsouthernspirit.com

(931) 247-8958

'Sweepstakes Red' at Carlos Gallery

The Carlos Gallery in the Nabit Art Building at University of the South will present "Sweepstakes Red," an exhibition of paintings by Chicago artist Carris Adams. The exhibit will be on display through March 14. An artist talk and opening reception will be at 4:30 p.m., today (Friday), Feb. 1.

"Sweepstakes Red" presents a series of large-scale paintings of text, language and imagery that recall signage indicative of neighborhoods and public spaces. Her work investigates markers such as advertisements, roads, residential structures and commercial structures and the relational threads between ownership in marginalized spaces and politics, class, histories, celebration and resilience.

Presented on unstretched canvases, the paintings behave like posters or billboards, aligning themselves with hand-painted insignias found in local communities and neighborhoods. The paintings rely on viewer's recollection of spaces they may have once visited or inhabited, inviting them to consider how mere text and imagery may be indicators of location, race, class or gender. The conceptually multi-layered works ask viewers to recognize their assumptions, recall an experience and perhaps note how societal markers materialize in the landscape.

The Carlos Gallery is at 105 Kennerly Rd. Hours are 8 a.m. to 5 p.m., Monday through Friday, and 1 to 5 p.m., Saturday and Sunday. For more information contact Jessica Wohl at (931) 598-1256 or <jewohl@sewanee.edu>.

THE LOCAL MOVER
 615-962-0432

Need More Room?

We Sell Boxes!

Sewanee Mountain Storage
 (931) 598-5682

■ Security Gate Dan & Arlene Barry ■ Security Camera
 Hwy 41 - Between Sewanee & Monteagle

U-HAUL MOVING BOXES and SUPPLIES!
 —Various Sizes—

KIT TO PROTECT YOUR FLAT-SCREEN TV!



Zoom Groom Mobile Pet Spa Pet grooming at your home!

Call (931) 313-9950
 or book online
 www.zoom-groom.com

Serving Franklin, Coffee
 and Marion counties



HEAVEN ON EARTH... NOW AVAILABLE IN SEWANEE



MYERS POINT at Sewanee offers a rare opportunity to enjoy a private community that celebrates American architecture, lifestyle, protected forests, cultivated lakes and panoramic views on Middle Tennessee's Cumberland Plateau. If you want to live surrounded by nature, history, beauty, quality and serenity, you'll want to call it home.

|||

John Goodson
 (931) 703-0558

jgoodson@myerspoint.com
 myerspoint.net

ANGELWITH AN ATTITUDE

by Virginia Craighill



Dear Angel,

What's this I hear about a cell tower going up at the football field? I live nearby and don't recall getting any information about this until I read about it in last week's Messenger. Couldn't they put it somewhere else? Is it going to be unsightly?

Signed,
Uninformed

Dear Uninformed,

Hopefully a new cell tower will improve communication around Sewanee. Perhaps the reason you and other neighbors weren't aware of the location choice until now is because you have really bad cell service and missed all the calls from people who care about your opinion.

Though the other locations considered were not specifically named, sources revealed that they were 1) the vegan line at McClurg, 2) the alien landing circle in the Lake Cheston parking lot, and 3) Lower Cravens. Clearly no one wanted to denigrate the architectural purity of Lower Cravens by putting a cell tower there, so the obvious choice is where hardly anyone ever goes: Harris Stadium.

As for being "unsightly," the tower will be about 189 feet tall, but it will be "tucked away" behind the football field, so just like that bottle of Jack Daniels you have "tucked away" behind the tax files in your drawer, it probably won't be noticeable at all. In other good news, it is a Vogue Tower, which could mean it will be shaped like one of those abnormally tall European fashion models. Even if it is a looming monstrosity, it doesn't matter as no one in Sewanee will ever look skyward again. Once we have good cell service all the time, there's no reason to take our eyes off the tiny screen that contains all we need of life.

Angel

Dear Angel,

I have to park in the Gailor parking lot for work, but every time I pull up the hill, I feel like I'll have as much luck finding a parking space as I will winning the Powerball Lottery. When will this nightmare end?

Signed,
Parking Lottery Loser

Dear Loser,

Your PowerBall analogy makes sense; getting a parking spot at Gailor after 8 a.m. feels like you've just won MegaMillions, but like winning the lottery, a parking space comes with its own set of problems: if you leave your money or your parking space at any point during the day, it will be gone when you come back, and every time you leave the building, you will encounter stalker cars, angling for some of your good luck.

The Gailor parking lot situation actually comes closer to Fortnite Battle Royale: you drive into the lot and must compete with 100 others players hoping to scavenge the sole remaining parking spot. Sometimes you can work in teams: professors about to leave Gailor can text you before they exit the building to let you know where their car is, so you can idle behind their space, but make sure no one else outmaneuvers you. You can eliminate players by calling SPD to report illegally parked student cars, but that will take some time. If you don't win, you'll be forced to turn your car around at the top of the lot without hitting any other cars; this will take you at least 30 extra minutes with no guarantee of finding a place to park closer than Monteagle.

Like Fortnite Battle Royale, danger is rampant in the Gailor parking lot. To quote Wikipedia on Fortnite: "players outside that safe area take damage and can be eliminated if they fail to quickly evacuate. This forces remaining players into tighter spaces and encourages player encounters." Weaponized Monster Trucks filled with physically able students appear out of nowhere to park in Handicapped Spots, or to take up three illegal blue spaces with one vehicle because their muscular truck beds stick out too far, squeezing you into "tighter spaces." These same gargantuan trucks will dent, scratch, or crush your tiny professor Subaru as they pull out of the lot without ever seeing it, eliminating you from the game forever!

Good luck, and be careful out there,
Angel

GAAC Sculpture Competition

The Grundy Area Arts Council (GAAC) and the Mountain Goat Trail Alliance (MGTA) are pleased to announce the Old Roundhouse Park & Mountain Goat Trail Sculpture Competition for 2019. The GAAC and the MGTA seek proposals for site-specific sculptures from Tennessee and regional artists to provide an opportunity for artists to create a public work and to enhance the trail with sculpture.

The location for the sculpture will be visible from the Mountain Goat Trail in the newly developing Old Roundhouse Park. The 2019 approved site will be central to the proposed completed trail. Works can be in any media, must be suitable for outdoors, must be "sit-able" and should be permanent. Entries should incorporate elements of the story and culture of the Mountain Goat and the Plateau region it served. The selected work will be announced in March, and the finished work will be celebrated in June 2019.

This project is made possible with an Arts Builds Community Grant from the Tennessee Arts Commission. Proposals are due Feb. 15. The full application can be found at <www.mountaingoattrail.org/2019-sculpture-competition/>. For more information email <grundyareaarts@gmail.com>.

Workshops at Artisan Depot

Kim Phillips offers a "Beaded Magnet Mini-Workshop" from 1-3 p.m., Sunday, Feb. 10. Class fee is \$18. Make unique magnets using both new and repurposed materials: glass, beads, wire, old metal, wherever your creative urges take you. Instructor will start you off with lots of bits and pieces, as well as a base and a revolutionary mosaic "grout" that will make your projects a breeze.

The February paint-and-sip is "You Float My Boat" on Thursday, Feb. 14 at 6 p.m. Pre-registration is required, and seating is limited.

Pre-registration is required for all workshops at the Artisan Depot. Online registration is available at <www.franklincoarts.org/workshop-details>.

The Artisan Depot is the gallery and gift shop of the Franklin County Arts Guild and is located at 204 Cumberland St. East, Cowan. Questions? Call workshop coordinator Kim Phillips at (615) 829-0772.



"fall in the woods" 24x32 diptych acrylic

In-Town Gallery Exhibits 'poems for the sky'

In-Town Gallery features a showing of paintings entitled "poems for the sky" by Chattanooga artist, Jaime Barks. Barks, who grew up roaming the foothills of the Smoky Mountains, creates dynamic paintings characterized by a strong sense of design, line, and color that seek to capture the wild earthy magic she felt during those hours alone in the woods.

"My goal," she says, "is to make artwork that connects people to nature and to each other."

Jaime Barks' paintings are in numerous private collections and public venues throughout the United States. Though she chose to get her degree in communications, she has been drawing all her life. After her children were born, she embarked on a rigorous project in which she made drawings everyday for two years. During this time she developed her distinctive technique using pen and watercolor before switching to fluid acrylics, the medium she most often uses today.

Barks' distinctive paintings are immediately recognizable. Her painting "fall in the woods" is a diptych composed of two 24 inch by 16 inch panels. The work presents us with stability and grandeur in the depiction of a boldly drawn tree trunk that unites the two panels, soaring upward, leading the viewer's eye to the dancing yellow leaf canopy above. The artist's rhythmic use of line combines with the lively yellows to suggest a life force flowing to the sky.

Barks' "poems for the sky" will be on display through Feb. 28, with an opening reception Friday, Feb. 1, 5-8 p.m.

In-Town Gallery is an artist co-op gallery that is open seven days a week and offers a wide range of art and fine craft from 32 artists, including paintings in many media, hand-painted silk scarves and clothing, sculpture, pottery, and handcrafted wood items. The gallery is located on the North Shore at 26A Frazier Ave., (423-267-9214). For more information, visit <www.intowngallery.com>.

At the Galleries

The Frame Gallery

For the month of February, Mary Priestley will be showing illustrations from her new book "Sewanee Wildflowers in Watercolor." At the opening reception from 5:30-7 p.m., Friday, Feb. 1, there will be a book signing, and prints and note cards will also be sold.

The Frame Gallery is located at 12569 Sollace M. Freeman Hwy., Sewanee. The frame shop and gallery's regular hours are 10 a.m. to 5 p.m., Tuesday through Friday, and 10 a.m. to 2 p.m. on Saturday.

Stirling's Coffehouse

For the second year, the Sewanee Herbarium is sponsoring an exhibit at Stirling's Coffee House on the beauty of nature, titled "All Things Bright and Beautiful." This year,

the show emphasizes the natural sciences and is co-sponsored by the Environmental Arts and Humanities Program and the Sewanee Natural History Society.

For more information contact the herbarium curator at <mpriestley0150@gmail.com>.

University Art Gallery

The University Art Gallery presents "Familiar Faces," an exhibition by Atlanta-based artist Jiha Moon. The exhibit will be on display through March 11.

The University Art Gallery is located on Georgia Avenue. The gallery is free, accessible, and open to the public. Hours are 10 a.m. to 5 p.m. Tuesday through Friday and noon-4 p.m. on Saturday and Sunday.

www.sewaneemessenger.com

THE Sewanee institution since 1974

Shenanigans

RESTAURANT

=====

PUB & GRILL / PIZZA / DELI / CATERING
CALL FOR TAKE-OUT OR DELIVERY
931-598-5774

OPEN EVERY DAY 11 a.m. to 11:30 p.m. (later on weekends!)

12595 Sollace M Freeman Hwy, Sewanee, TN
(on the corner of University Ave and 41A)

FIND YOUR HAPPY PLACE...AT SHENANIGANS

Monteagle Sewanee, REALTORS



Ray Banks, Broker/
Owner
931-235-3365
rbanks564@gmail.com



Deb Banks, Realtor
931-235-3385
debbanks8@gmail.com



Dee Underhill Hargis,
Broker
931-808-8948
aduhargis@gmail.com



Tom Banks, Realtor
931-636-6620
tombanks9@yahoo.com



Anne C. Deutsch,
Affiliate Broker
931-205-1299
anne.sewanee@gmail.com

Competent, Caring, Friendly, Fair—We're Here for You!

www.monteaglerealtors.com • 931-924-7253

337 W. West Main Street, Monteagle

Find all the area MLS listings on our updated website!



The MAC swim team earned four high point trophies from the Tullahoma Swim Meet. Will Roberts (left) was the male 8-under age group winner, Anara Summers (middle) the female 9-10 age group winner, and Sam Frazier (right) and Kiran Malde (not shown) tied for the male 9-10 age group.

MAC Swims Tullahoma and Nashville Meets

The Tullahoma Swim team hosted the Karen Hamilton Swim Meet on Jan. 5, in honor of one of their swimmers, Karen Hamilton who lost her life to cancer. More than 150 swimmers from Scottsboro, Brentwood, Manchester, Sewanee, and Tullahoma came to compete in her honor.

Eighteen Mountain Aquatic Club (MAC) swimmers took home 70 top eight place finishes. Of the 83 swims by MAC swimmers, 51 were personal best times. National Time Standard (NTS) cuts were awarded to three swimmers: Will Roberts for B-Time cuts in 100 individual medley; Sarah-Russell Roberson for BB-Time cuts in 50 butterfly and 50 backstroke; and Loulie Frazier for BB-Time cut in 50 freestyle. National Time Standards for swimmers range from B to AAAA are based on relative speed within each age group. The time standards are based on the top 16th USA national time swim for each stroke and age group.

The team brought home four high point trophies. Will Roberts was the male 8 and under age group winner and Anara Summers was the winner for the female 9-10 age group; and Kiran Malde and Sam Frazier tied for the male 9-10 age group.

On Jan 19-20, the Ensworth School in Nashville hosted the

Frostbite Meet. There were more than 350 swimmers from Memphis, Birmingham, Ala., Lexington Ky., and Murfreesboro to compete in the two-day meet. Eleven MAC swimmers faced tough competition from some very large teams, but came away with 24 top 10 finishes. Of the 79 total swims, 50 were personal best times.

NTS cuts were awarded to Sawyer Barry for a B-Time cut for the 50 backstroke; Konrad Knoll for B-cuts for 50 breaststroke and butterfly and BB-cuts for 100 freestyle and individual medley; Sarah-Russell Roberson for a BB-Time cut for 100 freestyle; and Anara Summers for an A-Time cut 100 freestyle.

Three swimmers swam qualifying times for the Southeastern Championship Meet to be held in Huntsville, Feb. 23 and 24. Anara Summers qualified for 200 freestyle. Sam Frazier and Kiran Malde both qualified for 100 butterfly; and Kiran Malde also qualified for 100 breaststroke.

MAC is back in the water when they host and compete in a home swim meet at the University's Fowler Center Pool on Feb 2. Teams from Decatur, Scottsboro, Manchester, Tullahoma and Winchester will be competing. Go to <www.mountainaquaticclub.com> for more information.



St. Andrew's-Sewanee senior swimmers were honored at their last home swim meet. From left, Sophia Patterson, Ryan Val, Evan Panzarino and Randy Paul. Photo by St. Andrew's-Sewanee



St. Andrew's-Sewanee basketball players were honored at their last home game. From left, Coach Rob Zeitler, Dan Zhang, Jonathan Rwalinda, Larson Heitzenrater, Jay Tillman, Marshall Zhao, Saeed Abdilahi, Jeson Rwalinda and Coach Osei Hill. Photo by St. Andrew's-Sewanee

SAS Drops One to Notre Dame

St. Andrew's-Sewanee varsity boys' basketball team lost to Notre Dame Jan. 26, 63-46. Jalen Tillman had a career high 18 points and four assists; Larson Heitzenrater and Nathan King had 10 points each; Jonathan Rwalinda added six points; Finn Michler two points.

SAS Swimming Update

Last weekend, the St. Andrew's-Sewanee swim team competed in the middle school championship and the high school regional meet, concluding the season for the majority of the team's swimmers. The Mountain Lions set several personal bests and school records and ended a great season on a high note.

The high school team had nine swimmers qualify for the regional meet: Randy Paul, Sophia Patterson, Sarah Beth Hobby, Aidan Smith, Porter Neubauer, Sarah Grace Burns, Zolon Knoll, Anna Freyland and Kathleen Perkins. There were several top 15 finishes by the boys, as Knoll finished 14th in the 200 IM and 11th in the 500 freestyle; Smith finished 14th in the 100 yard butterfly, and Paul finished 15th in the 100 butterfly. The girls also had some great performances to cap off their impressive seasons, and Burns improved on her 50 freestyle by setting a new personal record of 28.68. The boys 200 yard medley relay, composed of Paul, Smith, Knoll, and Neubauer, set a new personal best and school record with a time of 1:47.44. The boys relay will look to continue their strong season and finish with their best time yet at the state meet in two weeks.

The middle school team had 15 swimmers qualify for the middle school championship: Libby Neubauer, AJ Clements, Madeline Sumpter, Dylan Kinningham, Luca Malde, Huxley Hume-Allingham, Caleb Palmertree, Jackson Frazier, Reese Michaels, Toby Van De Ven, Maya Mauzy, Elisabeth Perkins, Sienna Barry, Chris Moore and Loulie Frazier. Two new school records were set by Neubauer in the 200 yard freestyle and 100 yard backstroke. Jackson Frazier placed 10th in the 500 freestyle and fifth in the 100 breaststroke, while Clements finished 10th in the 100 backstroke. Other strong performances included personal bests from Sumpter and Perkins in the girls 50 freestyle, Barry and Perkins in the girls 100 freestyle, and Hume-Allingham in the boys 100 freestyle.



228 MORRIS DR., TRACY CITY, TN. Quality built home with room to grow. Property sits on a large lot. Great location minutes to I-24. Upstairs could be finished to make a fantastic space! Basement area includes workshop/garage. \$169,900 MLS#1982989



55 COOLEYS RIFT BLVD., MONTEAGLE, TN. Take a look at this bluff home located in a private, gated community in Monteagle! Pella windows, spacious decks, and modern appliances granite countertops! Very convenient to I-24 and Sewanee. Great bluff views and community lake access! \$319,900 MLS#1995859



1097 SAVAGE HIGHLAND DR. A nature lover's dream in the Savage Bluffs wilderness preservation area. Andersen windows, granite countertops, and custom cabinetry throughout. Stacked stone fireplace in the living area. All bedrooms on main level. Walking trails and amazing views! \$579,000



740 W MAIN ST., MONTEAGLE, TN. FOR LEASE! - Restaurant building located in a great part of town on a busy hwy! Spacious inside with a covered outside patio for seating. Cooler included. \$1750/month MLS#2000747



265 ESTHER DR., COALMONT, TN. PENDING!! - Lake front home! Split level with dock on 7.5 acres, 2 BR/2.5 BA, kitchen w/lots of storage space, master bedroom suite w/access to Florida room & upper deck, 2nd bedroom with half bath & access to lower deck. \$129,900 MLS#1995849

Coffee County Realty & Auction
Welcomes new agent,
Jacob Meeks!



Jacob Meeks
931.235.5093
jacobameeks@gmail.com



Jimmy Jernigan
931.409.7653
jimmy@realtracs.com

**SOUTHERN MIDDLE
TENNESSEE NUMBER
1 REAL ESTATE
COMPANY**

**COFFEE COUNTY
REALTY & AUCTION CO., LLC**

**Coffee County
Realty & Auction**

532 Hillsboro Blvd.,
Manchester, TN 37355
931.728.2800
2104 N. Jackson St.,
Tullahoma, TN 37388
931.455.3000
www.coffeerealty.com

Men's Basketball Survives Major Threat; Wins Third in a Row

The Sewanee men's basketball team escaped with a win on its home floor with a 62-59 triumph over the Majors of Millsaps College, Jan. 27, inside Juhan Gymnasium.

Trailing 8-4 with 13:30 left in the half, the Tigers went to work, making back-to-back triples to lead 10-8.

After the Majors evened the score, the Purple and Gold went on a 9-0 run to push the lead to 19-10.

The visitors were able to cut the deficit to as low as seven on two different occasions late in the first half, but the Tigers led by nine, 36-27, at the break.

Sewanee made the lead as big as 13, but Millsaps was able to cut the deficit to one with a little over a minute to go.

The teams were unable to get anything in the bucket in the final minute, but with less than 30 seconds left in regulation, the Majors had a chance to take the lead, but a steal by Jordan Warlick gave Sewanee possession.

After two free throws by Hunter Buescher with 2.2 seconds to go, the Majors had to go the length of the floor to attempt to tie the game, but an errant pass by Millsaps sealed the victory.

Hunter Buescher led the Tigers with 15 points, while Jordan Warlick posted 12 points. Matt Lee posted nine rebounds and eight points, while Luke Smith dished out six assists.

HOME GAMES

Friday, Feb. 8

6 p.m., University Women's Basketball vs. Berry

8 p.m., University Men's Basketball vs. Berry

Sunday, Feb. 10

1 p.m., University Women's Basketball vs. Oglethorpe

3 p.m., University Men's Basketball vs. Oglethorpe

Friday, Feb. 15

University Track and Field, Sewanee Indoor Invitational

Saturday, Feb. 16

9 a.m., SAS MS Boys' Soccer Jamboree

noon, 3 p.m., University Baseball vs. MacMurray

1 p.m., University Women's Basketball vs. Centre

3 p.m., University Men's Basketball vs. Centre



Ellie Treanton scored 20 points in Friday's win over Birmingham-Southern and 17 points on Sunday against Millsaps. Photo by Lyn Hutchinson

Women's Basketball Drops Contest to SAA Leader

The Sewanee women's basketball team saw the visitors shoot 52.2 percent from the floor, as the Tigers fell to the Southern Athletic Association leaders in Millsaps College, 68-59, Jan. 27, inside Juhan Gymnasium.

Both teams played a tight first quarter, with no team gaining more than a one-possession lead. Thanks to a triple by the Majors' Kasi Matthews, the game was even at 17 points apiece after 10 minutes.

The second quarter was all Millsaps. The visitors had a 34-23 half-time lead.

The Tigers attempted a comeback bid in the third quarter, cutting the 11-point deficit to two with a 20-11 run, 45-43 with 1:27 left in the period. However, the Majors scored the final four points to lead 49-43, and that lead would stand.

Ellie Treanton led all scorers with 17 points and added six rebounds. Sue Kim scored 13 points and dished out five assists. Kinsley Logan contributed 10 points, while Abby Young scored nine points and corralled eight boards off the bench.

ROB MATLOCK
CONSTRUCTION COMPANY
NEW HOME BUILDING
AND REMODELING

MEMBER, U.S. GREEN BUILDING COUNCIL

PHONE 931-598-5728

MATLOCK

State Licensed • Fully Insured

CUSTOM FRAMING
ARCHIVAL FRAMING & RESTORATION
ART CONSULTING & INSTALLATION

T-F: 10-5, Sat: 10-2 • (931) 463-2300
12569 SEWANEE HIGHWAY • SEWANEE, TN

TONIGHT AT 5:30
Artist Reception
& Book Signing
WILDFLOWERS
of SEWANEE By Mary Priestley
Exhibiting through February 28



Paisley Simmons took first place in both one meter and three meter diving in the swim meet at Birmingham Southern on Friday. Photo by Lyn Hutchinson

Tigers Conclude Regular Season Slate at Birmingham-Southern

The Sewanee swimming and diving teams took on defending Southern Athletic Association champion Birmingham-Southern in a dual on Jan. 25, at the Birmingham CrossPlex. The 21st ranked men's team defeated the Tigers, 122-81, while the women, who are receiving votes in the College Swimming and Diving Coaches Association of America (CSCAA) and are ranked ninth in the West-Midwest-South region, gave Sewanee a 141-97 loss.

Lee Haber won two events on Friday: the 400 individual medley (4:14.49) and the 100 breaststroke (1:00.65), which is a season-best for the sophomore. He missed his career-best by .05 seconds. Anthony Carbone won the 200 freestyle with a 1:45.01 clip, while Thomas Young swam a 57.10-second clip in the 100 butterfly. James Hoyt earned the win in the 500 freestyle (4:52.11), while Jarrod Marable scored 85.05 points on the one-meter dive. In the 400 freestyle relay, the quartet of Carbone, Haber, Hoyt and Young won the event with a 3:21.53 clip.

Paisley Simmons won both the one-meter (208.65) and the three-meter dive (207.38). Gabby Acker took home the win in the 100 backstroke with a 1:02.79 time, a season-best for the freshman. Kate Mabry won the 100 butterfly with a 1:00.96 mark. Mabry, Anna Hawkins Dulaney, Isabell Loy and Acker won the 400 freestyle relay (4:04.56).

South Cumberland Farmer's Market



Weekly Features

Lamb Chops from Solace Farm
Variety of grass fed and finished beef cuts from Dayspring Farm

Order online Friday, 9 p.m.—Monday, 10 a.m.
sewanee.locallygrown.net/
Pickup Tuesday, 4:30–6 p.m.
Sewanee Community Center

G. Robert Tubb II, Owner
931-967-3595
A1ChimneySpecialist.com

CSIA Certified Technicians
Video Inspections • Sweeping
Restoration • Masonry Repair
Custom Caps & Dampers
Leak Repair & Water Proofing
Wood Stove & Chimney Installs
Gas Log Service & Installs
Dryer Vent Cleaning/Repair

Valentine's Dinner

Choose the date!
Thursday, Feb. 14
or Saturday, Feb. 16.
Reservations: (931) 592-4832
Seating is limited.

Tea on the Mountain

11:30 to 4 Thursday through Saturday
DINNERS BY RESERVATION
(931) 592-4832
178 Oak Street, Tracy City

The Lemon Fair

"Locals" Discount
Complimentary Gift Wrapping!!!

NATURENOTES

by Yolande Gottfried

American Woodcock

As the days begin to lengthen it's an excellent time to start observing the earliest signs of spring on the plateau. One such sign that winter will soon give way to warmer weather is the magnificent display of the American Woodcock. Also known as the Timberdoodle, this odd sandpiper isn't found on coastal beaches but in old fields and young forest across the entire eastern US. Across much of its range it's the first bird to start breeding activity, and we're lucky enough to have several pairs that breed around the Sewanee-Monteagle Airport!

The display starts just after sundown every day; the bachelor will select a patch of ground and begin to repeat a short, nasal 'peent!' call. He waits for just the right moment (known only to him) and without warning flies up from the ground with a wing-whir like a startled Mourning Dove. While you or I might assume that the bird was merely flushed, we'd soon be corrected by a soft twittering sound coming from high above us. It gets faster and louder and eventually you catch sight of a small, dark shape twisting and spiraling down from a great height to land in exactly the same spot it left a few minutes earlier. In my opinion this is one of the most spectacular displays of any bird to be seen in this area. The incredible part is that the twitter isn't the bird singing, but specially designed primary feathers which catch the air, producing chirping and whistling sounds as the bird twirls and dives down to earth. If you've ever used an 'Audubon' twist bird call, that's essentially the exact sound the wings make.

If you'd like to try to see this display, plan to arrive just before sunset at the intersection of Midway and Jump Off roads at the east end of the airstrip. In recent nights, the brushy area just to the northeast of this spot has hosted two males displaying simultaneously from different hidden spots. Listen for the 'peent' and when you hear the twittering call, watch above for the flight display (because the drama unfolds after sundown, it's often quite difficult to spot the birds against a dimly lit sky). The birds typically start displaying in this area in late December and continue as the weather warms. Winter can sometimes be a slow time of year for birders, but the flight of the Timberdoodle is a reminder that spring is coming.

—reported by Angus Pritchard, C'22



Louis Rice sends in this photo of the first crocus of the year. He spotted this in his backyard on Jan. 27, at 1:30 p.m.

State Park Offerings

Please note: To confirm that these events will occur as listed go to <<http://tnstateparks.com/parks/events/southcumberland/#/?park=south-cumberland>> or call (931) 924-2980.

Sunday, Feb. 3

Sherwood Forest Trail Build (free)—Join in with other South Cumberland trail blazers at 1 p.m. at the Sherwood Forest parking lot, (go out Jump Off Road to Old CCC Camp Road, and go just past Coyote Cove Lane) to help finish a brand new loop trail at the park. The trail is now open for a variety of public uses, but your help is needed to continue the work. Please be prepared with sturdy footwear and plenty of water/snacks. If you have favorite trail-building tools or pairs of gloves, feel free to bring them. Note: You can only access Old CCC Road from Jump Off Road, not from Sherwood Road!

Saturday, Feb. 9

Birds of Prey (free)—Meet Ranger Ryan Harris and Artemis, the Park's beautiful Red-tailed Hawk, at 1 p.m. at the State Park Visitors' Center, 11745 U.S. Hwy. 41, Monteagle. Learn about Artemis' story, why she lives in an aviary at the park, and facts about birds of prey and how they fit into the ecosystem. (Artemis doesn't like dogs, so please have yours on a leash or better yet, in the car.)

Tuesday, Feb. 12

Nature Hike to Great Stone Door (free)—Meet Ranger Dan Wecoat at 10 a.m. at Stone Door Ranger Station, 1183 Stone Door Rd., Beersheba Springs, for a 2-mile roundtrip hike to the Great Stone Door overlook. One of the park's most expansive views, Stone Door is sure to impress. Be sure to bring or wear sturdy hiking shoes, as well as water and snacks. You will want your camera.

The South Cumberland State Park Visitors' Center is located on Highway 41 South between Monteagle and Tracy City and is open 8 a.m.–4:30 p.m. seven days a week. For more information call (931) 924-2980.

Herbarium Winter Events

Herbarium Tour and Mountathon, Sewanee Herbarium, Spencer Hall, Saturday, Feb. 2, 9:30-11:30 a.m., with Herbarium Curator Mary Priestley. Come help us mount our backlog of specimens. Learn methods that have been passed down through generations and are still used today, and take home a guide to mounting pressed plants. Meet in the herbarium on the first floor of Spencer Hall. The main entrance is across from DuPont Library and there is parking behind the library.

Botanical Illustration, Spencer Hall, room 173, Saturday, Feb. 9, 9:30 a.m.–noon, with Mary Priestley. Very little drawing is involved in this easy technique. Participants will photocopy then trace a herbarium specimen of their choice, and use information from published sources to modify and enhance the image before transferring it to acid-free paper and going over it with ink and adding optional color. Space is limited. Email <mpriestley0150@gmail.com> with questions or to reserve a space and so Mary can have the materials ready for each participant.

Winter Trees, St. Mary's Sewanee, Sunday, March 3, 2 p.m., with Yolande Gottfried. Lovely large trees are silhouetted against the sky on the campus of St. Mary's Sewanee, giving us a great opportunity to observe branching, twigs, tree shape, bark and more before the leaves emerge. Meet in the main parking area for this easy one-hour stroll. See <<https://www.stmaryssewanee.org>> for directions.

Early Spring Wildflowers, Shakerag Hollow, Sunday, March 17, 1:30 p.m., with Yolande Gottfried. It's St. Patrick's Day, a good time to look for early "green" in Shakerag Hollow. If you don't get out about now you might miss the beginning of the big show—spring ephemerals bloom early and fade fast. Meet at Green's View for this moderate-to-strenuous 2-mile walk that may include a steep rocky section of the trail.

Nature Journaling. A group meets for nature journaling Thursday from 9-11 a.m. Bring an unlined journal (or a few sheets of unlined paper) and a pen or pencil. No experience needed. The group meets in Spencer room 173. For more information email <mpriestley0150@gmail.com>.

Wear appropriate shoes on all of these walks. Risks involved in hiking include physical exertion, rough terrain, forces of nature, and other hazards not present in everyday life. Picking flowers and digging plants are prohibited in all of the above-mentioned natural areas.

For more information on these or other Sewanee Herbarium events, call Yolande Gottfried at the Herbarium (931) 598-3346, or by email at <ygottrfi@sewanee.edu>.



Maria



Daisy

Pets of the Week

Meet Maria & Daisy

Maria is a two-year-old beautiful black and white mixed breed dog. She is very friendly and loves everyone she comes into contact with. Maria is a bundle of energy when she first meets you, but can also be a big couch potato that loves to snuggle. Maria gets along great with other dogs her size that have equal amounts of energy, but may not be well suited for a family with small children at this time. Due to her high energy level, she needs more training before she can be fully trusted around a small child. We think Maria will be a loyal, loving companion to the right owner, offering plenty of companionship and adventure. Maria is fully vaccinated and spayed.

Daisy is a nine-month-old Torbie kitten with a lot of love to give. Daisy loves to be the center of attention, and loves to be petted. Daisy prefers to stay inside and watch outside from a window instead of going out to explore the outdoor patio, so we think she will make a great indoor cat. Daisy has been with us since September, and she has proven to get along with all the cats and kittens very well. Being nine months old, she is starting to lose some of the immaturity and antics of a kitten and has blossomed into a well-behaved teenager. Daisy would love to grow into adulthood in a loving home where she can come into her own and become an integral part of a loving family. Daisy is fully vetted and spayed.

Animal Harbor offers substantial adoption fee discounts for seniors and veterans. Pets adopted from Animal Harbor qualify for a free post-adoption wellness exam by local veterinarians.

Animal Harbor is located at 56 Nor-Nan Rd., off AEDC Road, in Winchester. Call Animal Harbor at 962-4472 for information and check out the other pets at <www.animalharbor.org>. Please help Animal Harbor continue to save abandoned pets by sending your donations to Animal Harbor, P.O. Box 187, Winchester, TN 37398.

Come Enjoy The Mountain's
Best Gourmet Breakfast,
8 to 10 Each Morning,
and Saturday Wine Social,
4 to 7 p.m., in Tallulah's
Wine Lounge



Tallulah's
Wine Lounge

(931) 924-3869 ~ www.monteagleinn.com ~ 204 West Main St.



MOUNTAIN
GOAT TRAIL

SHARE the TRAIL

Rule #2

Stay to the right, pass on the left. Cyclists alert pedestrians when passing: say "on your left."

WALK • RUN • CYCLE
TOGETHER

mountaingoattrail.org

WEATHER

DAY	DATE	HI	LO
Mon	Jan 14	33	28
Tue	Jan 15	30	26
Wed	Jan 16	46	34
Thu	Jan 17	46	43
Fri	Jan 18	50	45
Sat	Jan 19	56	19
Sun	Jan 20	26	12

Week's Stats:

Avg max temp =	41
Avg min temp =	30
Avg temp =	35
Precipitation =	2.62"

Reported by Sandy Gilliam
Domain Ranger

Like the
Messenger?
Let us know on
Facebook!

Classifieds

ART

the **ARTISAN** DEPOT
Gallery & Gifts
NOW JURYING FOR FINE CRAFTS
204 E. Cumberland St., Cowan
Open Thurs-Sun • 931-308-4130

COUNSELING

Spirituality for Recovery
pre-interpretation
archetype for sustained healing
for information or appointments:
budevandyke@gmail.com
Bude Van Dyke, D. Min

A PLACE OF HOPE: Behavioral Health. Alcohol/Drug, Family, Individual. (931) 924-0042 Monteagle Office; (931) 723-7121 Manchester Office. Email <williamkerstetter522@gmail.com>.

DAVID M. BURNETT
LADAC II, NCAC I, QCS
ADDICTIONS & CODEPENDENCY COUNSELOR
DAVIDM.BURNETT1@GMAIL.COM
PHONE: 423-280-0756

EMPLOYMENT

JOSEPH'S REMODELING: now hiring for two positions in the Sewanee and Monteagle area. 1) Project Leader 2) Customer Representative. Both positions require a minimum of 3 years of experience in construction. We offer full time, permanent work rain or shine with competitive wages and benefits. We are a TN Drug Free Workplace. Candidates must be tobacco and vape free. Please only qualified individuals apply. Contact Joseph at (931) 924-5565, or email at <joseph@josephsremodelingsolutions.com>.

ENGINE REPAIR

SARGENT'S SMALL ENGINES: Repairs to All Brands of Equipment: Lawn mowers (riding or push), String trimmers, Chainsaws, Chainsaw sharpening. New saw chains. Pickup and Delivery Available. (931) 212-2585, (931) 592-6536.

FLORIST

Walk-In Cooler Filled with Flowers!
Monteagle Florist
333 West Main Street, Monteagle
(931) 924-3292

FOR SALE

TWO BEAGLES FOR SALE: Nine months old, spayed, good hunters. Call (931) 592-2629.

HOMES FOR RENT/SALE

FOR RENT. AVAILABLE NOW: Very nice 2BR/2BA coach house in Sewanee. Four miles from campus. Fully furnished. All utilities included. C/H/A. W/D. WiFi. Satellite TV/ DVR. \$1,100/mo. Contact University Realty, (931) 598-9244, or Ed Hawkins, <edhawkins@bellsouth.net>.

FOR RENT WITH OPTION TO PURCHASE: 4BR/2BA home on 8 private acres, Deepwoods, behind SAS. All appliances, C/H/A, private, quiet, yet close to SAS. Four miles from Sewanee. Magnificent bluff view. Call (931) 212-0447 days.

INSIDE YARD SALE

MIDWAY MARKET: Coca-Cola collectibles, antique furniture pieces, children's/adults' apparel, movies/games and more. Great prices. Open Friday/Saturday, 8 a.m.-??, 969 Midway Rd., Sewanee. (931) 598-5614.

LAND FOR SALE

LOST COVE BLUFF LOTS
www.myspoint.net
931-703-0558

LAWN CARE

CHAD'S LAWN & LANDSCAPING
-FREE ESTIMATES-
* Lawn care & Design (Mulch & Planting)
ALSO: * Tree Trimming & Removal
* Pressure Washing * Road Grading
* Stone Patio/Fireplace * Garden Tilling
* Leaf Pickup & Blowing
(931) 308-5059

EAGLE LANDSCAPING & LAWN MAINTENANCE CO.
Now Offering Specials for the WINTER!
We offer lawn maintenance, landscaping, hedge/tree trimming & more!
Please call for your free estimate
(931) 598-0761 or (931) 636-0383

LONG'S LAWN SERVICE
• landscaping & lawn care
• leaf removal • mulch
Local references available.
Jayson Long
(931) 924-LAWN (5296)

LOCAL SERVICES

King's Tree Service
Topping, trimming, bluff/lot clearing, stump grinding and more!
Bucket truck or climbing
Free wood chips with job
Will beat any quoted price!
Satisfaction guaranteed!!
—Fully licensed and insured—
kingstreeservice.com
Call (931) 598-9004—Isaac King

Needle & Thread
*Alterations *Repairs *Cushions & Pillows
For a reasonable price contact
Shirley Mooney
161 Kentucky Ave.
Sewanee, TN 37375
(931) 598-0766
Monday–Wednesday, 9 a.m. to 4 p.m.

Lyn Hutchinson PHOTOGRAPHY
lynhutchinson.smugmug.com

Sewanee COMMUNITY CHEST

Did You Know?

The Sewanee Community Chest raises money annually to support basic needs in the community such as books, food, elder care, animal care, recreational space, children's program and more.

Donate today!

Visit www.sewaneecivic.org for more information.
SEWANEE COMMUNITY CHEST
PO BOX 99, SEWANEE TN 37375

LOCAL SERVICES

Eagle Military ANTIQUES
Buyers of Civil War, WW1, WW2 military weapons, uniforms, equipment, and all interesting antiques.
Call Colonel (ret.) Ron Bailey, 931-636-1794

SEWANEE-MONTEAGLE AREA MOVERS: We are Professional • Courteous • Experienced. Call (423) 443-6082 or email <mws818@mocs.utc.edu>.

MASSAGE
Regina Rourk Childress
Licensed Massage Therapist
www.reginarourk.com
~ GIFT CERTIFICATES ~
(931) 636-4806

Lakeside Collision
“Done Right, the First Time”
103 Mabey Ave., Monteagle
Ph: 931.924.3316 | Cell: 931.235.3316
lakesidecollision00@gmail.com

Love Doesn't Have to Hurt. Help is Free.
Call the
Haven of Hope
Victim Hotline
1-800-435-7739
Domestic violence is darkness, hope the dawn of new life.

YOUNG LIVING
ESSENTIAL OILS
Independent Distributor
Ray and April Minkler
styraco@blomand.net, aprilminkler@blomand.net
931-592-2444 931-434-6206
For over 8,700 testimonials see
www.oil-testimonials.com/1860419

LOCAL SERVICES

CHARLEY WATKINS PHOTOGRAPHER
Sewanee, TN
(931) 598-9257
<http://www.photowatkins.com>

GUTTERS CLEANED:
Reasonable rates. Call Sandy Gilliam, (931) 691-4435

MARK'S HOME REPAIR
KITCHEN AND BATH REMODELING
Insured. Decks, Roofing, Electrical, Plumbing, Drywall, Tile & Hardwood Floors, Outbuildings, Pressure Washing.
MARK GREEN, owner
931-636-4555 | mdgreen41@gmail.com

WATER SOLUTIONS
Joseph Sumpter
Owner/Licensed Residential Contractor
Specializing in drainage and rainwater collection systems
598-5565
www.josephsremodelingsolutions.com

WOODWORKING

The Gnarled Oak
Antique furniture refinishing
(931) 592-9680
Bill Childers, Prop

CALL US! • 598-9949
Classified Line Ad Rates:
\$3.25 first 15 words,
10 cents each addl. word
You can charge it!
(\$10 minimum)

franklincotn.us/departments/solid_waste/index.html



Aluminum
Clean Foil
Pie Pans

Plastic Containers #1-#7
NO Styrofoam
NO Plastic Bags
NO Packaging Wrap
NO BLACK or CLEAR Food Containers
NO Clam Shells
NO Buckets or Hard Plastics (coolers, gas jugs, etc.)
NO Toys

NO Garden Hose
NO PVC Pipe
NO Vinyl Siding
NO Oil or Pesticide Bottles
NO BLACK or COLORED Flower Pots/ Plant Flats

Newspapers, Magazines, Catalogs, Phone Books

Metal Cans
Food Cans, etc.

Cardboard
Packing Boxes, Food Boxes (Cereal and Cracker Boxes)
Paper Office/Mixed Paper
White Ledger Paper
Colored Paper
Notebook Paper
Stationery
Junk Mail
Hard/Paperback Books

The Convenience Center for household garbage, trash and recycling is located on Missouri Ave. Its current hours are: Monday, noon–5 p.m.; Tuesday through Friday, 2–5 p.m.; Saturday, 8 a.m.–4 p.m.; Closed Sunday. Closed on national holidays. There are blue recycling bins for metal (tin, appliances, etc.), newspapers/magazines, some plastic containers #1-#7, cardboard and aluminum cans. Glass recycling is on Kennerly Ave. behind Facilities Management. For more information <http://www.franklincotn.us/departments/solid_waste/index.html>.

**If it matters to you,
it matters to the
community.**



Share your good news with more people weekly!
call: (931) 598-9949
email: news@sewaneemessenger.com
view: www.sewaneemessenger.com



BARDTOVERSE

by Phoebe Bates

Every year
everything
I have ever learned

in my lifetime
leads back to this: the fires
and the black river of loss
whose other side

is salvation
whose meaning
none of us will ever know.
To live in this world

you must be able
to do three things:
to love what is mortal;
to hold it

against your bones knowing
your own life depends on it;
and, when the time comes to let it go
to let it go.

Excerpt from *In Blackwater Woods*,
by Mary Oliver, 9/10/35-11/17/19

Michael A. Barry LAND SURVEYING & FORESTRY

- ★ ALL TYPES OF LAND SURVEYS
- ★ FORESTRY CONSULTING

(931) 598-0314 | (931) 308-2512



TOMMY C. CAMPBELL

FOR YOUR IMPROVEMENTS

Call (931) 592-2687

Free Estimates • No Job Too Small!

DRIVEWAY WORK • GRAVEL HAULING • DOZER & BACKHOE

plus Land Clearing • Concrete Work • Water Lines • Garage
Slabs • Sidewalks • Porches & Decks • Topsoil & Fill Dirt
Septic Tanks & Field Lines

Did you know we specialize in
keeping your home dry
with customized drainage systems and
whole house dehumidification?



Custom home remodeling begins with...

**Joseph's Remodeling
Solutions**
A Division of Sungrazer Solutions, LLC

Taking Quality to the Next Level
Licensed - Insured - Green Certified

931-598-5565

joseph@josephsremodelingsolutions.com
www.josephsremodelingsolutions.com

Community Calendar

Today, Friday, Feb. 1

Sewanee Women's Club lunch reservations deadline, email <g.ruppemelnyk2015@gmail.com> or call (504) 858-5221

Sewanee Civic Association dinner reservations deadline, email <sewaneecivic@gmail.com>

- 8:30 a.m. Deep Stretch Yoga, Darrylann, Comm Ctr.
- 9 a.m. CAC office open, until 11 a.m.
- 10 a.m. Game day, Senior Ctr.
- Noon CAC Community meal, (free), St. Mark's, Otey
- Noon Spinal Spa, Kim, Fowler Ctr.
- 4:30 p.m. Art talk, reception, Adams, Carlos Gallery, 105 Kennerly Rd.
- 5:30 p.m. Opening reception, Priestley, Frame Gallery, 12569 Sewanee Hwy., until 7:30 p.m.
- 7:30 p.m. Dancewise, Proctor Hill Theatre
- 7:30 p.m. Movie, "Fantastic Beasts 2," SUT

Saturday, Feb. 2 • Groundhog Day

- 8:30 a.m. Yoga, Richard, Comm Ctr., until 9:45 a.m.
- 9 a.m. Cowan/Sewanee Little League Sign-ups, Cowan Elem., until noon (last day; no late sign-ups this year)
- 9 a.m. MGT 5K Parkrun, Pearl's parking lot, register at <parkrun.us/register>
- 9:30 a.m. Herbarium Tour/Mount-a-thon, Spencer Hall first floor, until 11:30 a.m.
- 9:30 a.m. Hospitality Shop open, until noon
- 2 p.m. Dancewise, Proctor Hill Theatre
- 5 p.m. "Art Goes Pop" reception, Artisan Depot
- 7:30 p.m. Dancewise, Proctor Hill Theatre
- 7:30 p.m. Movie, "Fantastic Beasts 2," SUT

Sunday, Feb. 3

- 2 p.m. Dancewise, Proctor Hill Theatre
- 2 p.m. Wings of Hope widows' support group, Hearth Rm., Winchester Cumberland Presbyterian Church, 200 2nd Ave., Winchester
- 2 p.m. Knitting circle, Mooney's, until 4 p.m.
- 4 p.m. Hatha Yoga, Helen, Comm Ctr.
- 7:30 p.m. Movie, "Fantastic Beasts 2," SUT

Monday, Feb. 4

- 8 a.m. FCBOE Social Studies textbook open viewing, 215 S. College St., Winchester, until 4 p.m., through Friday, Feb. 15
- 8:30 a.m. Walk with Ease, F@H, Fowler Ctr., 598-0303 to register
- 9 a.m. Coffee with the Coach, Karine Gordy and Emily Cavender, Blue Chair Tavern
- 9 a.m. Pilates, intermediate, Kim, Fowler Ctr.
- 10:30 a.m. Chair Exercise, Ruth, Senior Ctr.
- 3 p.m. Ralston Room, Mendelssohn's Midsummer Night's Dream, until 4 p.m.
- 4 p.m. Ralston Room, Greta van Fleet's Anthem of the Peaceful Army, until 5 p.m.
- 4:30 p.m. Babson Business talk, Deimler, Torian Rm, duPont, + reception
- 5 p.m. Pilates, Golfers, Kim, Fowler Ctr.
- 5:30 p.m. Yoga for Strength/Healing, Pippa, Comm Ctr.
- 6 p.m. Karate, youth, Legion Hall; adults, 7 p.m.
- 6 p.m. Ralston Room, Rolling Stones' Exile on Main Street, until 7 p.m.
- 6:30 p.m. Sewanee Chorale, to participate email <TheSewaneeChorale@gmail.com>
- 8 p.m. Ralston Room, Otis Redding, until 9 p.m.

Tuesday, Feb. 5

Lease Agenda items due

- 8 a.m. Godly Play/PMO, Otey, until 10:30 a.m. <oteyformation@gmail.com>
- 8:30 a.m. Deep Stretch Yoga, Darrylann, Comm Ctr.
- 9 a.m. CAC office open, until 11 a.m.
- 9 a.m. Pilates, beginners, Kim, Fowler Ctr.
- 10 a.m. Village Update, Gladu, Blue Chair Tavern
- 10:30 a.m. Bingo, Senior Center
- Noon Pilates, intermediate, Kim, Fowler Ctr.
- 1 p.m. Rooted Here annual meeting, Comm Ctr.
- 1:30 p.m. F@H/EHH balance/fall prevention talk, Hartman, Senior Ctr.
- 4 p.m. Ralston Room, 80s Hits, until 5 p.m.
- 5:30 p.m. Village Update, Gladu, Blue Chair Tavern
- 5:30 p.m. Yoga, Darrylann, St. Mary's Sewanee
- 6 p.m. Ralston Room, classic rock, until 7 p.m.
- 6 p.m. Tracy Acoustic Jam, Water Bldg, Tracy
- 6:30 p.m. Ballroom dance, beginners, Comm Ctr.

Wednesday, Feb. 6

- 8:30 a.m. F@H Walk with Ease, Fowler Ctr., 598-0303 to register
- 9 a.m. CAC office open, until 11 a.m.
- 9 a.m. Pilates, intermediate, Kim, Fowler Ctr.
- 9:30 a.m. STLS, Gallagher, FC Country Club

- 10 a.m. Senior Writers' Group, 212 Sherwood Rd.
- 10:30 a.m. Chair Exercise, Ruth, Senior Ctr.
- 11:30 a.m. EQB, St. Mary's Sewanee; lunch at noon
- 5 p.m. Pilates, Tennis, Kim, Fowler Ctr.
- 5 p.m. Ralston Room, Mendelssohn's Octet in E-flat Major, until 6 p.m.
- 5:30 p.m. Hatha Yoga, Helen, Comm Ctr.
- 6 p.m. DivorceCare, <www.divorcecare.org> for more info/to register
- 6 p.m. Ralston Room, Boss Nova featuring Jorge Ben, until 7 p.m.
- 6:30 p.m. Catechumenate, dinner, Women's Center
- 7 p.m. Ralston Room, "Who's That Lady," featuring StereoLab, until 8 p.m.
- 7:30 p.m. Movie, "Popstar: Never Stop Never Stopping," Cinema Guild, (free), SUT

Thursday, Feb. 7

- 7 a.m. Qi Gong on the Bluff, Wall, St. Mary's Sewanee
- 8 a.m. Monteagle-Sewanee Rotary, Sewanee Inn
- 9 a.m. CAC office open, until 11 a.m.
- 9 a.m. Nature Journaling, Spencer Rm 173
- 9 a.m. Pilates, beginners, Kim, Fowler Ctr.
- 10:30 a.m. Paths of Grace program (1 of 4), Otey Parish Hall, until noon
- Noon Academy for Lifelong Learning, Tiernan, Lower Cravens Hall, Kentucky Avenue
- Noon Pilates, intermediate, Kim, Fowler Ctr.
- 1 p.m. Folks@Home caregiver's group, St. Mark's, Otey
- 1 p.m. Women's healing circle, Anneli, Comm Ctr., until 2:30 p.m.
- 2 p.m. Knitting circle, Mooney's, until 4 p.m.
- 3:30 p.m. Tutoring, K-5, St. James, until 5 p.m.
- 4:30 p.m. Leadership talk, Thompson, McGriff
- 5:30 p.m. "Sewanee's Historic Houses" talk, reception, Lytle Room, UoS Archives, 81 Alabama Ave.
- 5:30 p.m. Sewanee Civic Association, Coffey, St. Mark's Hall, Otey
- 5:45 p.m. Zumba, Rosas-Jaimes, SAS Theatre, \$7
- 6 p.m. Karate, youth, Legion Hall; adults, 7 p.m.
- 6 p.m. Ralston Room, Simon & Garfunkel "Bridge Over Troubled Water," until 7 p.m.
- 7:30 p.m. Movie, "A Star is Born," SUT

Friday, Feb. 8

- 8:30 a.m. Deep Stretch Yoga, Darrylann, Comm Ctr.
- 9 a.m. CAC office open, until 11 a.m.
- 10 a.m. Game day, Senior Ctr.
- Noon Spinal Spa, Kim, Fowler Ctr.
- 4 p.m. Ralston Room, Mendelssohn's Symphony No. 2 (Hymn of Praise), until 5 p.m.
- 5 p.m. Ralston Room, Kamasi Washington and John Coltrane, until 6 p.m.
- 7:30 p.m. Movie, "A Star is Born," SUT

Local 12-Step Meetings

Friday

- 7 p.m. AA, open, Christ Church, Tracy City

Saturday

- 7:30 p.m. NA, open, Decherd United Methodist
- 7:30 p.m. AA, open, Claiborne Parish House, Otey

Sunday

- 6:30 p.m. AA, open, Holy Comforter, Monteagle

Monday

- 5 p.m. Women's 12-step, Brooks Hall, Otey
- 7 p.m. AA, open, Christ Church, Tracy City

Tuesday

- 7 p.m. AA, open, First Baptist, Altamont
- 7:30 p.m. AA, open, Claiborne Parish House, Otey

Wednesday

- 10 a.m. AA, closed, Clifftops, (931) 924-3493
- 7 p.m. NA, open, Decherd United Methodist
- 7:30 p.m. AA, open, Holy Comforter, Monteagle

Thursday

- 7 p.m. Al-Anon, First UMC, Winchester

New to the Mountain?

Read what you have been missing!
<sewaneemessenger.com>