

Sewanee Basketball Off to a Great Start

For the first time since the 1996–97 season, the Sewanee men's basketball team has started its conference season with a perfect 4-0 start. The Tigers are now 4-0 in Southern Athletic Association (SAA) play with a convincing 77-52 victory over rival Centre College at home on Jan. 16.

The 1996–97 team finished 19-7 overall and 11-3 in conference play.

This season Sewanee is now 11-4 overall after remaining perfect in SAA play. The win over Centre is the first time since the 1997–98 season that the Tigers have swept Centre twice in a season. The visiting Colonels fell to 10-5 overall and 2-2 in SAA play.

Sewanee wasted little time building its lead in the game on Jan. 16. After Centre took an early 6-2 advantage, the Tigers answered back with a 13-3 run over the next seven minutes.

Eventually, the Tigers took a 12 advantage, when Sewanee closed the first half on an 11-5 spurt. A big reason for the Tigers' early success was a combination of great outside shooting and strong defense. The Tigers made six threes in the first half on just 13 attempts. Defensively, Sewanee limited Centre to a 34.8 field goal percentage and six turnovers in the first half.

After the intermission, Sewanee kept rolling. The Tigers outscored Centre 44-31 in the final 20 minutes, which allowed Sewanee to build its largest lead of the game, 27 points, when freshman Chris Kuelling hit a corner three.

Overall, Sewanee made an impressive 49.0 percent of its shots. The Tigers also outrebounded Centre, 31-27.

Individually, Sewanee's balanced offense was led by junior Brody Stone and senior Seth Brown. Both players finished with 12 points. They were joined by freshman Cody Jones and junior Clay Born, each with nine points. As a team, 11 of the Tigers' 14 players recorded at least two points.

Anima Baroque at SAS

St. Andrew's-Sewanee School will host Anima Baroque Music Ensemble at 7 p.m., Friday, Jan. 29, in McCrory Hall for the Performing Arts on the SAS campus. The concert is free and open to the public. Anima will present "Postcards from Orpheus."

This is an unusual opportunity to see Anima Baroque perform in this region, as most of their concerts take place in New York City. The musicians specialize in music for small ensemble and voice from the baroque and late Renaissance era, played on period instruments.

The group features soprano Beth Anne Hatton, baroque violinist Vita Wallace, viola da gamba and lironi player Motomi Igarashi and baroque harpist Christa Patton. Anima's performances are fresh, sincere, joyous and powerful, and connect today's listeners with the music of 400 years ago.



Sewanee senior Seth Brown (right) puts up a shot in the recent win over Centre College. Photo by Lyn Hutchinson

Free Tax Assistance for Elderly & Low-Income

Area residents who make less than \$54,000 or who are disabled or elderly will have the opportunity to get free Internal Revenue Service-approved assistance with preparing and filing their federal income tax returns this year, thanks to a program sponsored by the Babson Center for Global Commerce at the University of the South. Residents of Franklin, Grundy and Marion counties are all eligible for the free service.

The Volunteer Income Tax Assistance (VITA) program will be available on a first-come, first-served basis at Holy Comforter Episcopal Church

in Monteagle and Otey Parish Church in Sewanee.

VITA will be available 4–7 p.m., Monday, Jan. 25, at the Community Action Committee at Otey Parish in Sewanee. Additional hours in Sewanee will be announced at a later date.

Regular hours at Holy Comforter begin Jan. 31 and will be noon–5 p.m. on Sundays, and 5–7 p.m. on Tuesdays.

The VITA program will not operate on March 13, 15 or 20. The deadline for filing income tax returns is April 15.

The VITA volunteers, who include

(Continued on page 5)

Lecture on Rebranding by Alumna on Wednesday

Martha (Marty) Boal Willis, C'82, the chief marketing officer for Oppenheimer Funds, will present a lecture on "Going Against the Herd: How We Defied Conventions by Defining Our Brand," at 4:30 p.m., Wednesday, Jan. 27, in Gailor Auditorium. A reception will follow the talk. Willis is the Babson Center for Global Commerce's Graham Executive-in-Residence for the 2016 Easter semester.

Willis' talk will focus on her firm's 2015 launch of a major rebranding effort that urges investors to focus on long-term optimism other than short-term market negativity. The campaign, called "Invest in a Beautiful World," stresses the value of long-term global investment.

Willis has a long history of support for the University, including a six-year term on the board of regents, serving as chair from 2009 to 2011. She also chaired the University's investment committee from 2004 to 2009. Willis and her husband, Bill, are the parents of three children; one, Caroline Willis, also attended Sewanee and graduated in 2011. The Graham Executive Residencies are made possible by a generous gift from Diane and the late Henry H. Graham Jr. For more information go to <www.sewanee.edu>.



Marty Willis

STEM Names Lamborn as New Vicar

The Southeast Tennessee Episcopal Ministry (STEM) recently announced that the Rev. Amy Bentley Lamborn has accepted the call to be vicar of STEM. She began her work on Jan. 1. STEM was founded in 2002 and now includes Epiphany, Sherwood; Christ Church, Alto; Holy Comforter, Monteagle; Christ Church, Tracy City; and Trinity, Winchester.



Amy Lamborn

A 1996 graduate of the School of Theology at Sewanee, Lamborn returned to Sewanee when her husband, Rob, accepted the call to be rector at Otey Parish. She earned her bachelor's degree in English literature from Union University; she earned her Ph.D. in psychiatry and religion at the Union Theological Seminary in 2009. The Lamborns have a 12 year-old daughter, Caroline, who is a seventh-grader at St. Andrew's-Sewanee.

"I am so excited about serving as vicar of STEM," Lamborn said. "The people in each of the individual churches are committed to their communities of faith. They are resilient folks, and so many of them are eager to deepen the life of faith and spiritual practice."

"Together, the STEM churches are poised to work collaboratively and to join in creative ways with other Episcopal institutions and ministries around the Cumberland Plateau. I look forward to discerning with them the ways we are called to be God's people in this place and time." For more information or to contact Lamborn, email <stemvicar@gmail.com>.

Health Insurance Enrollment Deadline Nears

Sunday, Jan. 31 is the final deadline for Tennesseans to enroll in coverage through the Health Insurance Marketplace during the third Affordable Care Act open enrollment period. With just nine days left, the clock is ticking, and Tennesseans should act now to make sure they have time to shop around, consider their options and enroll in the plan that best fits their needs and budget.

"So far, nearly 233,000 Tennesseans have enrolled in coverage during this open enrollment period—but there are still many who stand to benefit and need to take action before January 31," said Enroll America Tennessee State Director Jacob Flowers. "Last year we saw an unprecedented surge of interest leading up to the final deadline, and we expect to see the same this year as we approach the end of the month. That's why we are encouraging people to start the process now to make sure there's plenty of time for them to find the best plan for their family."

During this open enrollment period, there are new plans and new prices available on the Health Insurance Marketplace, so all Tennesseans

should explore the options available to them. All Marketplace health plans are required to cover the basics—from preventive care, emergency services, prescriptions and more. And quality protection comes at an affordable price for most Tennesseans, thanks to the financial assistance available to lower the cost of plans. In fact, 84% of the more than 233,000 in Tennessee who have signed up so far are receiving financial help.

In order to help Tennesseans explore their options, there are a variety of resources available so that consumers can be confident that they are choosing the best plan for them. For instance, there is free, local in-person help available across the state. To find a certified assistant who can sit down one-on-one and answer questions about coverage and benefits, go to <www.GetCoveredTenn.org> or call (844) 644-5443 to schedule an appointment at a convenient time and location.

Get Covered America also has a free, easy-to-use digital tool called the Get Covered Plan Explorer, which

(Continued on page 5)

P.O. Box 296
Sewanee, TN 37375

Letters

MOUNTAIN TOP WRESTLING To the Editor:

The 35th annual St. Andrew's-Sewanee Mountain Top Wrestling Invitational Tournament was held on Jan. 16 with 15 D-I and D-II wrestling teams attending. A special girls-only wrestling division was added; seven schools participated, with several state champions going head-to-head. A packed gym kept the many volunteers busy from sun-up till sunset. My special thanks goes to these organizers: Brian Masters, tournament director; Harrison Camp, floor director; Ty Burnette, computer programming, brackets and results; Kathy Lindlau and Beth Wiley, hospitality room; Stephanie Layne, bookkeeping; Margot Burns and St. Andrews-Sewanee School, hosts.

This could not happen without the leadership taken in all these areas with countless volunteered hours. Many thanks.

Dan Barry, Sewanee ■

A DIFFERENT OPINION To the Editor:

Faye Walter is wrong in her claim [Letter to the Editor, Jan. 15, 2016, issue of the Messenger] that Citizens United allows unlimited donations to candidates, just as Barack Obama was in error claiming in his 2010 State of the Union Address that the ruling allowed foreign contributions (shake your head no, Justice Alito!).

This ruling concerns messaging by outside parties for or against candidates and is a function of the First Amendment. She failed to mention unions in her list of power-players influencing elections. Public and private unions have donated hundreds of millions of dollars in just the last 15 years, overwhelmingly to Democrats.



Don Huber (right) gowns his daughter Georgette at the Jan. 11 opening Convocation at the University. Photo by Lyn Hutchinson

Her observation: "Supreme Court's Republican-majority" is a canard. Just look at the Obergefell (gay marriage) ruling that spurred the president to illuminate the White House with rainbow colors.

People without voter IDs have all year to acquire the free identification available from their state. To allow someone to vote without proof of citizenship is foolish, unless you feel it will influence the election in favor of your party.

I prefer no party affiliation on ballots. If a citizen is not familiar with the candidates or issues, perhaps they don't need to vote. No indication of (D) for Democrat or (R) for Republican would also decrease the desire to bus people to the polls in expectation of a party receiving their votes.

These views do not reflect those of my family members living outside of Franklin County.

Bill Kershner, Sewanee ■

Palfy Celebrates 20th Anniversary

Chiropractic physician Dr. Victor Palfy is celebrating 20 years in Monteagle at his clinic, 21st Century Chiropractic, located at 16 East Main St. Palfy has a total of 25 years experience as a chiropractor. He is licensed by the National Board of Chiropractic Examiners and he holds a license to practice in Tennessee and Georgia. In celebration of the 20th anniversary and in appreciation for the Mountain community, Palfy is offering a special discount for appointments between now and Feb. 29. For more information call (931) 924-3474 or go online to <www.palfychiro.com>.

Home Renovations and Improvements
"Honey-Do List for 2016" x
Joseph's Remodeling Solutions =
Happy Spouse



Custom home remodeling begins with...

Joseph's Remodeling Solutions
A Division of Sumpter Solutions, LLC

Taking Quality to the Next Level
Licensed - Insured - Green Certified

931-598-5565

joseph@josephsremodelingsolutions.com
www.josephsremodelingsolutions.com

THE SEWANEE MOUNTAIN MESSENGER

418 St. Mary's Ln.
P.O. Box 296
Sewanee, Tennessee 37375
Phone (931) 598-9949
Fax (931) 598-9685



Email news@sewaneemessenger.com
www.sewaneemessenger.com

Laura L. Willis, editor/publisher
Janet B. Graham, advertising director/publisher
April H. Minkler, office manager
Ray Minkler, circulation manager
Leslie Lytle, staff writer
Kevin Cummings, staff writer/sports editor
Sandra Gabrielle, proofreader
Geraldine H. Piccard, editor/publisher emerita

Contributors
Phoebe Bates
John Shackelford
John Bordley
K.G. Beavers
Virginia Craighill
Patrick Dean
Buck Gorrell
Margaret Stephens
Peter Trenchi
Francis Walter
Pat Wiser

Published as a public service to the Sewanee community. 3,700 copies are printed on Fridays, 46 times a year, and distributed to 26 Sewanee-area locations for pickup free of charge.

This publication is made possible by the patronage of our advertisers and by contributions from the University of the South (print production) and the Sewanee Community Chest.

SUBSCRIPTIONS \$75 first class.

All material in the Sewanee Mountain Messenger and on its website are copyrighted and may not be published or redistributed without written permission.

Online Survey Seeks Opinions on Sewanee Water

As part of the ongoing constructed wetlands research collaborative between the University of the South, the University of Georgia and Sewanee Utility District, Sewanee residents are invited to take an online survey about water awareness.

The survey has a new, shortened URL: <www.tinyurl.com/z3dpllw> and will be open until Monday, Jan. 25.

The intent of this survey, according to Sewanee biologist Deborah McGrath, is to help the collaborators

better understand what the community knows about water issues, and how they can do a better job of communicating and involving the public in local water issues. The constructed wetland research is aimed at understanding the effectiveness of wetland processes in removing contaminants, such as pharmaceuticals.

As part of the research project, McGrath said that the project will have focus groups with citizens sometime during the spring.

Letters to the Editor Policy

Letters to the editor are welcome at the Sewanee Mountain Messenger and are a vital part of our community's conversation. Letters need to be no longer than 250 words and may be edited for space and clarity. We make exceptions from time to time, but these are our general guidelines.

Letters and/or their author must have some relationship to our community. We do not accept letters on national topics from individuals who live outside our circulation area. Please include your name, address and a day-



time telephone number with your letter. You may mail it to us at Sewanee Mountain Messenger, P.O. Box 296, Sewanee, TN 37375, come by our office, 418 St. Mary's Ln., or send your email to <news@sewaneemessenger.com>.—LW

J & J GARAGE

COMPLETE AUTO REPAIR

- Import & Domestic
- Computerized 4-Wheel Alignments
- Shocks & Struts • Tune-ups •
- Brakes
- Our Work is Guaranteed.
- OVER 26 YEARS EXPERIENCE.

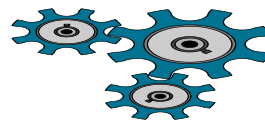

Jerry Nunley
Owner

598-5470 Hwy 41-A between Sewanee & Monteagle • Monday-Friday 7:30-5:30

BARBARA HUGHES' STUDIO SALE

9:30 a.m. to 5 p.m.

Saturday, Jan. 23

41 Sherwood Rd., Sewanee

(third left just after the turn on Highway 56)

SCULPTURE, PAINTING
ART SUPPLIES, FURNITURE
AND MUCH MORE

Questions? Email bhughes@sewanee.edu

Serving Where Called

Please keep the following individuals, their families and all those who are serving our country in your thoughts and prayers:

Michael Evan Brown
Mary Cameron Buck
Lisa Coker
Jennifer Lynn Cottrell
James Gregory Cowan
Nathaniel P. Gallagher
Alex Grayson
Peter Green
Robert S. Lauderdale
Dakota Layne
Byron A. Massengill
Forrest McBee
Andrew Midgett
Alan Moody
Brian Norcross
Christopher Norcross
Lindsey Parsons
Troy (Nick) Sepulveda
J. Wesley Smith
Charles Tate
Tyler Walker
Jeffery Alan Wessel
Nick Worley

If you know of others in our Mountain family who are serving our country, please give their names to American Legion and Auxiliary member Louise Irwin, 598-5864.

MESSENGER DEADLINES and CONTACTS

PHONE: (931) 598-9949
FAX: (931) 598-9685

News & Calendar

Tuesday, 5 p.m.
Laura Willis
news@sewaneemessenger.com

Display Advertising

Monday, 5 p.m.
Janet Graham
ads@sewaneemessenger.com

Classified Advertising

Wednesday, noon
April Minkler
classifieds@sewaneemessenger.com

MESSENGER HOURS

Monday, Tuesday & Wednesday
9 a.m. – 5 p.m.

Thursday — Production Day
9 a.m. until pages are completed
(usually mid-afternoon)

Friday — Circulation Day
Closed

Upcoming Meetings & Events

Coffee with the Coach on Monday

Coffee with the Coach will meet at 9 a.m., Monday, Jan. 25, at the Blue Chair Tavern. The guest will be Dennis Meeks, who will talk about his experiences as a professional baseball scout. Come and enjoy good conversation and free coffee.

Community Council Meeting Canceled

Because no agenda items were submitted, the Sewanee Community Council will not meet on Monday, Jan. 25. For more information contact the provost's office.

Tims Ford Council Meeting Monday

The Tims Ford Council membership meeting will be at 6 p.m., Monday, Jan. 25, in the Franklin County Annex, 839 Dinah Shore Blvd., Winchester. Brad Cochran, a member of the U.S. Coast Guard Auxiliary, will present the program.

New 12-Step Group Forming

Co-Dependents Anonymous (CoDA) is a 12-Step fellowship of men and women whose common purpose is recovery from codependence and the development and maintenance of healthy relationships.

The CoDA meeting in the area meets at 7:30 p.m., Tuesdays, at Holy Comforter Church in Monteagle. For more information call (423) 598-9808. CoDA is a nonprofit organization supported by the voluntary contributions of attending members.

Area Rotary Club Meetings

The Grundy County Rotary Club meets at 11:30 a.m., Tuesdays, at Dutch Maid Bakery in Tracy City.

The Monteagle Sewanee Rotary Club meets 8-9 a.m., Thursdays, at the Sewanee Inn. On Jan. 28, the program will be presented by Leslie Lytle, author of "Chicken Stock" and "Executioner's Doorstep."

Woman's Club Reservations Due by Jan. 29

The Sewanee Woman's Club will meet on Feb. 8 at the DuBose Conference Center in Monteagle, when the speaker will be Robin Gottfried, professor of economics emeritus, who will discuss "Contemplation of Nature and Why It Matters."

Reservations for lunch (\$13.25) are due by Friday, Jan. 29. The November menu will be butternut squash soup, three-cheese quiche, baked tomato and dessert. Reservations can be made by calling Pixie Dozier at 598-5869 or by emailing Marianna Handler at <mariannah@earthlink.net>. Vegetarian meals and child care are available; please request these when making a reservation.

STLS Wine & Spirit Tasting on Jan. 30

The Southern Tennessee Ladies' Society Scholarship Foundation is sponsoring a Wine and Spirit Tasting, 7-9 p.m., Saturday, Jan. 30, at the Franklin County Country Club. Wines will be provided by Stones River Total Beverage in Murfreesboro; rum and liqueurs will be provided by Prichard's Distillery of Kelso; and there will be a selection of local beer.

Ben Ayers will provide the entertainment. Tickets are \$25 in advance and \$30 at the door. For more information call 967-0535 or 703-0570, or email <reply2stls@att.net>. All money raised at this event supports scholarships in Coffee, Franklin, Grundy, Lincoln and Moore counties.

Lifelong Learning Meets on Feb. 11

The Academy for Lifelong Learning will meet at noon, Thursday, Feb. 11, at St. Mary's Sewanee. Bring your iPad or other digital device for this special presentation by Erin Cassell, director of strategic digital infrastructure at the University.

A box lunch may be reserved by calling 598-5342. Lunch choices are mixed greens with balsamic chicken or tropical shrimp salad.

For information call Debbie Kandul at (931) 924-3542.

Mountain T.O.P. Seeks Community Comments

Mountain T.O.P. (Tennessee Outreach Project) of Grundy County is applying for a USDA Housing Preservation grant that would provide funds to do home repair using volunteers.

To qualify for this grant, it is necessary to announce its potential to the area in which it will serve and receive feedback from the community. If you have any comments on whether Mountain T.O.P. should receive this

grant and why, please mail them to P. O. Box 128, Altamont, TN 37301 or drop them off at the camp on old Highway 56 in Cumberland Heights. The deadline for submitting supporting letters is Feb. 5.

Mountain T.O.P. is an interdenominational, nonprofit Christian partnership ministry dedicated to rural life ministry in the Cumberland Mountains of Tennessee.



Rachel Taber-Hamilton

Native Peoples & the Church Lectures

The Rev. Rachel Taber-Hamilton, rector of Trinity Episcopal Church in Everett, Wa., will present two lectures about Native peoples and the Episcopal church: 7 p.m., Wednesday, Jan. 27, and 1 p.m., Thursday, Jan. 28; both will take place in Hamilton Hall's Hargrove Auditorium.

The first lecture will be "An Overview of the History of Native Mission and Relationship of the Episcopal Church in the United States." This presentation will span from the Jamestown settlement to the role, relationship and voice of Native people in the church today.

The second lecture will be on "Cultural Appropriation and the Problem of Romantic Idealization of Native Americans." Since its inception, the United States has had a confused ideological relationship with Native peoples, having decimated Native cultures through war, land appropriation and enforced cultural assimilation.

Being raised in a multicultural and mixed-race heritage of First Nations (Shackan, British Columbia), Pennsylvania Dutch, and Scots-Irish, Taber-Hamilton has had a lifelong passion for cross-cultural communication, preservation of traditional life ways and folk traditions, social diversity and ethnic ministries.

Ordained a priest in 2004, she has served throughout her tenure in the Diocese of Olympia on various councils and committees of the church, including Diocesan Council, the Anti-Racism Committee, the First Nations Committee and Multi-Cultural Ministries. She served for five years on the national Episcopal Church's Executive Council for Indigenous Ministries and recently completed terms as the chair of the standing committee in the Diocese of Olympia and president of the board of directors for Mission to Seafarers in Seattle.

Lobscouse & Spotted Dog Dinner

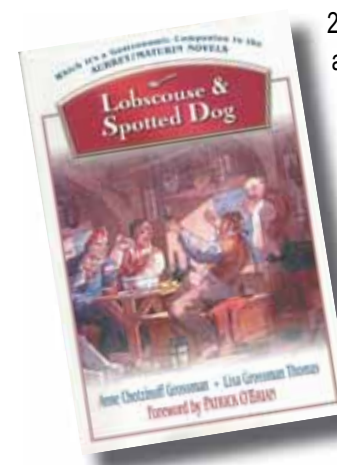

2nd annual dinner in the "Captain's Cabin" at Tea on the Mountain featuring authentic dishes from the Aubrey/Maturin novels.

6 p.m., Saturday, January 23
\$40/person

By Reservation
Limited Seating
Call 931-592-4832



Tea on the Mountain

298 Colyar Street, US 41, Tracy City

Artisan Handwovens by
Ephods & Pomegranates
Glyn & Will Ruppe-Melnyk, Weavers

shawls, table runners, scarves, clergy stoles
www.ephodsandpomegranates.com
610-357-6813
also at Taylor's Mercantile, Sewanee

SHARE YOUR NEWS!

news@sewaneemessenger.com

WOODARD'S
DIAMONDS & DESIGN

Need Extra Cash?
WE BUY GOLD
2013 Your Favorite Jeweler

- ✓ Deal With Tullahoma's most trusted name in jewelry
- ✓ Highest Prices Paid
- ✓ Get 20% MORE Towards Jewelry Purchase
- ✓ FREE Gas Card when you sell us your gold*

* See Store Staff For Details

Jim Woodard
Diamond Hunter

CUSTOM Design Studio
Repairs, too.

Which diamond would you rather have?
YEHUDA \$2999
OTHER \$2999

YEHUDA
The Inventors of Enhanced Natural Diamonds

Northgate Mall • Tullahoma • 454-9383 • woodards.net

piggly wiggly®

Down Home, Down the Street
754 West Main St., Monteagle
(931) 924-3135
8 a.m. to 9 p.m. 7 days a week

Michael A. Barry
LAND SURVEYING & FORESTRY

- ★ ALL TYPES OF LAND SURVEYS
- ★ FORESTRY CONSULTING

(931) 598-0314 | (931) 308-2512

BUG PROBLEMS?

We can help! Call us for a free inspection!

BURL'S TERMITE & PEST CO.

TERMITE—PEST—VAPOR CONTROL
Bonded • Insured • Home-Owned & Operated
105 Ake St., Estill Springs
(931) 967-4547 or www.BurIsTermite.com
Charter #3824 • License #17759



Warm up with a cup of organic Joe!

Mon-Wed, 7:30am-midnight;
Thurs & Fri, 7:30am-10pm;
Sat, 9am-10pm; Sun, 9am-midnight
Georgia Avenue, Sewanee



598-1963



Like Us On facebook for specials and updates

Obituary

Elsie M. Edwards

Elsie M. Edwards, age 84 of Sewanee, died on Jan. 14, 2016, at Sewanee Hospital Skilled Care. She was born on May 27, 1931, in Sewanee to Manuel and Nancy Gilliam Caldwell. She was preceded in death by her husband, Thomas Edwards; son, James Leon Knight; and sisters Sarah Dickerson, Margaret Meeks and Margie Gilliam.

She is survived by sisters Barbara Baker of Decherd, Dorothy Mason of Sanford N.C., and Lisa Cantrell of Sewanee; daughter-in-law, Lola Knight of Sewanee; three grandchildren, all of Sewanee; five great-grandchildren, all of Sewanee; and several nieces and nephews.

Funeral services were on Jan. 16 in the funeral home chapel with the Rev. Spencer Van Order officiating. Interment followed in Cowan Montgomery Cemetery. For complete obituary go to <www.moorecortner.com>.

McCardell to Preach at Otey on Jan. 31

On Sunday, Jan. 31, University Vice-Chancellor John McCardell will offer the sermon at both the 8:50 a.m. and 11 a.m. services at Otey Memorial Parish in Sewanee. Jan. 31 has been designated Bishop Otey Sunday, an annual observance at Otey Parish marking the birthday of Bishop Hervey Otey, who served as the first bishop of Tennessee and who was one of the original founders of the University.

The Bishop Otey Society promotes philanthropic support for the parish through planned gifts and bequests. Members of the society are those who have provided for the future of Otey Parish by leaving a legacy gift to the church in their wills or other planned giving or testamentary instruments. For more information contact Rob Lamborn at Otey Parish.

SAS Assistant Chaplain Molly Short to be Ordained

The Ordination of the Rev. Molly McGee Short to the Sacred Order of Priests will be at 11:30 a.m., Saturday, Jan. 23, in St. Andrew's Chapel. A reception will follow the service in the Spencer Room. The public is invited to attend.

"To be ordained in St. Andrew's Chapel is much more than a moment of vocational fulfillment for me," said the Rev. Molly Short. "Of course it will be the culmination of a long process of preparation for the ministry, with many internships, papers, tests, interviews and sermons. However, the real high point for me is the privilege of being ordained in the presence of the St. Andrew's-Sewanee community.

"Not all ordinations happen this way, and not all priests have the joy of experiencing this crucial moment in the presence of God and the people to whom they dedicate their lives. Many students, faculty and staff are working overtime to pull this celebration together, bringing gifts and talents to help make this service beautiful. And for that, I am overwhelmed with gratitude," she said.

"Ordinations almost always take place in churches, so this is a rare opportunity for St. Andrew's-Sewanee," said the Rev. Drew Bunting, SAS chaplain. "Mother Short is being ordained not only as our priest, but also as a priest for the entire Church around the world. When we present her to Bishop Alexander, we will testify that God has called her to serve all people and given her the gifts to do so. We will do so with confidence, having seen those gifts in action."

Short will celebrate her first Eucharist and preside over the baptism of her nephew at 9:30 a.m., Sunday, Jan. 24, in St. Andrew's Chapel. She teaches life issues and introduction to religious studies at SAS and is the assistant chaplain. She was ordained a deacon in the Episcopal Church last summer in North Carolina. She and her husband, Michael, live on the SAS campus, where he teaches humanities, English and outdoor adventure.



Molly Short

Church News

Otey Memorial Parish

At 10 a.m., Sunday, Jan. 24, Otey Parish's Adult Forum meets in St. Mark's Hall of Claiborne Parish House. Ross Macdonald will give a presentation about "The Guardian Angel in John Milton's 'Paradise Lost.'"

The Lectionary class will also meet in Claiborne Parish House.

Children ages 3–11 can attend Godly Play at 10 a.m. Middle school Sunday School will meet on the second floor of Brooks Hall. High school Sunday School will meet at the Blue Chair.

Nursery care is available for children 6 weeks to 4 years old, from 8:30 a.m. until after coffee hour.

The Women's Spirituality group will meet 3:30–5 p.m., Sunday, Jan. 24, on the first floor of Brooks Hall at Otey. They will be reading "Pastrix" by Nadia Bolz Weber and will meet for six consecutive weeks. Please feel free to come if you are interested, but have not read the book.

If your church is in our circulation area and would like to be listed here, please send service times, church address and contact information to <news@sewaneemesenger.com>.

Fat Tuesday Feast Otey Parish on Feb. 9

All are welcome to come and let the good times roll for a New Orleans-themed celebration at 6 p.m., Tuesday, Feb. 9, in St. Mark's Hall of Claiborne Parish house. Fat Tuesday festivities and a feast will be hosted by the Otey Parish Crewe.

Master Chef Gary Sturgis will return as Otey's chef extraordinaire. The menu will include Cajun jambalaya, and red beans and rice. For the kids, there will be options of less spicy fare. Lemonade and coffee will be provided; feel free to bring your own beverage of choice. Entertainment will include music and dancing. Costumes of all kinds and Mardi Gras beads are strongly encouraged.

Tickets are \$7 per adult in advance (with no family paying more than \$20); \$8 per adult at the door; children up to the age of 5 are \$2. To help with the event, or if you have questions contact Lynn Stubblefield, email <lynnstubblefield@gmail.com> or call (423) 838-8201; or Claudia Porter, email <porter45@bellsouth.net> or call (931) 636-6548.



CHURCH CALENDAR

Weekday Services, Jan. 22–29

7:00 am Morning Prayer, St. Mary's (not 1/25)
7:30 am Holy Eucharist, St. Mary's (not 1/25)
7:30 am Morning Prayer, Otey
8:30 am Morning Prayer, St. Augustine's
12:00 pm Noon Office, St. Mary's (not 1/25)
4:00 pm Evening Prayer, St. Augustine's
4:30 pm Evening Prayer, Otey
5:00 pm Evensong, St. Mary's (not 1/25)
7:00 pm Taizé, St. Luke's (1/22)

Saturday, Jan. 23

7:30 am Morning Prayer/HE, St. Mary's
10:00 am Sabbath School, Monteagle 7th Day Adventist
11:00 am Worship Service, Monteagle 7th Day Adventist
3:00 pm Shabbat, Sons of Tzadok, Monteagle
5:00 pm Mass, Good Shepherd Catholic, Decherd

Sunday, Jan. 24

All Saints' Chapel

8:00 am Holy Eucharist Rite I
11:00 am Holy Eucharist Rite II
6:30 pm Growing in Grace

Bible Baptist Church, Monteagle

10:00 am Morning Service
5:30 pm Evening Service

Christ Church Episcopal, Alto

11:00 am Holy Eucharist
11:00 am Children's Sunday School

Christ Church, Monteagle

10:30 am Holy Eucharist
10:45 am Children's Sunday School
12:50 pm Christian Formation Class

Christ the King Anglican, Decherd

9:00 am Holy Eucharist
10:40 am Sunday School

Church of the Holy Comforter, Monteagle

9:00 am Holy Eucharist
11:00 am Worship Service

Cowan Fellowship Church

10:00 am Sunday School
11:00 am Worship Service

Cumberland Presbyterian Church, Sewanee

9:00 am Worship Service
10:00 am Sunday School

Decherd United Methodist Church

9:45 am Sunday School
10:50 am Worship

Epiphany Episcopal Church, Sherwood

10:30 am Holy Eucharist
10:30 am Children's Sunday School

Good Shepherd Catholic Church, Decherd

10:30 am Mass
Grace Fellowship

Harrison Chapel Methodist

10:00 am Sunday School
11:00 am Worship Service

Midway Baptist Church

10:00 am Sunday School
11:00 am Morning Service
6:00 pm Evening Service

Midway Church of Christ

10:00 am Bible Study
11:00 am Morning Service
6:00 pm Evening Service

Morton Memorial United Methodist, Monteagle

9:45 am Sunday School
11:00 am Worship Service

New Beginnings Church, Jump Off

10:45 am Worship Service

Otey Memorial Parish

8:50 am Holy Eucharist
10:00 am Christian Formation

Pelham United Methodist Church

9:45 am Sunday School
11:00 am Worship Service

St. Agnes' Episcopal, Cowan

11:00 am Sunday Service (Rite I)

St. James Episcopal

9:00 am Children's Church School
9:00 am Holy Eucharist

St. Margaret Mary Catholic Church, Alto

8:00 am Mass

St. Mary's Convent

8:00 am Holy Eucharist
5:00 pm Evensong

Sewanee Church of God

10:00 am Sunday School
11:00 am Morning Service
6:00 pm Evening Service

Society of Friends

9:30 am Meeting, 598-5031

Tracy City First Baptist Church

9:45 am Sunday School
10:45 am Morning Worship
5:30 pm Youth

Valley Home Community Church, Pelham

10:00 am Sunday School
10:00 am Worship Service

Wednesday, Jan. 27

6:00 am Morning Prayer, Cowan Fellowship

12:00 pm Holy Eucharist, Christ Church, Monteagle

5:30 pm Evening Worship, Bible Baptist, Monteagle

6:00 pm Prayer and study, Midway Baptist

6:00 pm Youth (AWANA), Tracy City First Baptist

6:30 pm Community Harvest Church of God, Coalmont

6:30 pm Prayer Service, Harrison Chapel, Midway

7:00 pm Adult Formation, Epiphany, Sherwood

7:00 pm Evening Worship, Tracy City First Baptist



MOORE-CORTNER FUNERAL HOME

Specializing in pre-funeral arrangements • Offering a full range of funeral plans to suit your wishes • We accept any & all Burial Insurance Plans



We are a father & son management team—
Bob & Jim Cortner
Owners/Directors

967-2222

300 1st Ave. NW, Winchester

Phone 598-9949 to find out how to put the Messenger in your advertising budget.

MOUNTAIN TOP STORAGE

**Now accepting reservations for summer storage.
Moving services available.**

931-924-3454

Find us on the web at <mountaintopstorage.com>.



ST. MARY'S SEWANEE
The Ayres Center for Spiritual Development

Call (931) 598-5342
or (800) 728-1659
www.StMarysSewanee.org
<reservations@stmaryssewanee.org>

UPCOMING RETREATS

Albert Camus and the Grammar of Biblical Hospitality

Friday, February 12–Sunday, February 14

Victor Judge, presenter

St. Mary's Hall, \$350 (single);

The Anna House, \$450 (single); Commuter, \$250

The Soul in Progress

Friday, May 20–Sunday, May 22

Camille and Kabir Helminski, presenters

St. Mary's Hall, \$350 (single);

The Anna House, \$450 (single); Commuter, \$250

Insurance (from page 1)

helps consumers navigate the plans available to them and estimate their total health care costs for the year, so they can pick the plan that best fits their needs and budget.

Those who don't have health insurance in 2016 may face a fine of \$695 or 2.5 percent of their income (whichever is greater). And that is on top of having to pay out-of-pocket for routine medical care and unexpected emergencies. Tennesseans shouldn't delay and risk paying the fine and high medical bills, when they can have quality, affordable health insurance that will cover the essentials and protect them from the unexpected.

Enroll America is the nation's leading health care enrollment coalition. An independent nonprofit, nonpartisan organization, Enroll America works with more than 6,700 partners in all 50 states to create cutting-edge tools, analyze data, inform policy and share best practices in service of its mission: maximizing the number of Americans who enroll in and retain health coverage under the Affordable Care Act.

The Get Covered America campaign was created in 2013 to inform millions of eligible consumers about their new health insurance options, and has been tested, refined and proven successful through two enrollment cycles. Get Covered America programs and tools are now being utilized by partners in enrollment efforts nationwide, supported by more than 100 Enroll America staff working nationally and on-the-ground in targeted communities across the country.

—Information provided by
Get Covered America

**Love Doesn't
Have to Hurt.
Help is Free.**

**Call the
Haven of Hope
Victim Hotline
1-800-435-7739**



Senior Center News

Volunteers Needed

The Senior Center is in need of volunteers to help in the kitchen before and after lunch on Mondays, Tuesdays and Thursdays. If you can help please call 598-0771.

Lunch Menus

The Sewanee Senior Center serves lunch at noon on weekdays. The suggested donation is \$3 (50 or older) or \$5 (under 50). Please call by 9 a.m. to order lunch.

Jan. 25: Fish, french fries, slaw, dessert.

Jan. 26: Meat loaf, pin-to beans, slaw, cornbread, dessert.

Jan. 27: Chicken, dump-lings, crowder peas, fried okra, cornbread, dessert.

Jan. 28: Vegetable soup, grilled cheese, dessert.

Jan. 29: Pork chop, field peas, stewed potatoes, cornbread, dessert.

Weather Policy

The Senior Center follows the schedule of the Franklin County School System when the weather is bad. If the Franklin County schools are closed due to snow or ice, the Senior Center will be closed, and no meals will be cooked, served or delivered on that day.

Center Participation

The Sewanee Senior Center does not charge any membership fee. All persons 50 or older who take part in any of the activities are considered members. The center is located at S Ball Park Rd., behind the Sewanee Market.

To reserve a meal or for more information, call 598-0771.

Taxes (from page 1)

University students and community members, have received IRS-approved training and will help taxpayers fill out their returns via computer and file them electronically with the IRS. With electronic filing, tax refunds can be processed more rapidly, and refunds can be deposited electronically into taxpayers' bank accounts.

The IRS anticipates that about 70 percent of taxpayers will be eligible for tax refunds this year. In 2015, the national average refund was \$2,797. Last year, more than 85 people took advantage of the VITA service locally, and they collected refunds of more than \$20,000. The volunteers are trained to ensure that filers get benefits to which they are entitled, including Earned Income Tax Credits.

People wanting to take advantage of this free service should bring with them the following items:

- Proof of identification (photo ID) for each filer.
- Social Security Cards (if return is filed jointly, all cards must be available, and both individuals must be present to sign the return).
- Filers without Social Security cards must bring an IRS Individual Taxpayer Identification Number (ITIN) assignment letter.
- Wage and earning statements (W-2, 1099, etc.).
- Dividend and interest statements.
- Birth dates of the filer(s), spouse and dependents.
- Banking account and routing numbers for direct deposit, which can be found on a blank check.

This service is completely free of any expense to the taxpayer. In 2015, the local VITA program was selected for a random site audit, and the program received a perfect score from the IRS. For more information about the schedule or other questions, contact the program director, Ben Carstarphen, via email, <carstjb0@sewanee.edu>, or by phone, (704) 675-1025.

Funding for the VITA program is provided by the University's Canale Endowment.



BOOKMARKED

A Column for Young Adult Readers and Adults Who Appreciate The Genre

by Margaret Stephens

For the Winter Weary

Back in the day, I used to hurry to the mailbox hoping for real letters from real friends. Now, I keep an eager ear out for my phone and those virtual contacts. Can you imagine waiting half-a-year for a letter? Can you imagine being a teenager and waiting that long? A year ago, I said I'd be writing about "heritage" books, fiction that for one reason or another may have slipped below the popular radar. To round out the year, then, one more.

Do you know "Mrs. Mike?" Written in 1947 by Benedict and Nancy Freeman, it's the true-life story of a 16-year-old sent from Boston to Calgary in the early 1900s to recover from pleurisy. Not exactly where I'd send a sick child, but oh, well. Kathy Mary O'Fallon promptly marries Mike Flannigan, a sergeant in the Royal Canadian Mounted Police, and then travels with him even further north, to the upper wilds of British Columbia and Alberta, where he is policeman, doctor, lawyer, firefighter, adviser and anything else necessary. These outposts are so remote that the initial journey takes several months by dogsled, and Mrs. Mike is generally the only "white" woman for hundreds of miles.

But Mrs. Mike is one feisty and determined young woman. Though no older than our daughters when they're exchanging learner's permits for licenses (our modern-day moment of independence), Mrs. Mike decides early on that the weather, the wolves and the wilderness aren't going anywhere, and if she wants this marriage to work, she's the one who will have to change.

Give Sergeant Flannigan his due, he does everything in his power to make her life a little easier. He's also one charming guy, with "eyes so blue you could swim in them" and that distinctive Dudley Do-right red serge coat. But it's the teen-wife's courage that stands out for me: Once she makes up her mind, she endures blizzard, forest fire, illness and the twice-a-year mail delivery with a fortitude that reminds me of Laura Ingalls Wilder in "The Long Winter," though with more sense of humor.

This is no marshmallowing-over of events. People die by cold, grizzly attack, fire, bear trap, disease, murder. A couple of women can't handle the wilderness and return home, broken in spirit and mind. But not Mrs. Mike. She takes it all in stride, from the impromptu "tea party" she gives when her first home is overrun with curious Indians, to hitting the trail once again when heavily pregnant.

The book, considered by some to be a Young Adult classic, was made into a film and inspired two sequels. The New York Times pointed out that its persevering heroine and her Mountie "captivated a war-weary world." Perhaps it will relieve your winter-weary spirits? I'm still not sure how I missed this book. It was only by the grace of a kindly Chattanooga librarian who was giving it away that I stumbled on it at all. But you can find it a lot easier: just head for duPont Library. And be thankful that you don't have to get there by dogsled.

What book is your winter warmer? Let me know by email to <mgtstep@mgmail.com>. As always, I blog at <www.my2ndfreshmanyear.wordpress.com>.

Unique Mountain Properties



816 LAKE O'DONNELL RD. Sewanee. Walk to Mtn. Goat Trail. All-brick home, well-maintained. Screened porch. 1510 sf, 3/1. MLS#1564620. \$139,900.



THE AERIE. 2015 Laurel Lake Dr. Aviator-like view, sitting on a point! 4/3 main house. Guest apt. 2/1. Pool. Vacation rental potential. MLS#1531518. \$575,000.



1639 JACKSON POINT. 17+ acres. Awesome view, drive roughed, water line to house site. MLS#1621005. \$75,000.



622 1ST ST. WEST AT ASSEMBLY ENTRANCE. Gorgeous renovation. 2016 sf, 3/2. MLS#1605342. \$229,900.



CLIFFTOPS. 2331 Lakeshore Dr. Spacious one-level home w/over 500 ft lake frontage. Sun porch facing lake, gazebo, meditation bench at lake edge. 3250 sf, 5BR, 4BA. MLS#1565259. \$559,900.

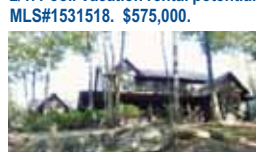

1804 CLIFFTOPS AVE. Brow rim home. Natural wood and views throughout. Decks, porches, stone fireplace. 4151 sf, 6/4. MLS#1580699. \$995,000.



2516 CLIFFTOPS AVE. Exquisite master on the main. Near lake. 3739 sf 4BR/5.1BA. MLS#1682931. \$495,000.



616 ELGIN DR. Brick home. Fenced backyard, storage bldg. Hardwood floors, fireplace. 3/2, 1466 sf MS#1697044. \$184,500.



340 WRENS NEST AVE. Log cabin mountaintop home. Renovated. 1200 sf, plus porch on 3 sides. 2/2. MLS#1669144. \$130,000.



3200 PARTIN FARM RD. Log home w/shop bldgs. Garage apt. RV/boat shed, paved drive. 1296 sf, 2/2. MLS#1695398. \$238,000.



1828 HICKORY PLACE. Cliff tops cottage. Sun porch, bonus room. 2733 sf, 3/3.5. MLS#1678284. \$379,900.



376 OLD INGMAN RD. Spectacular brow view. Screened porch. 6 acres wooded. 1570 sf, 2/2. MLS#1587692. \$399,000.



1911 HICKORY PLACE. Cliff tops. Landscape pool, treetop terrace, hot tub, fireplaces. Great room/gathering room. 2 or 3 BR, 2BA, 1916 sf +porches. MLS#1572091. \$269,000.



WINTERBERRY/HICKORY CORNER LOT. 5+ acres, quiet neighborhood in Cliff tops. MLS#1688511. \$82,900.

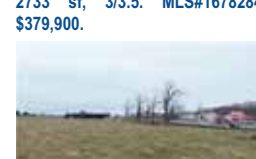

INVESTMENT PACKAGE of 10 commercial lots on Monteagle/Sewanee Hwy., across from Cliff tops. MLS#1681959. \$200,000.

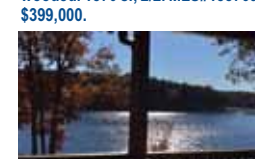

179 LAKE SHORE DR. 23.31 Acres w/lone Big Creek Lake frontage. 3498 sf, 4BR, 3BA. MLS#1676732. \$697,000

THE LOCAL MOVER

615-962-0432

Need More Room?

We Sell Boxes!

Mountain Storage

(931) 598-5682

■ Security Gate Dan & Arlene Barry ■ Security Camera
Hwy 41 - Between Sewanee & Monteagle

5X10 | 10X10 | 10X20

For Your Antiques and Prized Possessions

Climate Control

5X10 10X10 10X15 10X20
Temperature and Humidity Regulated

BBB



ROB MATLOCK
CONSTRUCTION COMPANY
NEW HOME BUILDING
AND REMODELING

MEMBER, U.S. GREEN BUILDING COUNCIL

PHONE 931-598-5728

MATLOCK

State Licensed • Fully Insured



EAT IN OR TAKE OUT

You can still have
dinner from Julia's!
Just pick it up by 3.



of Sewanee

Open 11 to 3, Monday thru Saturday

24 University Ave., Sewanee • 931-598-5193
julias@vallnet.com • www.juliasofsewanee.com
Contact us about catering your next event!

**Competent, Caring, Friendly, Fair—
We're Here for You!**

Deb Banks, Realtor, 931-235-3385, debbanks8@gmail.com
Dee Underhill Hargis, Broker, 931-808-8948, aduhargis@gmail.com
Ray Banks, Broker-Owner, 931-235-3365, rbanks564@gmail.com
Tom Banks, Realtor, 931-636-6620, tombanks9@yahoo.com
YouTube: Monteagle Sewanee Scenic Properties

Monteagle Sewanee, REALTORS

View these and other quality homes and building sites at

www.monteaglerealtors.com



Then call **931-924-7253**

SES Menus

Jan. 25–29
LUNCH

MON: Ravioli, chicken patty, peanut butter and jelly grab and go, potato smiles, cooked broccoli, fresh salad, roll.

TUE: Fish, hamburger, pinto beans, fresh veggie cup, potato sidewinders, hamburger bun, hush puppies, cheese slice (optional).

WED: Pasta bake, grilled cheese sandwich, cheese and seed grab and go, roasted vegetables, ranch potatoes, veggie juice, garlic bread stick.

THU: Barbecue, mozzarella cheese sticks, baked beans, potato wedges, marinara sauce, hamburger bun.

FRI: Pizza, turkey sandwich, fresh salad, buttered corn, vegetable soup, crackers, cookie.

BREAKFAST

MON: Yogurt, cinnamon grahams or breakfast pizza.

TUE: Biscuit, steak or sausage, gravy, jelly.

WED: Waffle or banana bread slice.

THU: Biscuit, sausage, gravy, jelly.

FRI: Cinnamon roll or apple cinnamon pancake and sausage on a stick.

Options available every breakfast: Assorted cereal, assorted fruit and juice, milk varieties. Menus subject to change.



Education Notes

Cabe Named to Dean's List

The provost of Wofford College, has announced Dean's List students for the Fall 2015 Semester, including Lauren Elisabeth Cabe from Sewanee.

To be named to the Dean's List, a student must be enrolled for at least 12 semester hours of graded courses and attain a semester grade point average of 3.6 or higher.

Local Students Inducted into OG

The following local students were inducted into the Order of Gownsmen at the University of the South during the Opening Convocation on Jan. 11.

Amanda Lea Carl of Monteagle Carl is the daughter of Christie and Stephen Paul Carl.

Georgette Byerly Huber of Sewanee is the daughter of Donald C. Huber Jr. and Susan C. Byerly.

Eva Claire Miller of Sewanee is the daughter of Katherine Lehman and Stephen R. Miller.

Margaret Anne Stapleton of Sewanee is the daughter of Helen and Archie C. Stapleton III.

University Job Opportunities

Exempt Positions: Content Manager/Copywriter, Marketing and Communications; Director, Environmental Health and Safety; Director, Information Literacy and Instructional Technology; Operations Manager, Sewanee Dining; Prospect Research Analyst.

Non-Exempt Positions: Assistant Golf Course Superintendent; Dispatcher (part-time, three positions); Police Officer, Sewanee Police Department; First Cook, Second Cook, Senior Cook, Receiving Clerk and Food Service Worker, Sewanee Dining.

To apply or learn more, go to <www.jobs.sewanee.edu> or call 598-1381.

*Online, In Color
& Always Available*
www.sewaneeessenger.com



Winners of the SES Citizenship Award



Winners of the Templeton Award for diligence.

SES Announces Honor Rolls, Award Recipients

Sewanee Elementary School principal Kim Tucker announced honor rolls and award recipients for the most recent six-week period during a recent school assembly.

First Honor Roll

3rd grade—Zachary Anderson, Sienna Barry, Julia Calhoun, Ann Wright Carlson, Tallulah Frazier, Lana Guess, Parker Kovalski, Zayn Nimis-Ibrahim, Ivy Moser, Robbie Philipp, Nathan Prater, Emery Preslar, Fiona Reynolds, Julia Sumpter, Saida Thomas, Toby VanDeVen and Emma Wockasen;

4th grade—Elliott Benson, Anja Dombrowski, Nailah Hamilton, Reese Michaels and Eva Vaughan;

5th grade—Emily Bailey, Maple Landis-Brown, Kyler Cantrell, Morgan Hiers, Samantha Lu, Luca Malde, Alya Nimis-Ibrahim, Libby Neubauer, Edie Paterson, McKee Paterson, Isabel Patterson, Michael Pongdee, Elizabeth Taylor and Ada Watkins.

Second Honor Roll

3rd grade—Karen Badgley, Maggie Desjarlais, Austin Elliott, Lily Evans, Casen Gilliam, Luke Kelleher, Cady Layne, Maya Mauzy, Ellie Roberts, Harper Temples and Zephany Wiley;

4th grade—Isabella Davis, Jackson Frazier, Isaiah Gilliam, Journey Hicks, Case Hoosier and Amelia Maxon-Hane;

5th grade—Spears Askew, Ava Carlos, Laura Crigger, Victor Eichler, Jenny Hammer, Morgan Jackson, Charlie King, Madison King, Ryan Ostrowski, Alexis Phares, Ava Sanson, Madeline Sumpter, Alex Waldrup and Devin Word.

Citizenship Award (selected by teachers)

Pre-K—Lily Byrd; **K**—Caleb Barry and Daisy Knight; **1st grade**—Azzaellea McFarland; **2nd grade**—Kira Dombrowski and Will Turrell; **3rd grade**—Nathan Prater and Zephany Wiley; **4th grade**—Elliott Benson; **5th grade**—Ryan Ostrowski and Madeline Sumpter.

Templeton Award

(selected by their peers as most exemplifying the character trait "Diligence")

Pre-K—Oliver Briggie; **K**—Bo Vinson and Alice Carlson; **1st grade**—Harper Thompson; **2nd grade**—Kira Dombrowski and Will Turrell; **3rd grade**—Sienna Barry and Saida Thomas; **4th grade**—Eva Vaughan; **5th grade**—Luca Malde and Haley Wallace.

Workshops and Training

Beekeeping School

The Elk Valley Beekeeping Association, in conjunction with the Franklin County Extension Service, is holding a beginner's beekeeping school. The group will meet at 6:30 p.m., Feb. 8 and 9, at the Franklin County Extension Service at 406 Joyce Lane in Winchester. Topics will include setting up an apiary, equipment requirements, seasonal hive management and integrated pest management techniques. This program is designed for youth as well as adults wanting to learn more about starting a beekeeping project. Cost of the course will be \$20 for the Beekeeping in Tennessee manual. Please contact John Ferrell at 967-2741 for more information and to register by Feb. 3.

The Cooperative Extension Program offers its programs to all persons regardless of race, color, national origin, sex, age or disability and is an Equal Opportunity Employer.

Farmers' Market Workshops

Farmers planning to sell products at farmers' markets can learn simple marketing methods that can make them money at Farmers' Market Boot Camps in 2016. Topics to be addressed will include basics of marketing by social media and email, sources of grants and micro-loans, record-keeping for good business management, requirements for basic types of foods that may be manufactured and sold at farmers markets and an overview of new food safety regulations.

"The focus of this year's farmers' market boot camps is learning marketing methods to increase sales or decrease costs, finding sources of money and knowing whether you're making money," says Hal Pepper of the UT Center for Profitable Agriculture. "We will also discuss the regulations that apply when making a food product to sell at a farmers' market and how to determine whether the new federal food safety regulations for produce growers and food manufacturers apply to your operation."

These workshops are open to all farmers and will be taught by University of Tennessee Extension specialists Faith Critzer, Megan Leffew and Hal Pepper.

To attend a workshop, preregister online at <<https://tiny.utk.edu/FMBOOT2016>>.

The fee is \$20, and lunch will be provided. Preregistration is required at least five business days prior to the workshop; space is limited.

The workshops will be held in Lebanon (Feb. 22), Winchester (Feb. 24), Trenton (March 2) and Centerville (March 3).

For more information about the workshops, go to <www.ag.tennessee.edu/cpa>.

Concealed Carry Class

Elk River Training Center is offering an all-women's class to obtain a concealed carry permit, 8 a.m.–4 p.m., on April 2 in Pelham. The cost is \$55.

Before signing up for this class, women should have a basic knowledge of handling and shooting a handgun. If they do not, Karen Nostrant is a certified handgun instructor and provides private lessons. For more information or to register call Nostrant at (716) 474-4785.

Elk River Training Center also has co-ed carry permit classes, Handgun 1 classes, Appleseed youth rifle and NRA high-powered rifle classes.

For more information about Elk River Training Center or other classes available call (931) 383-9100.

OUR SEWANEE CUSTOMERS SAY IT BEST:

"Nelson and his staff offer great service and good value. It's a pleasure to work with them."

—Jay Fisher



Nelson Hatchett
931-967-7546



A-1 CHIMNEY SPECIALIST "For all your chimney needs"

Dust Free • Chimneys Swept, Repaired, Relined & Restored • Complete Line of Chimney Caps • Waterproofing Video Scanning



G. Robert Tubb II, CSIA *Certified & Insured*
931-273-8708

Cottage in the Woods FOR SALE BY OWNER



Custom-built cottage on 2-1/2 acres just off campus. 1800 sq. ft. plus detached 1-bedroom/1-bath mother-in-law rental apartment. Photos & further details on <forsalebyowner.com>. \$335,000. For appointment contact Sally Harding at 931-308-6475.

“If you follow the crowd, you will never get in front.”

From “Two-Liners Stolen From Others” by Joe F. Pruett

Sewanee Realty

SewaneeRealty@inSewanee.com
www.SewaneeRealty.com
115 University Ave., Sewanee, Tenn.

Margaret Donohue,
Principal Broker • 931.598.9200

Patsy Truslow,
Broker • 931.636.4111



BLUFF HOME - MLS 1696535 - 1105 North Bluff Circle, Monteagle. \$368,000



BLUFF - MLS 1646170 - 3335 Jackson Point Rd., Sewanee. \$289,000



MLS 1693730 - 63 Oak Hill Circle, Sewanee. \$392,000



BLUFF - MLS 1648470 - 245 Coyote Cove Lane, Sewanee. \$469,900



BLUFF - MLS 1657852 - 1819 Bear Ct., Monteagle. \$259,000



BLUFF - MLS 1656823 - 1613 Laurel Lake Drive, Monteagle. \$469,000

LOTS & LAND

Ingman Rd., .809ac	1696338	\$15,000
Trussell & Stamey, 7.45ac	1697270	\$400,000
Dixie Lee Ave., 1.29ac	1697307	\$400,000
Haynes Rd., 6.5ac	1690261	\$75,000
13 Horseshoe Ln, 3.19ac	1679661	\$39,000
57 Edgewater Ct, Winch	1668196	\$37,500
Highlander Dr. 15ac	1669734	\$79,500
18 Deerwood Dr. 2.9 ac	1677612	\$35,000
21 Jackson Point Rd.	1677613	\$19,000
20 Jackson Point Rd.	1677614	\$19,000
111 Clifftops Dr. 5.25ac	1646127	\$58,900
Hwy 41 Monteagle 5.3 ac	1632373	\$64,000
29 Azalea Ridge Rd 8.4ac	1593095	\$27,500
34 Azalea Ridge Rd 5.4ac	1593097	\$18,500
Shadow Rock Dr. 1.01ac	1572176	\$23,000
Shadow Rock Dr. .99ac	1572178	\$23,000
5 ac Montvue Dr.	1524683	\$59,000
36 Azalea Ridge Rd.	1378840	\$29,900
Sarvisberry Place	1628195	\$69,000
Sarvisberry Place	1244981	\$69,000



BLUFF - MLS 1692347 - 1043 North Bluff Circle, Monteagle. \$262,000



MLS 1697285 - 310 Dixie Lee Ave., Monteagle. \$550,000



MLS 1688907 - 645 Breakfield Rd., Sewanee. \$485,500



MLS 1566093 - 612 Dogwood Dr., Clifftops. \$150,000



MLS 1688434 - 324 Rattlesnake Springs, Sewanee. \$379,000



MLS 1630351 - 706 Old Sewanee Rd. +30 acres, Sewanee. \$332,000



BLUFF - MLS 1642589 - 3480 Sherwood Rd., Sewanee. \$399,900



MLS 1696968 - 145 Parsons Green Cir., Sewanee. \$249,000



BLUFF - MLS 1626882 - 3442 Sherwood Rd., Sewanee. \$589,000



MLS 1677920 - 631 Dogwood Dr., Clifftops. \$299,500



15 acres - MLS 1541012 - 786 Old Sewanee Rd., Sewanee. \$349,000



BLUFF - MLS 1670579 - 225 Hollingworth Cove Rd., Monteagle. \$398,000



MLS 1692858 - 21 Mont Parnasse Blvd., Sewanee. \$329,000



MLS 1684073 - 136 Parsons Green Cir., Sewanee. \$210,000



MLS 1637317 - 109 Wiggins Creek Dr., Sewanee. \$439,000



MLS 1697309 - Dixie Lee Ave., Monteagle. \$250,000



BLUFF - MLS 1670758 - 1899 Jackson Point Rd., Sewanee. \$319,000



MLS 1514972 - 202 Main St., Monteagle. \$112,000



MLS 1667542 - 36 Lake Bratton Lane, Sewanee. \$429,000



BLUFF - MLS 1662801 - 827 Scenic Rd., Monteagle. \$293,500

BLUFF TRACTS

590 Haynes Rd, 11+ac	1687354	\$132,000
15 Saddletree Ln. 6.12ac	1680519	\$88,000
1 Jackson Point Rd. 8.6ac	1676821	\$76,000
1605 Laurel Lake 5.3ac	1659882	\$149,000
223 Timberwood 5.12ac	1604345	\$189,000
Old Sewanee Rd. 5.3ac	1643144	\$369,000
3 Horseshoe Lane 5.6ac	1608010	\$65,000
1 Raven's Den 5.5ac	1685926	\$62,000
Long View Lane 2.56ac	1572284	\$108,000
36 Long View Lane	1503912	\$99,000
7 Jackson Pt. Rd.	1503910	\$82,000
37 Jackson Pt. Rd.	1579614	\$75,000
Jackson Pt. Rd. 12.45ac	1579007	\$125,600
4 Saddletree Lane	1577042	\$109,180
12 Saddletree Lane	1578117	\$79,500
Jackson Pt. Rd. 19+ac	1531331	\$120,000
Jackson Point Rd.	1648895	\$199,000
7 Saddletree Lane	1417538	\$70,000

THE INSATIABLE CRITIC

by Elizabeth Ellis



Every good critic needs a good rating system, and there's nothing on the planet more critical than cats, so one feature each week is rated from one to five Tobys. The more Tobys there are, the better it is!



Sir Toby

The Peanuts Movie

7:30 p.m. • Friday and Saturday, Jan. 22–23

2:00 p.m. • Saturday and Sunday, Jan. 23–24

2015 • Rated G • 88 minutes

Charlie Brown and crew get an animation upgrade in the first big-screen adventure of the lovable characters from the imagination of Charles "Sparky" Schulz. And they've never looked so good! Melding the classic hand-drawn style of the characters with their toothy grins and shaky smiles with vivid colors and textures, the characters gain added dimension without losing their souls. Nominated for a Golden Globe for Best Animated Motion Picture, Snoopy is as fluffy as we've ever seen him, and Lucy's black bob gets a sheen that would make L'Oreal jealous. The story line follows two intertwined tales of Snoopy hitting the skies to take on his nemesis, with his best friend Charlie Brown looking for a second chance by winning back his great love. Rated G, this family-friendly feature, while a little thin on plot, remains an inspiration for the "underdog" in all of us.



La Haine

7:30 p.m. • Wednesday, Jan. 27

1995 • Unrated • 98 minutes

This French black-and-white suspense drama focuses on the stark lives of three young men—one Jewish, one Arab and one black—living in a suburban ghetto in the 24 hours after a violent outbreak, when the diverse population clashes with a racist police force. Vinz, the Jewish man, vows to take revenge if his Arab friend dies from the beating he received. It is a tour de force that raises important questions about race relations locally and internationally, and is best suited for older teens and adults. Parents of younger children should use caution due to the harsh content of this film. French with subtitles.

Bridge of Spies

7:30 p.m. • Thursday–Sunday, Jan. 28–31

2015 • Rated PG-13 • 142 minutes

Based on true events, this latest Steven Spielberg hit (nominated for Best Picture this year) takes us right into the heart of the Cold War. Tom Hanks plays lawyer James B. Donovan, who in 1957 finds himself in the unenviable position of defending an accused Soviet spy, Rudolf Abel, whom many in the country believe should be executed without a trial. When Abel is convicted, Donovan convinces the judge to keep him as a prisoner, in case they need to use him as leverage when negotiating with the Soviets. A complicated game of cat-and-mouse ensues, when the CIA notifies Donovan three years later that a U.S. spy pilot has been arrested by the Soviets, and Abel may be their pawn to get their man back. Rated PG-13 for violence and brief strong language.

For more reviews and fun go to <www.theinsatiablenritic.blogspot.com>.



"Dialogue" mixed media 20"x20" by Elizabeth Core

SAS Gallery Presents Exhibit by Elizabeth Core

The St. Andrew's-Sewanee Gallery is pleased to welcome the work of Elizabeth Core from Jan. 27 through March 3.

A gallery reception celebrating her exhibition will be held from 5 to 7 p.m., Thursday, Feb. 4, in the St. Andrew's-Sewanee Gallery, located in the center hall of the Simmonds Building.

Core spent her formative years in Sewanee and graduated from St. Andrew's-Sewanee in 1984. She received her B.A. in studio art and M.A. in English writing from Hollins College. She earned her M.F.A. from University of North Carolina-Greensboro. Core's work is in numerous corporate, nonprofit and private collections.

"My paintings are first and foremost about color and its ability to create an essence of spirituality," Core said. "I layer color in a variety of shapes, marks and textures to create rhythm, harmony and movement. The resulting abstract landscapes are vibrant, yet organic and mystical images. Each evokes an essence of my own spirituality and my belief that color can create supernatural sensations. To see more of her work, go online to <elizabethcore.com>.

Core will offer a community workshop, 9 a.m.–4 p.m., Saturday, Feb. 27, at the SAS Gallery. During this mixed media class, participants will use pastels, paints and fibers (both from nature and man-made) to create texture on canvas. Participants should bring a small paper or fabric item to incorporate into their piece. The price of the workshop is \$35 and includes lunch.

Gallery hours are 9 a.m.–3 p.m., Monday through Friday, and by appointment. For more information or to register for the workshop contact SAS Gallery Director Molly Schaefer at (931) 598-5651, extension 3151, or email <sasgallery@sasweb.org>.

Poetry Night Marks Anniversary

Community Poetry Night will celebrate its first anniversary with a Poetry Potlatch at 7 p.m., Tuesday, Jan. 26, at the Blue Chair Café & Tavern. Poets will reach into a box full of original poems from their fellow poets and then perform that work.

The Blue Chair will also be offering specials for the anniversary, and there will be a give away of a \$25 gift card.

Poetry Night is on alternating Tuesdays at the Blue Chair. For more information email <kcummings.kevin@gmail.com>.

Jazz On Jackson

The annual South Jackson Civic Center's "Jazz on Jackson" will begin at 7 p.m., Saturday, Jan. 23, in Tullahoma.

A champagne reception at 7 p.m. will open the event. It will feature the artwork of Michael Bush and music by Robert Hiers. Marcia and Richard Cowan and friends are the hosts.

Bush, an artist from the Bell Buckle area, enjoys painting large panels of jazz musicians. Keyboardist Hiers will delight visitors with his smooth renditions of many favorites. By day, he is a scientist at Arnold Engineering Development Center.

At 8 p.m., the Kelli Cox Collaborative, a group of Nashville area musicians comprised of some of the most sought-after musicians, will take the stage.

The Mitchell Museum will be open for viewing. Adult tickets are \$20; students \$15. For more information or to purchase tickets, call (931) 455-5321 or email <tickets@southjackson.org>.

We're glad you're reading the Messenger!

91 University Ave. Sewanee

UNIVERSITY REALTY

SEWANEE TENNESSEE



Lynn Stubblefield (423) 838-8201

Ed Hawkins (866) 334-2954

Susan Holmes (423) 280-1480



ST. MARY'S LANE. 10+ acres beautifully wooded with lots of road frontage. \$80,000



LOOKING FOR A SMALL FARMHOUSE with a barn on Campus? This is it! 372 Lake O'Donnell. \$150,000.



LAUREL LAKE. Private and secluded 6.5 acres, small lake and spacious, lovely 3-bedroom home. \$239,900

SEWANEE SUMMIT. 60 acres, build on it or hunt on it. \$89,000.
SNAKE POND RD. 30 wooded acres close to campus.



CLIFFTOPS RESORT. Ranch style, single story, 2 master suites, guest house, 2 fireplaces, 2-car garage, many extras.



BLUFF LOTS on Sherwood Road. 3 miles from University Ave. Stunning view of Lost Cove, spectacular sunrises, road frontage. 4.08 acres and 17.70 acres.



PEARL'S FOGGY MOUNTAIN CAFÉ for sale. Business, furnishings, equipment and goodwill. \$200,000.



NORTH CAROLINA AVE. Located in the heart of campus. Presently a duplex. Can be a residence. Many extra features.



HYDROPONIC GREENHOUSE 2 years old. \$28,000 without or \$14,000 with the property.



CLIFFTOPS RESORT. 5 acres, year-round creek, joins University, private & secluded. \$79,000.

BLUFF LOT. Partin Farm Road. 6.42 acres. \$75,000.

SHADOW ROCK DR. 1.18-acre charming building lot with meadow.

WE HAVE BUYER'S AGENTS TO REPRESENT YOUR INTEREST AT NO CHARGE

<www.TheMountainNow.com>

Valentine's Wine Dinner

6:30 p.m., Saturday, Feb. 13
5 wines, 4 courses.

Please call for your reservation early.

The mountain's best gourmet breakfast, served daily 8–10 a.m.

Monteagle Inn RETREAT CENTER

Tallulah's Wine Lounge

(931) 924-3869 ~ www.monteagleinn.com ~ 204 West Main St.

Your Place for Organic & Local Products

- ◆ Natural Foods
- ◆ Personal Care Products
- ◆ Garden Supplies
- ◆ Yarn & Knitting Supplies
- ◆ Local Arts & Crafts
- ◆ Jewelry
- ◆ Gifts
- ◆ Antiques

Mooney's

OPEN DAILY 10-6

Market & Emporium

931-924-7400 • 1265 W Main Street • Monteagle, TN



Baseball/ Softball Sign-Ups

The Town of Monteagle will be having baseball and girls' softball sign-ups beginning on Saturday, Jan. 23, in Monteagle City Hall, from 10 a.m. to 2 p.m. This will be for all age groups. They will be at the same location and times on Jan. 30, Feb. 6 and Feb. 13.

For more information text or call Louie Ladd at (931) 836-8083 or (931) 924-3333, or email <debbieadmin@blomand.net>.

Mountain Lion Swimmers Qualify for Regional Meet

On Jan. 12 the St. Andrew's-Sewanee School swimmers competed against swimmers from Fayetteville, Lincoln County, Grundy County, Webb School, Warren County and Tullahoma swim programs. Both the men's team and the combined teams finished second to Tullahoma, defeating all other teams.

Sam Smith continued the strong performance he has displayed all season, with a first-place finish in the 200-yard individual medley and a second-place finish in the 100-yard breaststroke. Senior Joshua Alvarez took second place in the 100-yard freestyle (1:00.38 sec), sophomore Catherine Gray took second in the 200-yard individual medley, and junior Lilly Zhen took second in the 100-yard breaststroke.

Time drops of note were achieved by seventh-grader Michael Vaughn and sophomore Fiona Qian.

The Mountain Lion swim team took to the pool again on Jan. 14, when they hosted swimmers from Franklin County High School and a combined Franklin County middle



The University has begun the final stage of the Sewanee Inn and golf course project. Ground has been broken for the golf clubhouse (above), and construction is expected to be completed by July, weather permitting. Clubhouse plans call for retail space, a snack bar, and indoor and outdoor dining areas. Funded completely by gifts made for the project, the clubhouse will be located behind the ninth green, adjacent to the practice range. The clubhouse architect is Street Dixon Rick of Nashville.

school swim team. The SAS varsity men's team was narrowly defeated by a one-point margin, while the SAS middle school men's team lost to the Franklin County middle school team by six points.

Three seniors were honored at the meet: Joshua Alvarez of Sewanee, a day student from Sewanee and seven-year member of the swim team; Andreas Forsyth of Germany, who competed in his first and only SAS meet; and Jerry Jin of China, a first-year swimmer. Jin finished the season with an incredible 25.13-second time drop on the 100-yard breaststroke.

The SAS middle school men's team continued to improve in the 200-yard freestyle relay, and eighth-grader Aidan Smith took first place in the 100-yard butterfly.

Varsity swimmers Joshua Alvarez, Catherine Gray, Jack Haight and Sam Smith travel to Nashville on Jan. 29 for the high school regional meet and the chance to qualify for the state championship. Middle school swimmers travel to Nashville to compete in the championship meet on Jan. 30.

Frazier & Knoll Lead Mountain Aquatic Swimmers

On Saturday, January 9, 11 swimmers from the Mountain Aquatic Club (MAC) travelled to Tullahoma to compete in the Tullahoma Swim Club's annual Karen Hamilton Memorial Swim Meet. MAC swimmers competing in the meet included Jackson Frazier, Sam Frazier, Konrad Knoll, Caroline Neubauer, Libby Neubauer, Maya Mauzy, Edie Paterson, McKee Paterson, Sarah Russell Robertson and Anara Summers.

Jackson Frazier was a top qualifier in all personal events, with two first-place finishes in the 100-yard individual medley and 50-yard breaststroke, a second-place finish in the 50-yard butterfly, and a third-place finish in 100-yard freestyle. All times were new personal bests for Frazier. Frazier's 50-yard breaststroke time was fast enough to qualify for the USA Swimming Age Group Sectionals in Atlanta in March.

Other swimmers finishing in the top three include Maya Mauzy with third-place finishes in the women's 8 and under 25-yard backstroke and 25-yard breaststroke, and Edie Paterson with a third-place finish in the women's 10 and under 50-yard freestyle. All swimmers dropped time in almost all events, including significant time drops by Libby Neubauer, Caroline Neubauer, Anara Summers, Sam Frazier and Konrad Knoll.

On Jan. 16-17, Zolon Knoll competed in the Augusta/Aiken Swim League's Annual Winter Invitational. Knoll steadily dropped time during the meet, earning personal bests in all events, finishing second in the 50-yard breaststroke, third in the 50-yard butterfly, fourth in both the 100-yard breaststroke and 50-yard freestyle, and seventh in the 100-yard freestyle. Knoll also competed in the age 13-14 men's 200-yard breaststroke for the first time, finishing 24th.

Knoll qualified for the USA Swimming Southeastern Short-Course Championships in the 50-yard freestyle, 100-yard freestyle, 50-yard breaststroke and 100-yard breaststroke, and will compete in Alabama Feb. 19-21. Knoll's 50 breaststroke time was also fast enough to qualify for the USA Swimming Age Group Sectionals in March.

Mountain Aquatic Club is owned and coached by Nicole Noffsinger-Frazier; she is assisted by Jeff Frazier, Mary Cash and Nan Long. The club is an official USA Swimming club that practices at the University of the South natatorium from August through April. Interested swimmers should be able to swim a length of the pool in a minimum of two strokes. For more information contact Noffsinger-Frazier at <nanoffsinger@sewanee.edu>.

SAS Basketball Update

The St. Andrew's-Sewanee varsity basketball team lost to Riverside Christian Academy on Jan. 19, 63-59. SAS fell behind 20-10 after the first quarter but battled back to within three points with 2:10 left in the game.

The Mountain Lions were led by Blaise Zeidler's 22 points; Dustin Stensby had his best game of the season, scoring 14 points; Kenneth Thomas added nine points; Burton Dorrough had a strong defensive game and added eight points; Deonte Swain had five rebounds and three points; and John Grammar had three points.

Fowler Center Pool Hours

The Fowler Center pool will be open the following hours until April 27: noon-2 p.m. and 7-9 p.m., Monday and Wednesday; 12:30-2:30 p.m. and 7-9 p.m., Tuesday and Thursday; noon-2 p.m., Friday; and 2-4 p.m., Saturday and Sunday.

The pool will be closed for special events on these dates: Jan. 23, Feb. 19-20, Feb. 27, March 27 and April 15-17. Subsequent changes will be passed along as they are received.



Winchester Podiatry

CHARLES D. GANIME, DPM

Board Certified in Foot Surgery
Diplomate, American Board of Podiatric Surgery
New Patients of All Ages Welcome! We Treat Your Feet!
Most Insurance Accepted, Including TennCare

We are at 155 Hospital Road, Suite 1, in Winchester.
www.winchesterpodiatry.com

931-968-9191

Like the Messenger?
Let us know on Facebook!

OVERTIME

by John Shackelford



My father was a decidedly non-violent man, yet as a coach, I work daily in a situation that is naturally combative with those on the other side. As a lawyer he saw more than his fair share of acrimonious disputes, some that ended in harmful violence. He always preached to me that it took a stronger man to walk away from a situation than to succumb to a violent solution.

As a 12-year-old, I was friends with several other boys who all sat in the back of the school bus together. There was another group of boys that, as a punishment for their previous misbehavior, had been assigned to the first two rows of the bus, up next to the driver. As young boys do, words were exchanged. The moderate amount of testosterone that was just beginning to enter our system led us into a contest of one-upmanship. One morning as we exited the bus, our rival group waited just outside the door. A larger boy stepped forward and gave me a few pushes, trying to pick a fight. I'd be lying if I didn't admit to being a little scared and unsure of what to do next. I recall making a feeble excuse about waiting until after school, and I turned to go into the building. He jumped on my back, sending me facedown into the sidewalk. A cheering crowd gathered around us, and he was on my back punching away, as I lay there with a bloody nose.

At some point the principal pulled him off of me and held his flailing arms back, allowing me the chance to stand. I stood there with a decision to make. My father had taught me about Martin Luther King Jr. and Gandhi, and I remembered his advice about having the strength to walk away. The boy was held firmly in the grasp of an authoritative adult. I couldn't just stand there and chicken out of a good fight. What should I do? With my friends all watching and awaiting my response, I reached back and punched him as hard as I could, square in the nose, to even the score.

We both received in-school suspension that day and were assigned several chores together to work off our preadolescent anger. As we cleaned toilets in unison, we found some mutual respect and common ground. After a few hours of hauling trash to the dumpster, we were laughing at our shared situation. It was pretty clear that hitting back, especially someone who was defenseless, was a poor decision.

As our world today becomes increasingly violent, I cannot help but think of those words my father tried to teach me about the strength required to walk away. His good advice was to look for higher ground when trying to solve problems. When I see senseless acts of terrorism, mass shootings or misunderstandings caused by poor communication or needless prejudice that end in more violence, my natural instinct is to strike back, to throw a strong punch with everyone watching. Bombing a country into submission clearly doesn't quell the hate that seems to grow exponentially with the more people we kill. Continuing a path of allowing guns to be prevalent in our society doesn't seem to increase our defenses. Fear and paranoia don't always lead to improved vigilance, but instead can turn into unneeded aggression when there is no trust.

There is not a clear answer when trying to solve so much irrational hate that has an undetermined source. How can we stop gun violence when the patterns are so unpredictable? We must act on how to limit gun use in this country and consider our role in supplying weapons to the world. Do our fears of the unknown and our distrust of those whose culture is so unlike our own protect us? Or does it simply foster the cycle of violence? When I read about a university president at a leading Christian college advocating that all of his students arm themselves to better prepare to defend a college campus, I am left shaking my head. I am no biblical scholar, but I am pretty sure that "Thou shalt not kill" was one of the big ones.

Perhaps we could assign those who believe that violence is the only answer an afternoon of scrubbing toilets together and emptying the trash cans of the world. As a 9-year-old I had a collection of plastic and wooden guns to play soldier, or cowboys and Indians with my friends. Today I just want peace on earth. No matter how you feel about the best way to reach that goal, we can all agree that learning to turn the other cheek may give us a moment of reflection and a chance to share some more useful chores.

Send your sports news to:

<sports@sewaneeemessenger.com>

Russell L. Leonard

ATTORNEY AT LAW

Office: (931) 962-0447

Fax: (931) 962-1816

315 North High Street
Winchester, TN 37398

Toll-Free (877) 962-0435
rleonard@netcomsouth.com



TOMMY C. CAMPBELL
FOR YOUR IMPROVEMENTS

Call (931) 592-2687

Free Estimates • 20 Years Experience

DRIVEWAY WORK • GRAVEL HAULING
• DOZER & BACKHOE

plus Land Clearing • Concrete Work • Water Lines • Garage Slabs • Sidewalks • Porches & Decks • Topsoil & Fill Dirt Roofing • Additions to House • Septic Tanks & Field Lines

NATURENOTES



Close up of cat-face scars (left) on a slash pine in Florida.
Photos by Yolande Gottfried

Florida Adventures

While in Florida **Yolande and Robin Gottfried** spent some time in the Apalachicola area on the Gulf coast of the Florida panhandle on St. George Island.

"St. George Island State Park is noted as a prime birding area and we had hopes, but all we saw were mockingbirds, cardinals, red-bellied woodpeckers and towhees. Of course, winter on a cold day may not have been the best time for birds.

"What we did see of interest were slash pines that had been turpentine and still showed the "cat-face" scars. These are visible in the photos above, along with nails where the bucket was hung and metal "troughs" to guide the sap into the buckets.

"These incisions were made in the winter. In the hot clear weather of summer the sap would flow rapidly into the bucket, to be later distilled to produce gum spirits or oil of turpentine. This activity took place in the early and mid-1900s, and the trees with their scars are still there.

"In addition to the slash pine forests, another ecosystem on the island is remnant coastal scrub, which has fragrant Florida rosemary (photo at right) or sand heath as a characteristic shrub. It is nothing like the rosemary herb and is more closely related to plants in the heath family. It certainly looked unique to me, with bright yellow fruits along the stems and short, needle-like, spirally arranged leaves."



Sewanee Herbarium Announces Winter Events

Herbarium Tour and Mountathon at the Sewanee Herbarium, Spencer Hall, 9:30–11:30 a.m., Saturday, Feb. 6, with Mary Priestley—This is your chance to see where and what the herbarium is and to help in the work. Spending a morning mounting pressed plants can be a satisfying and fun experience. Learn methods that have been passed down through generations and are still used today, and take home a guide to mounting pressed plants.

Hunt for the Second Hepatica in Shakerag Hollow, 1:30 p.m., Sunday, Feb. 14, with Yolande Gottfried—The first hepatica was already spotted in December. Valentine's Day is known as Olde Groundhog Day by Appalachian traditionalists. We probably won't see a groundhog, but we may see other signs of spring such as pepper-and-salt (harbinger of spring), star chickweed, toothwort and maybe more hepatica. Meet at the Shakerag trailhead by the gates for this moderate-to-strenuous walk that may include a steep rocky section of the trail. Come prepared for muddy, wet, icy, and/or rocky conditions.

Sewanee Garden Club, at the Sewanee Herbarium, Spencer Hall, 1:30 p.m., Monday, Feb. 22, with Mary Priestley and Yolande Gottfried—The Sewanee Garden Club will have its February meeting at the Herbarium.

Early Spring Wildflowers in Shakerag Hollow, 2 p.m., Saturday, March 19—This is the last day of winter, and it's time to head out to Shakerag Hollow to see bloodroot, trout lily and Dutchman's breeches. Meet at Green's View for this moderate-to-strenuous 2-mile walk.

Nature Journaling—A nature journaling group, sponsored by the herbarium, meets 9–11 a.m., Thursday mornings, in the herbarium. An informal gathering, participants share observations and writing and sketch plants or other natural objects. Everyone is welcome.

For more information on these or other Sewanee Herbarium events, contact Yolande Gottfried at the Herbarium at 598-3346 or by email, <ygottfri@sewanee.edu>



Mia



Apples

Pets of the Week

Meet Mia and Apples

Animal Harbor offers these two delightful pets for adoption.

Mia is a darling teenage Manx kitty. If you're looking for a cuddly friend to be at your side, look no further! Sleeping in your lap will be her favorite pastime. Mia is negative for FeLV and FIV, house-trained, up-to-date on shots, microchipped and spayed.

Apples is a sweet, quiet, little, young adult Chihuahua lady who enjoys spending these chilly days in her bed all wrapped up in her comforter. She will stand on her back legs for attention and is happy to cuddle with anyone who wants to hold and pet her. Apples is heartworm-negative, up-to-date on shots, microchipped and spayed.

Every Friday is Black Friday at Animal Harbor. On Fridays, adoption fees will be reduced 50 percent for black or mostly black pets over 4 months old who have been at Animal Harbor for more than a month. Pets adopted from Animal Harbor qualify for a free post-adoption wellness exam by local veterinarians.

Animal Harbor is now in its new shelter at 56 Nor-Nan Road, off AEDC Road, in Winchester. Call Animal Harbor at 962-4472 for information and check out their other pets at <www.animalharbor.com>. Enter the drawing on this site for a free spay or neuter for one of your pets. Please help Animal Harbor continue to save abandoned pets by sending your donations to Animal Harbor, P. O. Box 187, Winchester, TN 37398.

State Park Offerings

Friday, Jan. 22

Astronomy—Meet Ranger Park at 6 p.m. at the Visitor's Center, 11745 US 41, Monteagle, to look through the telescope at the night sky. Bring curiosity, a red light, and wear closed-toe shoes for the short walk to the telescope set up on the Meadow Trail.

Saturday, Jan. 23

Collins Gulf Overlook/Suter Falls Hike—Meet Ranger Gheesling at 10:30 a.m. at the Collins West trailhead, 2689 55th Ave., Gruetli-Laager, for a relatively steep 2-mile round trip hike.

Natural Bridge Geology—Join Ranger Park at 1 p.m. at the Natural Bridge parking lot, 591 Natural Bridge Rd., Sewanee, for a pleasant walk to learn the geologic history of the region with a spectacular backdrop. Wear sturdy shoes and bring water.

Friday, Jan. 29

Stone Door Hike—Meet Ranger Aaron at 1 p.m. at the Stone Door

parking lot, 1183 Stone Door Rd., Beersheba Springs, for an easy 2-mile hike to see the beautiful Stone Door overlook, one of the most stunning in the state with vistas of the Savage Gulf State Natural Area.

The South Cumberland State Park Visitors' Center is located on Highway 41 South between Monteagle and Tracy City and is open 8 a.m.–4:30 p.m. seven days a week. For more information call (931) 924-2980.

Weather

DAY	DATE	HI	LO
Mon	Jan 11	47	19
Tue	Jan 12	41	31
Wed	Jan 13	58	40
Thu	Jan 14	49	35
Fri	Jan 15	36	27
Sat	Jan 16	36	11
Sun	Jan 17	23	09

Week's Stats:

Avg max temp =	41
Avg min temp =	25
Avg temp =	33
Precipitation =	0.07"

Reported by Elizabeth Tilly
Domain Manager's Assistant

Shop and dine locally!

The Gnarled Oak

Furniture refinishing,
chair caning, seat weaving
and furniture repair



Flat Branch Community
2222 Flat Branch Spur
Tracy City, Tennessee 37387
(931) 592-9680
Bill Childers, Prop.

OPERA HOUSE MUSIC

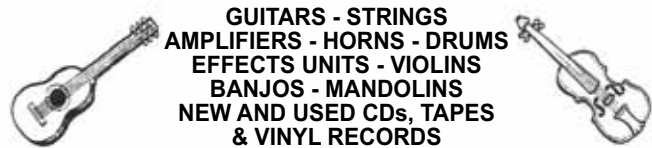

GUITARS - STRINGS
AMPLIFIERS - HORNS - DRUMS
EFFECTS UNITS - VIOLINS
BANJOS - MANDOLINS
NEW AND USED CDs, TAPES
& VINYL RECORDS

230 Cedar Ave., Downtown South Pittsburg, TN 37380
Owner: Dan Mankin
Member NAMM

(423) 837-6650



The Monteagle
Sewanee
Rotary Club
meets at 8 a.m.,
Thursdays, at the
Sewanee Inn
"Service Above Self"



AFFORDABLE Home Repair

Remodeling • Additions • Decks • Painting
House/Floor Leveling and More
Experienced & Honest
Licensed & Insured

423-593-3385



Village Wine & Spirits Inc.

"The House of Friendly Service"

UNDER NEW OWNERSHIP! Now Selling BEER at Great Prices!

10% Discount to Seniors, Veterans, Students & Staff (ID required)

Great Wine Selection ~ Special Orders Available

ALL YOUR FAVORITE MAJOR BRANDS

Across 41A from Monteagle's Piggly Wiggly ~ (931) 924-6900

Mon–Thu 9 a.m.–10 p.m.; Fri–Sat 9 a.m.–11 p.m.

WOODY'S BICYCLES—SALES, SERVICE AND RENTALS

A Full-Service Trek Bicycle Dealer

Mon–Fri 9–5 • Sat 10–2 • 598-9793

woodybike@gmail.com • 90 Reed's Lane

(the red building behind Shenanigans in Sewanee)



Check out www.woodysbicycles.com for rates, trail maps,
photos, bike club links, races and much more!

Classifieds

CALL US! • 598-9949
Classified Rates:
 \$3.25 first 15 words,
 10 cents each addl. word
Now you can charge it!
(\$10 minimum)



CHAD'S LAWN & LANDSCAPING
-FREE ESTIMATES-
 * Lawn care & Design (Mulch & Planting)
 ALSO: * Tree Trimming & Removal
 * Pressure Washing * Gutter Cleaning
 * Leaf Pickup & Blowing * Road Grading
 * Garden Tilling * Rock Work
(931) 308-5059

I-24 Flea Market
200 Vendors!
22 Years!
I-24 Exit 134
Saturday & Sunday
(931) 235-6354

FOR SALE: Craftsman riding mower, 42-inch cut. Kohler commercial engine. \$400 OBO. (931) 224-3268.

"I think my spaceship knows which way to go."
 —David Bowie
 Adam Randolph
 psychotherapist
 randolph.adam@gmail.com

FIREWOOD FOR SALE: \$60/rick. \$70 stacked. Call (931) 592-9405. Leave message.

DIRT WORK

- Bush Hogging
- Driveway Maintenance
- Gravel/Sand/Mulch
- Large or Small Jobs

Michael, 615-414-6177

NAIFCONCEPTUAL.COM: Looking for video, e-commerce and fine arts students to participate in ongoing project. Seven-time published artist. (412) 628-9600.

ST. ANDREW'S SEWANEE SCHOOL (SAS): Seeks a Physical Plant Technician with a minimum of 5 years experience in building, electrical, plumbing or HVAC maintenance/repair. Should have a "team" mentality and be able to work under all kinds of environmental conditions (extreme heat to cold). This person will be self-motivated and willing to learn new things. Pay is commensurate with experience. This is a full-time position with benefits. Some weekend work and on-call duties are required. Applications accepted 7:30 a.m.-4 p.m., Monday-Friday at SAS, Physical Plant Office, 290 Quintard Rd., Sewanee.

CHARLEY WATKINS
PHOTOGRAPHER
 Sewanee, TN
(931) 598-9257
<http://www.photowatkins.com>

OFFICE SPACE: Partin Professional Bldg., middle of Monteagle, just across the street from Mountain Goat Market. One- and two-room suites. Call (931) 580-4538 or (931) 580-4539.

CLAYTON ROGERS ARCHITECT
931-636-8447
cr@claytonrogersarchitect.com



MOLLIKA CONSTRUCTION LLC

931 205 2475

WWW.MOLLIKACONSTRUCTION.COM

- CRAFTSMANSHIP ▪
- CREATIVITY ▪
- SUSTAINABILITY ▪

MASSAGE
Regina Rourk Childress
 Licensed Massage Therapist
www.reginarourk.com
 ~ GIFT CERTIFICATES ~
(931) 636-4806

STEPHENSON'S SCULPTURES IN BRONZE: Bronzes make great gifts. Pet portraits/other commissions. (931) 691-3873.

JOB OPENING FOR SEASONAL TAX ASSOCIATE AT CPA FIRM IN TULLAHOMA

To prepare individual and business tax returns and to perform basic tax planning and research. The seasonal tax associate will apply technical expertise in tax matters to resolve basic tax preparation questions; communicate with clients and team members to collect necessary information and receive supervisory guidance; manage a list of assigned projects; and assist the team in meeting productivity targets through personal results. Please contact Ann McNair at either (615) 824-8142 or (615) 268-1040.

CAREGIVER: Weekdays preferred but negotiable. Light housework. Gail, (931) 598-5139.

EAGLE LANDSCAPING & LAWN MAINTENANCE CO.
Now Offering Specials for WINTER CLEANUP!
 We offer lawn maintenance, landscaping, hedge/tree trimming & more!
Please call for your free estimate
(931) 598-0761 or (931) 636-0383

THE SEWANEE UTILITY DISTRICT OF FRANKLIN AND MARION COUNTIES BOARD OF COMMISSIONERS will hold its regular meeting at 5 p.m. on Tuesday, Jan. 26, at the utility office on Sherwood Road. If a customer is unable to attend but wishes to bring a matter to the board, call 598-5611, visit the office, or call a board member. Your board members are Art Hanson, Randall Henley, Ronnie Hoosier, Karen Singer and Ken Smith.

LOST COVE BLUFF LOTS
www.myerspoint.net
931-703-0558

Email <classifieds@sewaneemessenger.com>

Sweeton Home Restoration
LICENSED • INSURED • TRUSTED
931-924-2444 sweetonhome.com

YOUNG LIVING
 ESSENTIAL OILS
 Independent Distributor

Ray and April Minkler
styraco@blomand.net, aprilminkler@blomand.net
 931-592-2444 931-434-6206
 For over 8,700 testimonials see
www.oil-testimonials.com/1860419

Adaptive Landscape Lighting

Crafted LED Illumination of Architecture, Landscape, Outdoor Living Spaces, Security and Safety Concerns

DON'T SLIP AND BREAK A HIP!

Days are shorter.
 Outdoor lighting is more important than ever.

Bonded : Insured : Experienced : Residential and Commercial
pevans@adaptivelighting.net • www.adaptivelighting.net

Paul Evans : 931-952-8289
 Sewanee, TN

NEED FIREWOOD?
\$50/pickup truck load;
\$60/stacked
(251) 968-8499

INSIDE YARD SALE: Friday-Saturday, 8-3. Excellent bargains! Clothing/shoes for men/women/children; movies/games. Midway Market, 598-5614.

COMPUTER HELP
Troubleshooting & Tutorial
 Computer slowed down over time? Call for a tune-up.
Judy Magavero, (931) 924-3118

SHAKERAG BLUFF CABIN: Beautiful west-facing bluff view. Near University. Extremely secluded. Sleeps 4-5. C/H/A. Great fishing, swimming. Weekend or weekly rentals. (423) 653-8874 or (423) 821-2755.

Oldcraft Woodworkers
 Excellence in custom woodworking.
 Kitchen and bath cabinets, bookcases, entertainment centers, furniture. Furniture repairs and refinishing.
 Est. 1982. Phone 931-598-0208

SARGENT'S SMALL ENGINES: Repairs to All Brands of Equipment: Lawn mowers (riding or push), String trimmers, Chainsaws, Chainsaw sharpening. New saw chains. Pickup and Delivery Available. (931) 212-2585, (931) 592-6536.

The Moving Man
 Moving Services • Local or Long Distance
 Packing Services • Packing Materials
1-866-YOU-MOVE (931) 968-1000
www.themovingman.com
 Since 1993 U.S. DOT 1335895

CONSTRUCTION COMPANY SEEKING: Administrative assistant in Monteagle. Duties: billing, contract administration, purchase orders administration, preparing and tracking proposals, answering and directing phone calls, handling customer inquiries and scheduling, general office work. Requirements: administrative experience in a construction field, strong computer skills, proficient in MS office suite, Quickbooks and Google apps, excellent customer service and organizational skills, ability to multitask, strong math skills, can pass background check and drug screen. Email resumé and cover letter to: <newhire@palmertreelc.com>.

THE FINAL TOUCH
 Painting, Staining and Home Repairs
 Chris Search
 937-815-6551
csearch2013@gmail.com
Free Estimate!
 Professional, Reliable, Affordable

WATER SOLUTIONS
 Joseph Sumpter
 Owner/Licensed Residential Contractor
 Specializing in drainage and rainwater collection systems
 598-5565
www.josephsremodelingsolutions.com

HOUSE FOR RENT COWAN: 1/2BR, furnished/unfurnished. Appliances, W/D hookup. \$600-\$650/mo.+utilities. Deposit, first/last month. No smokers. (713) 825-2274.

TOM'S PLACE
 An Event Hall
 for your business or personal gathering.
 335 W. Main St., Monteagle
 Tom Banks
tombanks9@yahoo.com
 931-636-6620

Walk-In Cooler Filled with Flowers!
—TUXEDO RENTALS—
Monteagle Florist
 333 West Main Street, Monteagle
(931) 924-3292

LOOKING FOR JACK RUSSELL PUPPIES: Call (931) 691-5927.

THE LOCAL MOVER
 Available for Moving Jobs
 Call or Text Evan Barry
615-962-0432
 Reviews at <www.thelocalmoverusa.com>.

LOOKING FOR A USED COUNTER STOVETOP: 36"x21." Call (931) 598-0485.

MAMA PAT'S DAYCARE
MONDAY-FRIDAY
Open 4 a.m.; Close 12 midnight
 3-Star Rating
 Meal & Snack Furnished
Learning Activities Daily
(931) 924-3423 or (931) 924-4036

FIREWOOD: Delivered, \$60/rick (4'x8'). Rita Turner (423) 208-6774, Thomas Barnes, (931) 592-2403; **HOUSECLEANING:** Monteagle-Sewanee area. References. Free estimates. Rita Turner, (423) 208-6774.

(931) 598-0033
HAIR DEPOT
 17 Lake O'Donnell Rd., Sewanee
KAREN THRONEBERRY, owner/stylist
TOBBIN NICOLE, stylist/nail tech

King's Tree Service
 Topping, trimming, bluff/lot clearing, stump grinding and more!
 Bucket truck or climbing
Free wood chips with job
 Will beat any quoted price!
 Satisfaction guaranteed!!
—Fully licensed and insured—
kingstreeservice.com
 Call **(931) 598-9004**—Isaac King

SEWANEE AUTO REPAIR
—COMPLETE AUTO & TRUCK REPAIR—

- Tune-ups
- Tires (any brand)
- Tire repair
- Batteries
- Computer diagnostics
- Brakes
- Shocks & struts
- Steering & suspension
- Belts & hoses
- Stereo systems installed

All Makes & Models • Service Calls • Quality Parts
 ASE Master Certified Auto Technician • 25 Years Experience
7 to 5 M-F • (931) 598-5743 • Across from Regions Bank

Bookmark it! <www.TheMountainNow.com>.

PAUL KLEKOTTA
National Emmy-Nominated Videographer/Photographer
 30 Years of Professional Broadcast and Photography Experience
HI-RES DIGITAL PHOTOS • HD VIDEO
Steadicam Owner/Operator
 Commercials • Documentaries • Music Videos
 Weddings • Sports • Special Events • Corporate Promotions
Excellent Local and National References
423-596-0623
 Email paulklekotta@charter.net

MICHELLE M. BENJAMIN, JD
 Attorney & Counselor at Law

102 FIRST AVENUE, NORTH
 WINCHESTER, TENNESSEE 37398

(931) 962-0006
 (931) 598-9767

myerspoint.net

MYERS' POINT at Sewanee offers a rare opportunity to enjoy a private community that celebrates American architecture, lifestyle, protected forests, cultivated lakes and panoramic views on Middle Tennessee's Cumberland Plateau. If you want to live surrounded by nature, history, beauty, quality and serenity, you'll want to call it home.

- 480-acre private gated community
- 24 exclusive home sites; lakeside or bluff vista
- Timeless, organic, craftsman architecture standards
- Land Trust for Tennessee perpetually protected forests
- Over four miles of walking and riding trails
- Community barn, pastures, resting benches and fire pit
- Minutes from the University of the South

John Goodson • (931) 703-0558 • johngoodson@bellsouth.net



BARDTOVERSE

by Phoebe Bates

Lord Byron, born January 22, 1788

There is a pleasure in the pathless woods,
There is a rapture on the lonely shore,
There is society, where none intrudes,
By the deep Sea, and music in its roar:
I love not Man the less, but Nature more,
From these our interviews, in which I steal
From all I may be, or have been before,
To mingle with the Universe, and feel
What I can ne'er express, yet cannot all conceal.

—From "Childe Harold's Pilgrimage, Canto IV"
by Lord Byron

75% OFF ALL T-SHIRTS & SWEATSHIRTS!



Including the Jack Hastings angel tee!
You'll find this and more on sale at

THE LEMON FAIR

Mon-Sat 11-5 • (931) 598-5248
www.thelemonfair.com 60 University Ave., Sewanee

Brown's Body Shop

Leonard Brown - Owner
Steve Young - Gen. Mgr.
Steve Hartman - Shop Mgr.

710 College St. • Winchester
931-967-1755
Fax 931-967-1798

Come by and see us.
We appreciate your business.

Our Work is Guaranteed!

Tree of Life Homecare, LLC

"Neighbors Helping Neighbors"

- * Licensed and insured home-based services for the elderly and disabled.
- * CHOICES provider, Private Pay, Veterans Affairs

Call 931-592-8733 for a free,
no obligation assessment

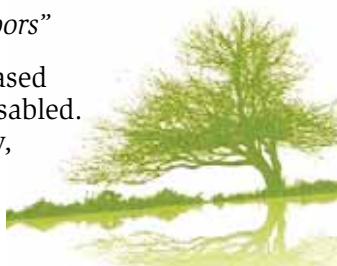

Community Calendar

Today, Jan. 22

- 8:30 am Yoga with Carolyn, Comm Ctr
- 9:00 am CAC office open, until 11 am
- 10:00 am Game day, Senior Center
- 12:00 pm Spinal spa with Kim, Fowler
- 5:30 pm World healing meditation, Comm Ctr
- 7:00 pm Bible study, Mtn of God Tabernacle, Monteagle
- 7:30 pm Movie, "The Peanuts Movie," SUT

Saturday, Jan. 23

- 9:00 am Yoga with Richard, Comm Ctr
- 10:00 am Baseball/softball sign-ups, Monteagle City Hall, till 2 pm
- 2:00 pm Movie, "The Peanuts Movie," SUT
- 7:30 pm Movie, "The Peanuts Movie," SUT

Sunday, Jan. 24

- 2:00 pm Knitting circle, instruction, Mooney's, until 4 pm
- 2:00 pm Movie, "The Peanuts Movie," SUT
- 3:30 pm Women's Spirituality Group, Otey
- 4:00 pm Yoga with Helen, Community Center

Monday, Jan. 25

- 9:00 am CAC office open, until 11 am
- 9:00 am Coffee with Coach, Dennis Meeks, Blue Chair
- 9:00 am Pickleball with John, Fowler Center
- 9:00 am Yoga with Sandra, St. Mary's Sewanee
- 10:00 am Pilates with Kim, intermediate, Fowler
- 10:30 am Chair exercise with Ruth, Senior Center
- 12:00 pm Pilates with Kim, beginners, Fowlers
- 4:00 pm VITA tax assistance at CAC, until 7 pm
- 5:30 pm Yoga for healing with Lucie, Comm Ctr
- 5:30 pm Yoga with Sandra, St. Mary's Sewanee
- 6:00 pm Karate, youth, American Legion Hall; adults, 7 pm
- 7:00 pm Centering Prayer, Otey sanctuary
- 7:00 pm Sewanee Chorale, second floor, Guerry

Tuesday, Jan. 26

- 8:30 am Yoga with Carolyn, Comm Ctr
- 9:00 am CAC office open, until 11 am
- 9:00 am Pilates with Kim, beginners, Fowler
- 9:30 am Crafting ladies, Morton Memorial, Monteagle
- 10:30 am Bingo, Sewanee Senior Center
- 11:30 am Grundy County Rotary, Dutch Maid, Tracy City
- 12:00 pm Pilates with Kim, inter/adv, Fowler
- 12:30 pm Carillon concert, Shapard Tower
- 3:00 pm Tai Chi with Kathleen, beginners, Senior Ctr
- 3:30 pm Centering prayer, St. Mary's Sewanee
- 5:00 pm Acoustic jam, water bldg next to old GCHS
- 5:00 pm Sewanee Utility District meeting, SUD office
- 6:30 pm Prayer/Study, 7th Day Adventist, Monteagle
- 7:00 pm Poetry Night, Blue Chair

Wednesday, Jan. 27

- 9:00 am CAC office open, until 11 am; and 1-3 pm
- 9:00 am Pickleball with John, Fowler Center
- 10:00 am Pilates with Kim, intermediate, Fowler
- 10:00 am Senior Center writing group, 212 Sherwood Rd.
- 10:00 am Story time, May Justus Library, Monteagle
- 10:30 am Chair exercise with Ruth, Senior Center
- 12:00 pm EQB luncheon, St. Mary's Sewanee

- 12:00 pm Pilates with Kim, beginners, Fowler
- 4:30 pm Lecture, Marty Willis, Gailor
- 5:30 pm Yoga with Helen, Community Center
- 6:30 pm Folk music collective, St. Luke's Chapel
- 7:00 pm Catechumenate, Women's Center
- 7:00 pm Lecture, Taber-Hamilton, Hargrove
- 7:30 pm Movie, "La Haine," (Free), SUT

Thursday, Jan. 28

- 8:00 am Monteagle Sewanee Rotary, Sewanee Inn
- 9:00 am CAC office open, until 11 am
- 9:00 am Pilates with Kim, beginners, Fowler
- 9:00 am Gentle yoga with Becky Crigger, Comm Ctr
- 11:00 am Tai Chi with Kathleen, inter/adv, Comm Ctr
- 12:00 pm Pilates with Kim, inter/adv, Fowler
- 12:30 pm Carillon concert, Shapard Tower
- 12:30 pm Episcopal Peace Fellowship, Otey
- 1:00 pm Lecture, Taber-Hamilton, Hargrove
- 1:30 pm Folks@Home Support Group, 598-0303
- 3:00 pm Knitting Circle, Mooney's, until 5 pm
- 6:30 pm Bible study, Cowan Fellowship Church
- 7:00 pm Cowan RR Museum meeting, Arts Ctr
- 7:30 pm Movie, "Bridge of Spies," SUT

Friday, Jan. 29

Reservations due for Sewanee Woman's Club Feb. 8 meeting

- 8:30 am Yoga with Carolyn, Comm Ctr
- 9:00 am CAC office open, until 11 am
- 10:00 am Game day, Senior Center
- 12:00 pm Spinal spa with Kim, Fowler
- 7:00 pm Bible study, Mtn of God Tabernacle, Monteagle
- 7:00 pm Concert, Anima Baroque, SAS McCrory Hall
- 7:30 pm Movie, "Bridge of Spies," SUT

LOCAL 12-STEP MEETINGS

Friday

- 7:00 pm AA, open, Christ Church, Tracy City

Saturday

- 7:30 pm NA, open, Decherd United Methodist
- 7:30 pm AA, open, Claiborne Parish House, Otey

Sunday

- 6:30 pm AA, open, Holy Comforter, Monteagle

Monday

- 5:00 pm Women's 12-step, Claiborne Parish House, Otey
- 7:00 pm AA, open, Christ Church, Tracy City

Tuesday

- 7:00 pm AA, open, First Baptist, Altamont
- 7:30 pm AA, open, Claiborne Parish House, Otey
- 7:30 pm CoDA, open, Holy Comforter, Monteagle

Wednesday

- 10:00 am AA, closed, Clifftops, (931) 924-3493
- 4:30 pm AA, "Tea-Totallers" women's group, Clifftops, (931) 924-3493
- 7:00 pm NA, open, Decherd United Methodist
- 7:30 pm AA, open, Holy Comforter, Monteagle

Thursday

- 12:00 pm AA, (931) 924-3493 for location
- 7:00 pm AA, open, St. James
- 7:30 pm Adult Children of Alcoholics, Dysfunctional Families, Claiborne Parish House, Otey

Celebrating 16 Years!
2000-2016

Join our email
rewards club to
receive special offers on your birthday,
anniversary and upon signing up!



High Point

224 East Main St
Monteagle
931-924-4600
Sun to Thu 5 to 9
Fri and Sat 5 to 10
www.highpoint
restaurant.net



402 West Main St. • Monteagle • 931-924-3355
www.paparons.net
Sunday-Thursday 11-9
Friday and Saturday 11-10

**Try our
Americano tacos!**



**TAKE US WITH YOU WHEN YOU TRAVEL
THIS WINTER!**

<www.sewaneeessenger.com>